

**NOTICE!!**

**These documents have been scanned!**

**Do not place un-scanned documents beneath this notice!**

**Do not remove this notice from this file!**

GPO Jacket No. 560-102  
Print Order 61540  
Rise Business Services, LLC  
Job=AZ15 5/10/2019



Box Number= AZ15031



Claim Begin-End: AMC429573-AMC429590

1 Initial Receipt



AZ15031-7

AMC429540-AMC429995

**AMC#****DATE  CLOSED****REMARKS**

AMC#	DATE  CLOSED	REMARKS
429573		
429574		
429575		
429576		
429577		
429578		
429579		
429580		
429581		
429582		
429583		
429584		
429585		
429586		
429587		
429588		
429589		
429590		

**NO WARRANTY IS MADE BY BLM  
FOR USE OF THE DATA FOR  
PURPOSES NOT INTENDED BY BLM**

**United States Department of the Interior**  
**Bureau of Land Management**  
 LANDS/RECREATION & PLANNING  
 ONE N CENTRAL AVE  
 PHOENIX, AZ 85004 -2203  
 Phone: 602-417-9200

Receipt

No: 3156821

<b>Transaction #:</b> 3249240	
<b>Date of Transaction:</b> 10/27/2014	
<b>CUSTOMER:</b>	
	AVEN ASSOCIATES LLC 7400 N ORACLE RD STE 131 TUCSON,AZ 85704-6339 US

LINE #	QTY	DESCRIPTION	REMARKS	UNIT PRICE	TOTAL
1	18.00	LOCATABLE MINERALS / MINING CLAIMS- NEW.UNADJUD, ONE OR MORE AUTH NOS / NEW MINING CLAIMS LOCATION FEE <b>CASES:</b> AMC429573/\$37.00, AMC429574/\$37.00, AMC429575/\$37.00, AMC429576/\$37.00, AMC429577/\$37.00, AMC429578/\$37.00, AMC429579/\$37.00, AMC429580/\$37.00, AMC429581/\$37.00, AMC429582/\$37.00, AMC429583/\$37.00, AMC429584/\$37.00, AMC429585/\$37.00, AMC429586/\$37.00, AMC429587/\$37.00, AMC429588/\$37.00, AMC429589/\$37.00, AMC429590/\$37.00		- n/a -	666.00
2	18.00	LOCATABLE MINERALS / MINING CLAIMS- NEW,UNADJUD, ONE OR MORE AUTH NOS / NEW MINING CLAIMS MAINTENANCE FEE <b>CASES:</b> AMC429573/\$155.00, AMC429574/\$155.00, AMC429575/\$155.00, AMC429576/\$155.00, AMC429577/\$155.00, AMC429578/\$155.00, AMC429579/\$155.00, AMC429580/\$155.00, AMC429581/\$155.00, AMC429582/\$155.00, AMC429583/\$155.00, AMC429584/\$155.00, AMC429585/\$155.00, AMC429586/\$155.00, AMC429587/\$155.00, AMC429588/\$155.00, AMC429589/\$155.00, AMC429590/\$155.00		- n/a -	2790.00
3	18.00	LOCATABLE MINERALS / MINING CLAIMS- NEW.UNADJUD, ONE OR MORE AUTH NOS / NEW MINING CLAIM PROCESSING FEE <b>CASES:</b> AMC429573/\$20.00, AMC429574/\$20.00, AMC429575/\$20.00, AMC429576/\$20.00, AMC429577/\$20.00, AMC429578/\$20.00,		- n/a -	360.00

	AMC429579/\$20.00, AMC429580/\$20.00, AMC429581/\$20.00, AMC429582/\$20.00, AMC429583/\$20.00, AMC429584/\$20.00, AMC429585/\$20.00, AMC429586/\$20.00, AMC429587/\$20.00, AMC429588/\$20.00, AMC429589/\$20.00, AMC429590/\$20.00			
<b>TOTAL:</b>				<b>\$3,816.00</b>

PAYMENT INFORMATION				
1	AMOUNT:	3816.00	POSTMARKED:	10/23/2014
	TYPE:	CHECK	RECEIVED:	10/24/2014
	CHECK NO:	2541		
	NAME:	AVEN ASSOCIATES LLC 7400 N ORACLE RD STE 131 TUCSON AZ 85704-6339 US		

REMARKS

This receipt was generated by the automated BLM Collections and Billing System and is a paper representation of a portion of the official electronic record contained therein.

**NOTICE!!**

**These documents have been scanned!**

**Do not place un-scanned documents beneath this notice!**

**Do not remove this notice from this file!**

GPO Jacket No. 560-102  
Print Order 61540  
Rise Business Services, LLC  
Job=AZ15 5/10/2019



Box Number= AZ15031



Claim Begin-End: AMC429573-AMC429590

2 Correspondence



AZ15031-7

AMC429540-AMC429995

**NO  
DOCUMENTS  
FOUND**

NO DOCUMENTS FOUND  
NO DOCUMENTS FOUND

**NOTICE!!**

**These documents have been scanned!**

**Do not place un-scanned documents beneath this notice!**

**Do not remove this notice from this file!**

GPO Jacket No. 560-102  
Print Order 61540  
Rise Business Services, LLC  
Job=AZ15 5/10/2019



Box Number= AZ15031



Claim Begin-End: AMC429573-AMC429590

3 Transfers



AZ15031-7

AMC429540-AMC429995





One South Church Avenue  
 Suite 1700  
 Tucson, Arizona 85701-1621  
 520.770.8700  
 Fax 520.623.2418  
 www.quarles.com

429573  
 Attorneys at Law in  
 Chicago  
 Indianapolis  
 Madison  
 Milwaukee  
 Naples  
 Phoenix  
 Scottsdale  
 Tampa  
 Tucson  
 Washington, D.C.

Writer's Direct Dial: 520-770-8717  
 E-Mail: marian.lalonde@quarles.com

March 3, 2016

**VIA OVERNIGHT DELIVERY**

Arizona State Office  
 Bureau of Land Management  
 Attention: Public Room  
 One North Central Avenue, Suite 800  
 Phoenix, AZ 85004-4427

RECEIVED  
 BLM AZ STATE OFFICE  
 2016 MAR -4 P 1:12  
 PHOENIX, ARIZONA

**RE: Notice of Transfer of Interest**

Ladies and Gentlemen:

Notice is hereby given pursuant to 43 C.F.R. § 3833.32(b) that, by the enclosed Quitclaim Deed dated March 3, 2016, AVEN ASSOCIATES LLC, an Arizona limited liability company, whose address is 9121 E. Tanque Verde Rd, Suite 105-300, Tucson AZ, 85749 company, has transferred its interest in the ARD-1 - ARD-18 unpatented lode mining claims (the "Claims") to BURDETT GOLD, LLC, an Arizona limited liability company, whose address is provided below.

1. The Claims transferred are in Pinal County, Arizona the names of which and the serial numbers assigned to each claim are set forth in Exhibit A of the enclosed Quitclaim Deed.
2. The name and mailing address of the entity to which the claims have been transferred is:  
 Burdett Gold, LLC  
 P.O. Box 175  
 Scio, NY 14880
3. A check in the amount of \$180.00 is enclosed to cover the fee for the transfer of eighteen (18) claims at \$10.00 per claim as indicated on the table at 43 C.F.R. § 3000.12.

ENTERED  
 MAR - 8 2016  
 BY: JR

Bureau of Land Management  
March 3, 2016  
Page 2

4. **Please return a date-stamped copy of this letter and along with the receipt for payment to this office.**

Thank you for your assistance and please feel free to contact me with any questions or concerns.

Sincerely,

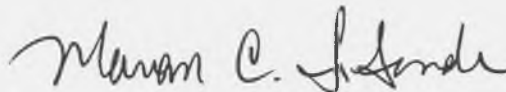

Marian C. LaLonde

MCL:lv

Enclosures

QB\154710.00002\38862981.1

RECEIVED  
BLM AZ STATE OFFICE  
2016 MAR -4 P 1:12  
PHOENIX, ARIZONA



DATE/TIME: 03/03/2016 1358

FEE: \$15.00

PAGES: 2

FEE NUMBER: 2016-012854



Marian C. LaLonde  
Quarles & Brady LLP  
One S. Church Ave., Ste. 1700  
Tucson, Arizona 85701

Exempt pursuant to A.R.S. Section §11-1134(A)(6)

**QUIT CLAIM DEED**

For good and valuable consideration, the receipt and sufficiency of which are hereby acknowledged, AVEN ASSOCIATES LLC, an Arizona limited liability company ("Grantor"), hereby quitclaims to BURDETT GOLD, LLC, an Arizona limited liability company ("Grantee"), all of Grantor's right, title or interest, if any, which Grantor may have in and to that certain real property located in Pinal County, Arizona (the "Property") described on Exhibit "A" attached hereto and incorporated herein by this reference.

Dated this 3<sup>rd</sup> day of March, 2016

Grantor:

By: *Kristopher Hefton*

STATE OF ARIZONA            )  
  ) ss.  
County of Pima                )

The foregoing instrument was acknowledged before me this 3<sup>rd</sup> day of March, 2016, by Kristopher Hefton, the COO of AVEN ASSOCIATES LLC, for and on behalf of the entity.

*[Signature]*  
Notary Public

My commission expires: 04/29/2017

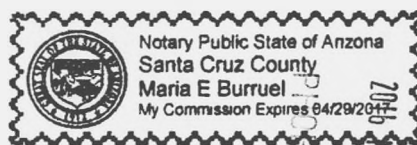

RECEIVED  
BLM AZ STATE OFFICE  
2016 MAR -4 P 1:14  
PICONIX, ARIZONA

**EXHIBIT A**

The following unpatented lode mining claims are situated in Pinal County, Arizona, in the section, township and range of the Public Land Survey System specified below and the location notices of which are of record in the official records of Pinal County, Arizona, and are filed with the Arizona State Office of the Bureau of Land Management as follows:

<b>Name</b>	<b>Loc. Date</b>	<b>Pinal Co. No.</b>	<b>BLM No.</b>	<b>Section</b>	<b>Twp.</b>	<b>Range</b>
ARD-1	25 Sept. 2014	2014-057399	AMC 429573	NW/4 Sec.15	T8S	R14E
ARD-2	25 Sept. 2014	2014-057400	AMC 429574	NW/4 Sec.15	T8S	R14E
ARD-3	25 Sept. 2014	2014-057401	AMC 429575	NW/4 Sec.15	T8S	R14E
ARD-4	25 Sept. 2014	2014-057402	AMC 429576	NW/4 Sec.15	T8S	R14E
ARD-5	25 Sept. 2014	2014-057403	AMC 429577	NW/4 Sec.15	T8S	R14E
ARD-6	25 Sept. 2014	2014-057404	AMC 429578	NW/4 Sec.15	T8S	R14E
ARD-7	25 Sept. 2014	2014-057405	AMC 429579	NW/4 Sec.15	T8S	R14E
ARD-8	25 Sept. 2014	2014-057406	AMC 429580	NW/4 Sec.15	T8S	R14E
ARD-9	25 Sept. 2014	2014-057407	AMC 429581	NW/4 and SW/4 Sec. 15	T8S	R14E
ARD-10	25 Sept. 2014	2014-057408	AMC 429582	NW/4 and SW/4 Sec. 15	T8S	R14E
ARD-11	25 Sept. 2014	2014-057409	AMC 429583	SW/4 Sec.15	T8S	R14E
ARD-12	25 Sept. 2014	2014-057410	AMC 429584	SW/4 Sec.15	T8S	R14E
ARD-13	25 Sept. 2014	2014-057411	AMC 429585	SW/4 Sec.15	T8S	R14E
ARD-14	25 Sept. 2014	2014-057412	AMC 429586	SW/4 Sec.15	T8S	R14E
ARD-15	25 Sept. 2014	2014-057413	AMC 429587	SW/4 Sec.15	T8S	R14E
ARD-16	25 Sept. 2014	2014-057414	AMC 429588	SW/4 Sec.15	T8S	R14E
ARD-17	25 Sept. 2014	2014-057415	AMC 429589	SW/4 Sec.15	T8S	R14E
ARD-18	25 Sept. 2014	2014-057416	AMC 429590	SW/4 Sec.15	T8S	R14E

JKW

RECEIVED  
BLM AZ STATE OFFICE  
2016 MAR -4 P 1:14  
PHOENIX, ARIZONA

**United States Department of the Interior  
Bureau of Land Management**

LANDS/RECREATION & PLANNING

ONE N CENTRAL AVE

PHOENIX, AZ 85004 -2203

Phone: 602-417-9200

Receipt

No:

3509851

<b>Transaction #:</b> 3611188	
<b>Date of Transaction:</b> 03/07/2016	
CUSTOMER:	
QUARLES & BRADY LLP 1 S CHURCH AVE SUITE 1700 TUCSON,AZ 85701-1612 US	

LINE #	QTY	DESCRIPTION	REMARKS	UNIT PRICE	TOTAL
1	1.00	LOCATABLE MINERALS / MINING CLAIMS- NOT NEW-UNADJUD,ONE AUTH NO. ONLY / MINING CLAIM MONEY RECEIVED <b>CASES: AMC429573/\$180.00</b>	TRF - 18	- n/a -	180.00
<b>TOTAL:</b>					<b>\$180.00</b>

PAYMENT INFORMATION					
1	AMOUNT:	180.00	POSTMARKED:	03/03/2016	
	TYPE:	CHECK	RECEIVED:	03/04/2016	
	CHECK NO:	13166			
	NAME:	QUARLES & BRADY LLP 1 S CHURCH AVE SUITE 1700 TUCSON AZ 85701-1612 US			

REMARKS	

This receipt was generated by the automated BLM Collections and Billing System and is a paper representation of a portion of the official electronic record contained therein.

**Extremely Urgent**

This envelope is for use with the following services:

**UPS Next Day Air®**  
**UPS Worldwide Express®**  
**UPS 2nd Day Air®**

**Apply shipping documents on this side.**

Visit **ups.com**® or call **1-800-PICK-UPS**® (1-800-742-5877) to schedule a pickup or find a drop off location near you.

**Domestic Shipments**

- To qualify for the letter rate, UPS Express Envelopes may only contain correspondence, urgent documents, and/or electronic media, and must weigh 8 oz. or less; UPS Express Envelopes containing items other than those listed or weigh

**International Shipments**

- The UPS Express Envelope Certain countries: ups.com/importextl

- To qualify for the Letter rate, UPS Express Envelopes may only contain correspondence, urgent documents, and/or electronic media, and must weigh 8 oz. or less; UPS Express Envelopes containing items other than those listed or weigh

**Note:** Express Envelope containing sensitive information or cash equivalent.

171604 REV. 12/09 FD

MARIAN C. LALONDE  
5207708717 7717  
QUARLES & BRADY LLP  
ONE SOUTH CHURCH  
TUCSON AZ 85701

0.0 LBS LTR 1 OF 1

**SHIP TO:**  
PUBLIC ROOM  
BUREAU OF LAND MANAGEMENT  
SUITE 800  
ONE NORTH CENTRAL AVENUE  
PHOENIX AZ 85004-4427

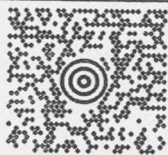

**AZ 850 9-10**



**UPS NEXT DAY AIR SAVER 1P**  
TRACKING #: 1Z 816 929 NW 9923 9223



BILLING: P/P  
ATTENTION UPS DRIVER: SHIPPER RELEASE

Reference#1: 154710.00002  
Reference#2: 38862981

US 18.0.23. WNTNVS0 72.0A 01/2016



Do not use this envelope for:

**UPS Ground**  
**UPS Standard**

<https://www.ups.com/uis/create?ActionOriginPair=default> PrintWindowPage&key=label...

3/3/2016

RECEIVED  
PHOENIX, ARIZONA

21 1 P h - MAR 9 10Z

International Shipping Notice — Carriage hereunder may be subject to the rules relating to liability and other terms and/or conditions established by the Convention for the Unification of Certain Rules Relating to International Carriage by Air (the "Warsaw Convention") and/or the Convention on the Contract for the International Carriage of Goods by Road (the "CMR Convention"). These commodities, technology or software were exported from the U.S. in accordance with the Export Administration Regulations. Diversion contrary to U.S. law prohibited.

010195101 1/10 IP United Parcel Service, Louisville, KY

**NOTICE!!**

**These documents have been scanned!**

**Do not place un-scanned documents beneath this notice!**

**Do not remove this notice from this file!**

GPO Jacket No. 560-102  
Print Order 61540  
Rise Business Services, LLC  
Job=AZ15 5/10/2019



Box Number= AZ15031



Claim Begin-End: AMC429573-AMC429590

4 Annual Filings



AZ15031-7

AMC429540-AMC429995

429573



One South Church Avenue  
Suite 1700  
Tucson, Arizona 85701-1621  
520.770.8700  
Fax 520.623.2418  
www.quarles.com

Attorneys at Law in  
Chicago  
Indianapolis  
Madison  
Milwaukee  
Minneapolis  
Naples  
Phoenix  
Scottsdale  
Tampa  
Tucson  
Washington, D.C.

Writer's Direct Dial: 520-770-8708  
Writer's Fax: 520-770-2290  
E-Mail: tiffany.morris@quarles.com

August 9, 2019

**VIA UPS OVERNIGHT**

Bureau of Land Management  
Arizona State Office  
Attention: Information Access Center  
One North Central Avenue, Suite 800  
Phoenix, Arizona 85004-4427

RECEIVED  
BLM AZ STATE OFFICE  
2019 AUG 12 P 3:19  
PHOENIX, ARIZONA

RE: *Payment of Claim Maintenance Fees for Burdett Gold LLC*

Ladies and Gentlemen:

Delivered herewith is a check in the amount of \$2,970.00 as payment of the claim maintenance fees pursuant to 30 U.S.C. § 28f(a), as adjusted by 30 U.S.C. § 28j(c) and implemented by notice in the 84 *Federal Register* 31219-22 (July 1, 2009) and as amended by the Consolidated Appropriations Act 2012, Pub. L. No. 112-74, 125 Stat 786 (2011). The owners are paying a maintenance fee of \$165.00 per lode claim for the assessment year beginning September 1, 2019. Also enclosed is a copy of the Certification of Payment of Maintenance Fee in Lieu of Affidavit of Annual Assessment Work to be recorded with the Pinal County Recorder's Office.

**Please return a date-stamped copy of this letter and the affidavit along with the receipt for payment to this office.**

Thank you for your assistance and please feel free to contact me with any questions or concerns.

Sincerely,

Tiffany N. Morris  
Legal Specialist

Enclosures  
QB\154710.00002\58428579.1

ENTERED  
AUG 15 2019  
BY:

4532527

NO. OF CLAIMS 18  
AMOUNT \$ 2970.00  
RECEIPT NO. 1030  
INIT.   
\*\* BLM-ASO\*\*



When Recorded Mail To:

Marian C. LaLonde, Esq.  
QUARLES & BRADY, LLP  
1 S. Church Avenue, Suite 1700  
Tucson, Arizona 85701

**CAPTION HEADING:** Certification of Payment of Maintenance Fees In Lieu  
of Affidavit of Annual Assessment Work

RECEIVED  
BLM AZ STATE OFFICE  
2019 AUG 12 P 3:19  
PHOENIX, ARIZONA

**CERTIFICATION OF PAYMENT OF MAINTENANCE FEES  
IN LIEU OF AFFIDAVIT OF ANNUAL ASSESSMENT WORK**

STATE OF ARIZONA            )  
  ) ss.  
County of Pima                )

Marian C. LaLonde, being first duly sworn, deposes and says that:

1. She is an agent for Burdett Gold LLC, an Arizona corporation, owner of the unpatented lode mining claims situated in Pinal County, Arizona (the "Claims"), the location notices of which are of record in said county, and in the records of the Arizona State Office of the Bureau of Land Management under the file numbers indicated in the attached Exhibit A.

2. Pursuant to the 30 U.S.C. § 28f(a), as adjusted by 30 U.S.C. § 28j(c) and implemented by notice in 84 *Federal Register* 31219-22 (July 1, 2019) and as amended by the Consolidated Appropriations Act 2012, Pub. L. No. 112-74, 125 Stat. 786 (2011), the owner has paid a maintenance fee of \$165.00 per claim for the assessment year beginning September 1, 2019. This Certificate is in lieu of an affidavit of performance of annual assessment work or notice of intent to hold.

3. The name and address of the owner of all claims for which this Certificate is prepared are Burdett Gold LLC, P.O. Box 175, Scio, NY 14880-0175. THIS IS NOT AN ADDRESS CHANGE.

4. The Claims are held and claimed by the owner for the valuable mineral contained therein.

DATED this 9<sup>th</sup> day of August, 2019.

  
\_\_\_\_\_  
Marian C. LaLonde

Sworn and subscribed to before me this 9<sup>th</sup> day of August, 2019, by Marian C. LaLonde, Agent for Burdett Gold LLC.

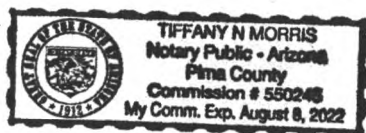

  
\_\_\_\_\_  
Notary Public

RECEIVED  
BLM AZ STATE OFFICE  
2019 AUG 12 P 3:19  
PHOENIX, ARIZONA

## EXHIBIT A

### Burdett Gold LLC Unpatented Mining Claims

The following unpatented lode mining claims situated in Pinal County, Arizona, and the location notices of which are of record in the office of the Recorder of Pinal County, Arizona and the Arizona State office of the Bureau of Land Management as follows:

BLM Serial Number	Claim Name	Location Date	County Records Number	Recording Date
AMC429573	ARD-1	09/25/2014	2014-057398	10/06/2014
AMC429574	ARD-2	09/25/2014	2014-057399	10/06/2014
AMC429575	ARD-3	09/25/2014	2014-057400	10/06/2014
AMC429576	ARD-4	09/25/2014	2014-057401	10/06/2014
AMC429577	ARD-5	09/25/2014	2014-057402	10/06/2014
AMC429578	ARD-6	09/25/2014	2014-057403	10/06/2014
AMC429579	ARD-7	09/25/2014	2014-057404	10/06/2014
AMC429580	ARD-8	09/25/2014	2014-057405	10/06/2014
AMC429581	ARD-9	09/25/2014	2014-057406	10/06/2014
AMC429582	ARD-10	09/25/2014	2014-057407	10/06/2014
AMC429583	ARD-11	09/25/2014	2014-057408	10/06/2014
AMC429584	ARD-12	09/25/2014	2014-057409	10/06/2014
AMC429585	ARD-13	09/25/2014	2014-057410	10/06/2014
AMC429586	ARD-14	09/25/2014	2014-057411	10/06/2014
AMC429587	ARD-15	09/25/2014	2014-057412	10/06/2014
AMC429588	ARD-16	09/25/2014	2014-057413	10/06/2014
AMC429589	ARD-17	09/25/2014	2014-057414	10/06/2014
AMC429590	ARD-18	09/25/2014	2014-057415	10/06/2014

RECEIVED  
BLM AZ STATE OFFICE  
2019 AUG 12 P 3:40  
PHOENIX, ARIZONA

**Extremely Urgent**

This envelope is for use with the following services:

UPS Next Day Air®  
UPS Worldwide Express®  
UPS 2nd Day Air®

Visit [ups.com](http://ups.com) or call **1-800-PICK-UPS**® (1-800-742-5877) to schedule a pickup or find a drop off location near you.

**Domestic Shipments**

- To qualify for the Letter rate, UPS Express Envelopes may only contain correspondence, urgent documents, and/or electronic media, and must weigh 8 oz. or less. UPS Express Envelopes containing items other than those listed or weighing more than 8 oz. will be billed by weight.

**International Shipments**

- The UPS Express Envelope value. Certain international items are not eligible for UPS Express Envelope.
- To qualify for UPS Express Envelope, the item must be a letter, document, or cash equivalent.

Note: Express Envelopes containing cash equivalents or cash equivalents are not eligible for UPS Express Envelope.

Apply shipping documents on this side.

Do not use this envelope for:

UPS Ground  
UPS Standard

TIFFANY N. MORRIS 0.0 LBS LTR 1 OF 1  
 5207708708  
 QUARLES & BRADY LLP  
 1 S CHURCH AVENUE  
 TUCSON AZ 85701

**SHIP TO:**  
 ARIZONA STATE OFFICE  
 BUREAU OF LAND MANAGEMENT  
 ATTN: INFORMATION ACCESS CENTER  
 SUITE 800  
 1 N. CENTRAL AVENUE  
 PHOENIX AZ 85004

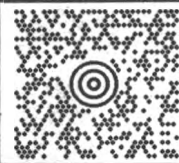

**AZ 850 9-10**



**UPS NEXT DAY AIR SAVER 1P**

TRACKING #: 1Z 816 929 13 9671 2052



BILLING: P/P

Reference #1: 154710.00002

XOL 19 08 11 NV45 15.0A 07/2019



RECEIVED  
 BLM AZ STATE OFFICE  
 2019 AUG 12 P 3:20  
 PHOENIX, ARIZONA

171604 8/18 BP

100% Recycled fiber  
80% Post-Consumer

8/9/2019



giving you up to more than 100 years  
United Parcel Service.

International Shipping Notice - Carrier: Receiver may be subject to the rules relating to liability and other terms and/or conditions established by the Convention for the Unification of Certain Rules Relating to International Carriage by Air (the "Warsaw Convention") and/or the Convention on the Contract for the International Carriage of Goods by Road (the "CMR Convention"). These commodities, technology or software were exported from the U.S. in accordance with the Export Administration Regulations. Diversion contrary to U.S. law prohibited.

010195101 1/15 TG United Parcel Service



BUREAU OF LAND MANAGEMENT  
1 N CENTRAL AVE  
STE 800  
PHOENIX AZ 85004-4414

P: BROWN S: ORANGE I:  
**1004-4000**

12816929139671 2045  
SAT03435 AUG 10 07:53:14 PM '99  
US E501 N1PP0 10 30, SAT0804 PL

1500

# Express Envelope

**United States Department of the Interior**  
**Bureau of Land Management**  
 DIV OF LANDS, MINRLS & ENERGY  
 ONE N CENTRAL AVE  
 PHOENIX, AZ 85004 -4427  
 Phone: 602-417-9200

Receipt

No: 4532527

<b>Transaction #:</b> 4653398	
<b>Date of Transaction:</b> 08/14/2019	
CUSTOMER:	
BURDETT GOLD LLC 5017 N CAMPANA DR TUCSON, AZ 85718-5621 US	

LINE #	QTY	DESCRIPTION	REMARKS	UNIT PRICE	TOTAL
1	1.00	LOCATABLE MINERALS / MINING CLAIMS- NOT NEW-UNADJUD, ONE AUTH NO. ONLY / MINING CLAIM MONEY RECEIVED <b>CASES: AMC429573/\$2970.00</b>	2020 MAINT (18)	- n/a -	2970.00
<b>TOTAL:</b>					<b>\$2,970.00</b>

PAYMENT INFORMATION			
1	AMOUNT:	2970.00	POSTMARKED: N/A
	TYPE:	CHECK	RECEIVED: 08/12/2019
	CHECK NO:	1030	
	NAME:	BURDETT GOLD LLC PO BOX 175 SCIO NY 14880 US	

REMARKS

This receipt was generated by the automated BLM Collections and Billing System and is a paper representation of a portion of the official electronic record contained therein.

429573



One South Church Avenue  
Suite 1700  
Tucson, Arizona 85701-1621  
520.770.8700  
Fax 520.623.2418  
www.quarles.com

Attorneys at Law in  
Chicago  
Indianapolis  
Madison  
Milwaukee  
Naples  
Phoenix  
Scottsdale  
Tampa  
Tucson  
Washington, D.C.

Writer's Direct Dial: 520-770-8708  
E-Mail: tiffany.morris@quarles.com

August 3, 2018

**VIA OVERNIGHT COURIER**

Bureau of Land Management  
Arizona State Office  
Attention: Information Access Center  
One North Central Avenue, Suite 800  
Phoenix, Arizona 85004-4427

RECEIVED  
BLM AZ STATE OFFICE  
2018 AUG - 6 P 12: 29  
PHOENIX, ARIZONA

RE: *Payment of Claim Maintenance Fees for Burdett Gold LLC*

Ladies and Gentlemen:

Delivered herewith is a check in the amount of \$2,790 as payment of the claim maintenance fees pursuant to 30 U.S.C. § 28f(a), as adjusted by 30 U.S.C. § 28j(c) and implemented by notice in the 74 *Federal Register* 30959-62 (June 29, 2009) and as amended by the Consolidated Appropriations Act 2012, Pub. L. No. 112-74, 125 Stat 786 (2011). The owners are paying a maintenance fee of \$155.00 per lode claim for the assessment year beginning September 1, 2018. Also enclosed is a copy of the Certification of Payment of Maintenance Fee in Lieu of Affidavit of Annual Assessment Work to be recorded with the Pinal County Recorder's Office.

**Please return a date-stamped copy of this letter and the affidavit along with the receipt for payment to this office.**

Thank you for your assistance and please feel free to contact me with any questions or concerns.

Sincerely,

Tiffany N. Morris  
Legal Specialist

Enclosures  
QB\154710.00002\52868507.1

ENTERED  
AUG 10 2018  
BY: SC

# 4330469

When Recorded Mail To:

Marian C. LaLonde, Esq.  
QUARLES & BRADY, LLP  
1 S. Church Avenue, Suite 1700  
Tucson, Arizona 85701

**CAPTION HEADING:** Certification of Payment of Maintenance Fee In Lieu  
of Affidavit of Annual Assessment Work

RECEIVED  
BLM AZ STATE OFFICE  
2018 AUG -6 P 12:20  
PHOENIX, ARIZONA



**CERTIFICATION OF PAYMENT OF MAINTENANCE FEE  
IN LIEU OF AFFIDAVIT OF ANNUAL ASSESSMENT WORK**

STATE OF ARIZONA        )  
  ) ss.  
County of Pima            )

Marian C. LaLonde, being first duly sworn, deposes and says that:

1. She is an agent for Burdett Gold LLC, an Arizona corporation, owner of the unpatented lode mining claims situated in Pinal County, Arizona (the "Claims"), the location notices of which are of record in said county, and in the records of the Arizona State Office of the Bureau of Land Management under the file numbers indicated in the attached Exhibit A.

2. Pursuant to the 30 U.S.C. § 28f(a), as adjusted by 30 U.S.C. § 28j(c) and implemented by notice in 74 *Federal Register* 30959-62 (June 29, 2009) and as amended by the Consolidated Appropriations Act 2012, Pub. L. No. 112-74, 125 Stat. 786 (2011), the owner has paid a maintenance fee of \$155.00 per claim for the assessment year beginning September 1, 2018. This Certificate is in lieu of an affidavit of performance of annual assessment work or notice of intent to hold and a copy of the receipt of payment to the Bureau of Land Management is attached hereto.

3. The name and address of the owner of all claims for which this Certificate is prepared are Burdett Gold LLC, P.O. Box 175, Scio, NY 14880-0175. THIS IS NOT AN ADDRESS CHANGE.

4. The Claims are held and claimed by the owner for the valuable mineral contained therein.

DATED this 3rd day of August, 2018.

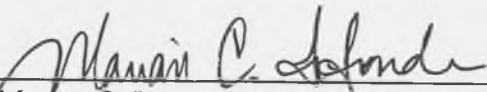
  
\_\_\_\_\_  
Marian C. LaLonde

Sworn and subscribed to before me this 3rd day of August, 2018, by Marian C. LaLonde, Agent for Burdett Gold LLC.

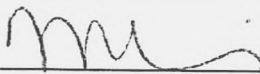
  
\_\_\_\_\_  
Notary Public

RECEIVED  
BLM AZ STATE OFFICE  
2018 AUG - 6 P 12:30  
PHOENIX, ARIZONA

**EXHIBIT A**

**Burdett Gold LLC Unpatented Mining Claims**

The following unpatented lode mining claims situated in Pinal County, Arizona, and the location notices of which are of record in the office of the Recorder of Pinal County, Arizona and the Arizona State office of the Bureau of Land Management as follows:

<b>BLM Serial Number</b>	<b>Claim Name</b>	<b>Location Date</b>	<b>County Records Number</b>	<b>Recording Date</b>
AMC429573	ARD-1	09/25/2014	2014-057398	10/06/2014
AMC429574	ARD-2	09/25/2014	2014-057399	10/06/2014
AMC429575	ARD-3	09/25/2014	2014-057400	10/06/2014
AMC429576	ARD-4	09/25/2014	2014-057401	10/06/2014
AMC429577	ARD-5	09/25/2014	2014-057402	10/06/2014
AMC429578	ARD-6	09/25/2014	2014-057403	10/06/2014
AMC429579	ARD-7	09/25/2014	2014-057404	10/06/2014
AMC429580	ARD-8	09/25/2014	2014-057405	10/06/2014
AMC429581	ARD-9	09/25/2014	2014-057406	10/06/2014
AMC429582	ARD-10	09/25/2014	2014-057407	10/06/2014
AMC429583	ARD-11	09/25/2014	2014-057408	10/06/2014
AMC429584	ARD-12	09/25/2014	2014-057409	10/06/2014
AMC429585	ARD-13	09/25/2014	2014-057410	10/06/2014
AMC429586	ARD-14	09/25/2014	2014-057411	10/06/2014
AMC429587	ARD-15	09/25/2014	2014-057412	10/06/2014
AMC429588	ARD-16	09/25/2014	2014-057413	10/06/2014
AMC429589	ARD-17	09/25/2014	2014-057414	10/06/2014
AMC429590	ARD-18	09/25/2014	2014-057415	10/06/2014

RECEIVED  
BLM AZ STATE OFFICE  
2018 AUG - 6 P 12:30  
PHOENIX, ARIZONA

**Extremely Urgent**

This envelope is for use with the following services:

- UPS Next Day Air®
- UPS Worldwide Express®
- UPS 2nd Day Air®

Visit [ups.com](http://ups.com)® or call 1-800-PICK-UPS® (1-800-742-5877) to schedule a pickup or find a drop off location near you.

**Domestic Shipments**

- To qualify for the Letter rate, UPS Express Envelopes may only contain correspondence, urgent documents, and/or electronic media, and must weigh 8 oz. or less. UPS Express Envelopes containing items other than those listed or weighing more than 8 oz. will be billed by weight.

**International Shipments**

- The UPS Express Envelope may be used only for low value. Certain countries consider electronic media as "goods" and require import/export to verify if your shipment is eligible for the Letter rate. Visit [ups.com/importexport](http://ups.com/importexport) for more information.
- To qualify for the Letter rate, the UPS Express Envelope must weigh 8 oz. or less.

**Note:** Express Envelopes are not recommended for containing sensitive personal information or breakable or cash equivalent.

Apply shipping documents on this side.

Do not use this envelope for:

- UPS Ground
- UPS Standard
- UPS 3 Day Select®
- UPS Worldwide Expedited®

171604 REV.12/09 FD

TIFFANY H. MORRIS  
5207708708  
QUARLES & BRADY LLC  
1 S CHURCH  
TUCSON AZ 85701

1.0 LBS LTR 1 OF 1

**SHIP TO:**  
ARIZONA STATE OFFICE  
BUREAU OF LAND MANAGEMENT  
ATTN: INFORMATION ACCESS CENTER  
SUITE 800  
1 N. CENTRAL AVENUE  
PHOENIX AZ 85004

 **AZ 850 9-10**  

**UPS NEXT DAY AIR** **1**  
TRACKING #: 1Z 816 929 01 9227 4289



BILLING: P/P

Reference No. 1: 154710.00002

XOL 18.07.27 NV45 03.0A 07/2018 

RECEIVED  
BLM AZ STATE OFFICE  
2018 AUG -6 P 12:29  
PHOENIX, ARIZONA

100% Recycled fiber 80% Post-Consumer

International Shipping Notice - Carriage hereunder may be subject to the rules relating to liability and other terms and/or conditions established by the Convention for the Unification of Certain Rules Relating to International Carriage by Air (the "Warsaw Convention") and/or the Convention on the Contract for the International Carriage of Goods by Road (the "CMR Convention"). These conventions, including any amendments thereto, are incorporated by reference into this contract. Disputes shall be resolved in accordance with the rules of the International Chamber of Commerce (ICC) in accordance with the Convention on the International Carriage of Goods by Road (the "CMR Convention").

010195101 1/15 TG United Parcel Service



COURTESY OF LEAD ARRANGEMENT  
1 N CENTRAL AVE  
STE 803  
PHOENIX AZ 85004-4414  
P: BROWN S: ORANGE I:  1830  
1ZE16029019227 4280  
UP TODAY'S RATE 08:09:57:08 2016  
US 1501 H1P00 18.03. SAT00405EL

# Express Envelope

**United States Department of the Interior**  
**Bureau of Land Management**  
 DIV OF LANDS, MINRLS & ENERGY  
 ONE N CENTRAL AVE  
 PHOENIX, AZ 85004 -4427  
 Phone: 602-417-9200

Receipt

No: 4230469

<b>Transaction #:</b> 4345749	
<b>Date of Transaction:</b> 08/08/2018	
<b>CUSTOMER:</b>	
QUARLES & BRADY LLP ONE SOUTH CHURCH AVE STE 1700 TUCSON, AZ 85701 US	

LINE #	QTY	DESCRIPTION	REMARKS	UNIT PRICE	TOTAL
1	1.00	LOCATABLE MINERALS / MINING CLAIMS- NOT NEW-UNADJUD, ONE AUTH NO. ONLY / MINING CLAIM MONEY RECEIVED <b>CASES: AMC429573/\$2790.00</b>	MAINT 2019/18	- n/a -	2790.00
<b>TOTAL:</b>					<b>\$2,790.00</b>

PAYMENT INFORMATION			
1	AMOUNT:	2790.00	POSTMARKED: N/A
	TYPE:	CHECK	RECEIVED: 08/08/2018
	CHECK NO:	94527247	
	NAME:	QUARLES & BRADY LLP ONE RENAISSANCE SQUARE TWO NORTH CENTRAL AVE PHOENIX AZ 85004 US	

REMARKS

This receipt was generated by the automated BLM Collections and Billing System and is a paper representation of a portion of the official electronic record contained therein.

**NOTICE!!**

**These documents have been scanned!**

**Do not place un-scanned documents beneath this notice!**

**Do not remove this notice from this file!**

GPO Jacket No. 560-102  
Print Order 61540  
Rise Business Services, LLC  
Job=AZ15 5/10/2019



Box Number= AZ15031



Claim Begin-End: AMC429573-AMC429590

5 Miscellaneous



AZ15031-7

AMC429540-AMC429995

## **AVEN Associates LLC**

---

L. Clark Arnold  
Alan F. Edwards  
Frank J. Nelson  
Steven D. Van Nort

7400 North Oracle Road  
Suite 131  
Tucson, Arizona 85704  
520 797-1393  
520 742-7280  
[clark.arnold@vaneminerals.com](mailto:clark.arnold@vaneminerals.com)

October 22, 2014

U.S. Bureau of Land Management  
One North Central Avenue  
Suite 800  
Phoenix, AZ 85004-4427

Gentlemen/Ladies

Enclosed please find our check in the amount of \$3,816.00 to cover the cost of registering 18 lode claims, the notices for which are also enclosed. Once registered, the notices should be returned to the address shown above.

Thank you for your assistance,

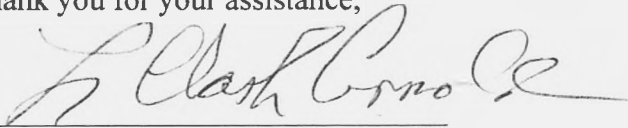

---

L. Clark Arnold  
520 909-2885 cell

RECEIVED  
BLM FIELD OFFICE  
2014 OCT 24 P 2:44  
PHOENIX, ARIZONA

**NOTICE!!**

**These documents have been scanned!**

**Do not place un-scanned documents beneath this notice!**

**Do not remove this notice from this file!**

GPO Jacket No. 560-102  
Print Order 61540  
Rise Business Services, LLC  
Job=AZ15 5/10/2019



Box Number= AZ15031



Claim Begin-End: AMC429573-AMC429590

6 Location Notices-Amendments and Supporting Documents



AZ15031-7

AMC429540-AMC429995



429573



One South Church Avenue  
Suite 1700  
Tucson, Arizona 85701-1621  
520.770.8700  
Fax 520.623.2418  
www.quarles.com

Attorneys at Law in  
Chicago  
Indianapolis  
Madison  
Milwaukee  
Naples  
Phoenix  
Scottsdale  
Tampa  
Tucson  
Washington, D.C.

Writer's Direct Dial: 520-770-8717  
E-Mail: marian.lalonde@quarles.com

August 4, 2017

**VIA OVERNIGHT COURIER**

Bureau of Land Management  
Arizona State Office  
Attention: Information Access Center  
One North Central Avenue, Suite 800  
Phoenix, AZ 85004-4427

2017 AUG 10 P 12: 06  
L. HOFFER, ANZONHA

RE: Payment of Claim Maintenance Fees - Burdett Gold LLC

Ladies and Gentlemen:

Delivered herewith is a check in the amount of \$2,790 as payment of the claim maintenance fees pursuant to 30 U.S.C. § 28f(a), as adjusted by 30 U.S.C. § 28j(c) and implemented by notice in the 74 *Federal Register* 30959-62 (June 29, 2009) and as amended by the Consolidated Appropriations Act 2012, Pub. L. No. 112-74, 125 Stat 786 (2011). The owners are paying a maintenance fee of \$155.00 per lode claim for the assessment year beginning September 1, 2017. Also enclosed are copies of the Certifications of Payment of Maintenance Fee in Lieu of Affidavit of Annual Assessment Work to be recorded with the Pinal County Recorder's Office.

**Please return a date-stamped copy of this letter and the affidavit along with the receipt for payment to this office.**

Thank you for your assistance and please feel free to contact me with any questions or concerns.

Sincerely,

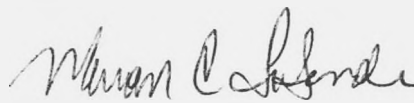
  
Marian C. LaLonde

Enclosure(s)

# 3932319

QB\47452004.1

INTERE  
AUG 14 2017  
BY: RANA

After recording, please return to:

Marian C. LaLonde  
Quarles & Brady LLP  
One S. Church Ave., Ste. 1700  
Tucson, AZ 85701

STATE OF ARIZONA )  
 ) ss:  
County of Pima )

2017 AUG 10 P 12:06  
RECEIVED  
COUNTY CLERK  
PIMA COUNTY

CERTIFICATION OF PAYMENT OF MAINTENANCE FEE  
IN LIEU OF AFFIDAVIT OF ANNUAL ASSESSMENT WORK

Marian C. LaLonde, being first duly sworn, deposes and says that:

1. She is an agent for Burdett Gold LLC, an Arizona corporation, owner of the unpatented lode mining claims and millsites situated in Pinal County, Arizona (the "Claims"), the location notices of which are of record in said county, and in the records of the Arizona State Office of the Bureau of Land Management under the file numbers indicated in the attached Exhibit A.

2. Pursuant to the 30 U.S.C. § 28f(a), as adjusted by 30 U.S.C. § 28j(c) and implemented by notice in 74 *Federal Register* 30959-62 (June 29, 2009) and as amended by the Consolidated Appropriations Act 2012, Pub. L. No. 112-74, 125 Stat. 786 (2011), the owner has paid a maintenance fee of \$155.00 per claim for the assessment year beginning September 1, 2017. This Certificate is in lieu of an affidavit of performance of annual assessment work or notice of intent to hold and a copy of the receipt of payment to the Bureau of Land Management is attached hereto.

3. The name and address of the owner of Claims for which this Certificate is prepared are Burdett Gold LLC, P.O. Box 175, Scio, NY 14880-0175. THIS IS NOT A CHANGE OF ADDRESS

4. The Claims are held and claimed by the owner for the valuable mineral contained therein and the millsites for uses related to the mining claims.

DATED this 4<sup>th</sup> day of August, 2017.

*Marian C. LaLonde*

Marian C. LaLonde

Sworn and subscribe to before me this 4<sup>th</sup> day of August, 2017, by Marian C. LaLonde, Agent for Burdett Gold LLC.

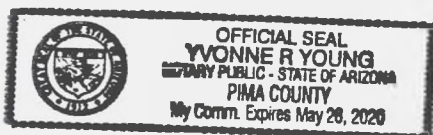

*Yvonne R. Young*  
Notary Public



## EXHIBIT A

The following unpatented lode mining claims situated in Pinal County, Arizona, and the location notices of which are of record in the office of the Recorder of Pinal County, Arizona and the Arizona State office of the Bureau of Land Management as follows:

Claim Name	AMC Number	Recording fee number	Location Date
ARD-1	AMC429573 7	2014-057398 7	9/25/2014
ARD-2	AMC429574	2014-057399	9/25/2014
ARD-3	AMC429575	2014-057400	9/25/2014
ARD-4	AMC429576	2014-057401	9/25/2014
ARD-5	AMC429577	2014-057402	9/25/2014
ARD-6	AMC429578	2014-057403	9/25/2014
ARD-7	AMC429579	2014-057404	9/25/2014
ARD-8	AMC429580	2014-057405	9/25/2014
ARD-9	AMC429581	2014-057406	9/25/2014
ARD-10	AMC429582	2014-057407	9/25/2014
ARD-11	AMC429583	2014-057408	9/25/2014
ARD-12	AMC429584	2014-057409	9/25/2014
ARD-13	AMC429585	2014-057410	9/25/2014
ARD-14	AMC429586	2014-057411	9/25/2014
ARD-15	AMC429587	2014-057412	9/25/2014
ARD-16	AMC429588	2014-057413	9/25/2014
ARD-17	AMC429589	2014-057414	9/25/2014
ARD-18	AMC429590 J	2014-057415 J	9/25/2014

2014 AUG 10 P 12:01  
 COUNTY OF PINAL  
 RECORDER OF DEEDS

UPS.com® or call 1-800-PICK-UPS® (1-800-742-5877)  
Schedule a pickup or find a drop off location near you.

Shipments

For the  
reference, u  
07, 0  
ed of

Express  
ertain cou  
/importax

For the  
ess Envelo  
/sensitive  
ivalent

YVONNE YOUNG  
QUARLES & BRADY LLP  
1 S. CHURCH AVE.  
TUCSON AZ 85701

1.0 LBS LTR 1 OF 1

**SHIP TO:**  
BUREAU OF LAND MANAGEMENT  
ARIZONA STATE OFFICE  
ONE NORTH CENTRAL AVENUE, SUITE 800  
PHOENIX AZ 85004-4427

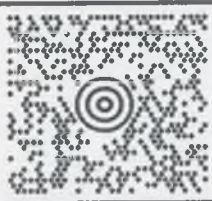

**AZ 850 9-10**



**UPS NEXT DAY AIR**

**1**

TRACKING #: 1Z 816 929 01 9116 7236



BILLING: P/P

Reference#1: 154710.00002  
Reference#2: Dean Phillips



WNTNV50 00.0A 07, 2017

This envelope is for use with the following services:

- UPS Next Day Air™
- UPS Worldwide Express®
- UPS 2nd Day Air®

Apply shipping labels on this side.

Do not use this envelope for:

<https://www.ups.com/uis/create?ActionOriginPair=default> Print Window Page&key=label... 8/9/2017

171604 REV. 12/09 F13

ARIZONA STATE OFFICE

2017 AUG 10 P 12:06

PHOENIX, ARIZONA

Arizona



ARIZONA STATE OFFICE  
 1 N CENTRAL AVE  
 STE 800  
 PHOENIX AZ 85004-4414

P: BROWN S: ORANGE I:  
**1004-1059**

12816929019116 **7236** 1030

SAT08485 Aug 10 07:13:15 2017  
 US 8501 HIPPS 17.03. SAT08485sL

---

ARIZONA STATE OFFICE  
 1 N CENTRAL AVE  
 STE 800  
 PHOENIX AZ 85004-4414

P: BROWN S: ORANGE I:  
**1004-1059**

12816929019116 **7236** 1030

SAT08485 Aug 10 06:40:51 2017  
 US 8501 HIPPS 17.03. SAT08485sL

**United States Department of the Interior**  
**Bureau of Land Management**  
 DIV OF LANDS, MINRLS & ENERGY  
 ONE N CENTRAL AVE  
 PHOENIX, AZ 85004 -4427  
 Phone: 602-417-9200

Receipt

No: 3932319

<b>Transaction #:</b> 4041893	
<b>Date of Transaction:</b> 08/11/2017	
<b>CUSTOMER:</b>	
QUARLES & BRADY LLP 1 S CHURCH AVE SUITE 1700 TUCSON, AZ 85701-1612 US	

LINE #	QTY	DESCRIPTION	REMARKS	UNIT PRICE	TOTAL
1	1.00	LOCATABLE MINERALS / MINING CLAIMS- NOT NEW-UNADJUD, ONE AUTH NO. ONLY / MINING CLAIM MONEY RECEIVED <b>CASES: AMC429573/\$2790.00</b>	MAINT 2018/18	- n/a -	2790.00
<b>TOTAL:</b>					<b>\$2,790.00</b>

PAYMENT INFORMATION			
1	AMOUNT:	2790.00	POSTMARKED: N/A
	TYPE:	CHECK	RECEIVED: 08/10/2017
	CHECK NO:	163	
	NAME:	BURDETT GOLD LLC 1 S CHURCH AVE SUITE 1700 TUCSON AZ 85701-1612 US	

REMARKS

This receipt was generated by the automated BLM Collections and Billing System and is a paper representation of a portion of the official electronic record contained therein.



429573

One South Church Avenue  
Suite 1700  
Tucson, Arizona 85701-1621  
520.770.8700  
Fax 520.623.2418  
www.quarles.com

Attorneys at Law in  
Chicago  
Indianapolis  
Madison  
Milwaukee  
Naples  
Phoenix  
Scottsdale  
Tampa  
Tucson  
Washington, D.C.

Writer's Direct Dial: 520-770-8717  
E-Mail: marian.lalonde@quarles.com

August 19, 2016

**VIA OVERNIGHT COURIER**

Bureau of Land Management  
Arizona State Office  
Attention: Information Access Center  
One North Central Avenue, Suite 800  
Phoenix, AZ 85004-4427

RECEIVED  
BLM AZ STATE OFFICE  
2016 AUG 23 A 10:13  
PHOENIX, ARIZONA

RE: Payment of Claim Maintenance Fees

Ladies and Gentlemen:

Delivered herewith is a check in the amount of \$2,790 as payment of the claim maintenance fees pursuant to 30 U.S.C. § 28f(a), as adjusted by 30 U.S.C. § 28j(c) and implemented by notice in the 74 *Federal Register* 30959-62 (June 29, 2009) and as amended by the Consolidated Appropriations Act 2012, Pub. L. No. 112-74, 125 Stat 786 (2011). The owners are paying a maintenance fee of \$155.00 per lode claim for the assessment year beginning September 1, 2016. Also enclosed are copies of the Certifications of Payment of Maintenance Fee in Lieu of Affidavit of Annual Assessment Work to be recorded with the Pinal County Recorder's Office.

**Please return a date-stamped copy of this letter and the affidavit along with the receipt for payment to this office.**

Thank you for your assistance and please feel free to contact me with any questions or concerns.

Sincerely,

Marian C. LaLonde

Enclosure(s)

**RECEIPT # 3639013**



After recording, please return to:

Marian C. LaLonde  
Quarles & Brady LLP  
One S. Church Ave., Ste. 1700  
Tucson, AZ 85701

RECEIVED  
BLM AZ STATE OFFICE  
2016 AUG 23 A 10:13  
PHOENIX, ARIZONA

STATE OF ARIZONA                    )  
  ) ss:  
County of Pima                        )

CERTIFICATION OF PAYMENT OF MAINTENANCE FEE  
IN LIEU OF AFFIDAVIT OF ANNUAL ASSESSMENT WORK

Marian C. LaLonde, being first duly sworn, deposes and says that:

1. She is an agent for Burdett Gold LLC, an Arizona corporation, owner of the unpatented lode mining claims and millsites situated in Pinal County, Arizona (the "Claims"), the location notices of which are of record in said county, and in the records of the Arizona State Office of the Bureau of Land Management under the file numbers indicated in the attached Exhibit A.

2. Pursuant to the 30 U.S.C. § 28f(a), as adjusted by 30 U.S.C. § 28j(c) and implemented by notice in 74 *Federal Register* 30959-62 (June 29, 2009) and as amended by the Consolidated Appropriations Act 2012, Pub. L. No. 112-74, 125 Stat. 786 (2011), the owner has paid a maintenance fee of \$155.00 per claim for the assessment year beginning September 1, 2016. This Certificate is in lieu of an affidavit of performance of annual assessment work or notice of intent to hold and a copy of the receipt of payment to the Bureau of Land Management is attached hereto.

3. The name and address of the owner of Claims for which this Certificate is prepared are Burdett Gold LLC, P.O. Box 175, Scio, NY 14880-0175. THIS IS NOT A CHANGE OF ADDRESS

4. The Claims are held and claimed by the owner for the valuable mineral contained therein and the millsites for uses related to the mining claims.

DATED this 19 day of August, 2016.

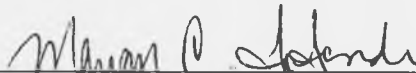
  
\_\_\_\_\_  
Marian C. LaLonde

Sworn and subscribe to before me this 19 day of August, 2016, by Marian C. LaLonde, Agent for Burdett Gold LLC.

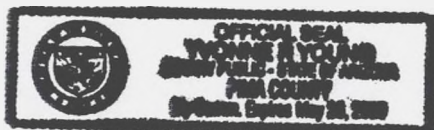

  
\_\_\_\_\_  
Notary Public

EXHIBIT A

PHOENIX, ARIZONA

The following unpatented lode mining claims situated in Pinal County, Arizona, and the location notices of which are of record in the office of the Recorder of Pinal County, Arizona and the Arizona State office of the Bureau of Land Management as follows:

Claim Name	AMC Number	Recording fee number	Location Date
ARD-1	AMC429573	2014-057398	9/25/2014
ARD-2	AMC429574	2014-057399	9/25/2014
ARD-3	AMC429575	2014-057400	9/25/2014
ARD-4	AMC429576	2014-057401	9/25/2014
ARD-5	AMC429577	2014-057402	9/25/2014
ARD-6	AMC429578	2014-057403	9/25/2014
ARD-7	AMC429579	2014-057404	9/25/2014
ARD-8	AMC429580	2014-057405	9/25/2014
ARD-9	AMC429581	2014-057406	9/25/2014
ARD-10	AMC429582	2014-057407	9/25/2014
ARD-11	AMC429583	2014-057408	9/25/2014
ARD-12	AMC429584	2014-057409	9/25/2014
ARD-13	AMC429585	2014-057410	9/25/2014
ARD-14	AMC429586	2014-057411	9/25/2014
ARD-15	AMC429587	2014-057412	9/25/2014
ARD-16	AMC429588	2014-057413	9/25/2014
ARD-17	AMC429589	2014-057414	9/25/2014
ARD-18	AMC429590	2014-057415	9/25/2014

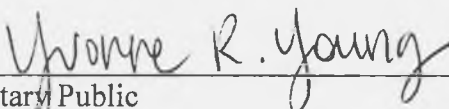
After recording, please return to:

Marian C. LaLonde  
Quarles & Brady LLP  
One S. Church Ave., Ste. 1700  
Tucson, AZ 85701

RECEIVED  
BLM AZ STATE OFFICE

2016 AUG 23 A 10:13

PHOENIX, ARIZONA

STATE OF ARIZONA )  
 ) ss:  
County of Pima )

CERTIFICATION OF PAYMENT OF MAINTENANCE FEE  
IN LIEU OF AFFIDAVIT OF ANNUAL ASSESSMENT WORK

Marian C. LaLonde, being first duly sworn, deposes and says that:

1. She is an agent for Burdett Gold LLC, an Arizona corporation, owner of the unpatented lode mining claims and millsites situated in Pinal County, Arizona (the "Claims"), the location notices of which are of record in said county, and in the records of the Arizona State Office of the Bureau of Land Management under the file numbers indicated in the attached Exhibit A.

2. Pursuant to the 30 U.S.C. § 28f(a), as adjusted by 30 U.S.C. § 28j(c) and implemented by notice in 74 *Federal Register* 30959-62 (June 29, 2009) and as amended by the Consolidated Appropriations Act 2012, Pub. L. No. 112-74, 125 Stat. 786 (2011), the owner has paid a maintenance fee of \$155.00 per claim for the assessment year beginning September 1, 2016. This Certificate is in lieu of an affidavit of performance of annual assessment work or notice of intent to hold and a copy of the receipt of payment to the Bureau of Land Management is attached hereto.

3. The name and address of the owner of Claims for which this Certificate is prepared are Burdett Gold LLC, P.O. Box 175, Scio, NY 14880-0175. THIS IS NOT A CHANGE OF ADDRESS

4. The Claims are held and claimed by the owner for the valuable mineral contained therein and the millsites for uses related to the mining claims.

DATED this 19 day of August, 2016.

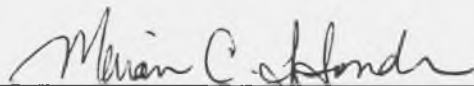
  
Marian C. LaLonde

Sworn and subscribe to before me this 19 day of August, 2016, by Marian C. LaLonde, Agent for Burdett Gold LLC.

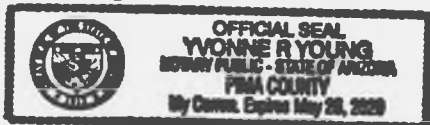

  
Notary Public

EXHIBIT A

2016 AUG 23 A 10:13

The following unpatented lode mining claims situated in Pinal County, Arizona, and the location notices of which are of record in the office of the Recorder of Pinal County, Arizona and the Arizona State office of the Bureau of Land Management as follows:

Claim Name	AMC Number	Recording fee number	Location Date
ARD-1	AMC429573	2014-057398	9/25/2014
ARD-2	AMC429574	2014-057399	9/25/2014
ARD-3	AMC429575	2014-057400	9/25/2014
ARD-4	AMC429576	2014-057401	9/25/2014
ARD-5	AMC429577	2014-057402	9/25/2014
ARD-6	AMC429578	2014-057403	9/25/2014
ARD-7	AMC429579	2014-057404	9/25/2014
ARD-8	AMC429580	2014-057405	9/25/2014
ARD-9	AMC429581	2014-057406	9/25/2014
ARD-10	AMC429582	2014-057407	9/25/2014
ARD-11	AMC429583	2014-057408	9/25/2014
ARD-12	AMC429584	2014-057409	9/25/2014
ARD-13	AMC429585	2014-057410	9/25/2014
ARD-14	AMC429586	2014-057411	9/25/2014
ARD-15	AMC429587	2014-057412	9/25/2014
ARD-16	AMC429588	2014-057413	9/25/2014
ARD-17	AMC429589	2014-057414	9/25/2014
ARD-18	AMC429590	2014-057415	9/25/2014

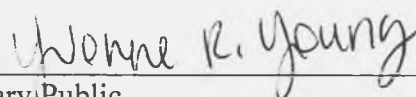
Visit [ups.com](http://ups.com) or call 1-800-PICK-UPS® (1-800-742-5877)  
to schedule a pickup or find a drop off location near you.

**Domestic Ship**

- To qualify for the... mass Envelopes may only contain correspondence, internal documents, and/or electronic media, and must weigh 8... those like

**Internatio**

- The UPS value: C... ups.com
- To qual UPS Expi

**Note:** Exp containing or cash ec

MARIAN LALONDE 0.0 LBS LTR 1 OF 1  
 520-770-8734  
 QUARLES & BRADY LLP  
 1 S. CHURCH AVE.  
 TUCSON AZ 85701

**SHIP TO:**  
 INFORMATION ACCESS CENTER  
 BUREAU OF LAND MANAGEMENT  
 SUITE 800  
 ONE NORTH CENTRAL AVENUE  
 PHOENIX AZ 85004-4427



**UPS NEXT DAY AIR** 1  
 TRACKING #: 1Z 816 929 01 9655 9947



BILLING: P/P  
 Reference#1: 0571.2311.8.0  
 Reference#2: Interoffice Distribution  
 UPS 18.5.10 WNTNVS0 78.0A 07/2016

<https://www.ups.com/uis/create?ActionOriginPair=default> PrintWindowPage&key=lab... 8/19/2016

Serving you for more than 100 years  
United Parcel Service

010195101 1/15 TG United Parcel Service



Apply shipping documents on this side.

Do not use the envelope for:

UPS Ground

Expedited

# Express Envelope



BUREAU OF LAND MANAGEMENT  
1 N CENTRAL AVE  
STE 800  
PHOENIX AZ 85004-4414  
P: PURPLE S: ORANGE I: 44D  
0903-1084  
12816929019655 9947  
1030  
DPNCHH 2P4505  
2ZPH0182  
AUG 22 04:12:38 2016  
US 8501 HIP 18.3.5  
2P4505

**United States Department of the Interior**  
**Bureau of Land Management**  
 DIV OF LANDS, MINRLS & ENERGY  
 ONE N CENTRAL AVE  
 PHOENIX, AZ 85004 -4427  
 Phone: 602-417-9200

Receipt

No: 3639013

<b>Transaction #:</b> 3742927	
<b>Date of Transaction:</b> 08/24/2016	
CUSTOMER:	
QUARLES & BRADY LLP 1 S CHURCH AVE SUITE 1700 TUCSON, AZ 85701-1612 US	

LINE #	QTY	DESCRIPTION	REMARKS	UNIT PRICE	TOTAL
1	1.00	LOCATABLE MINERALS / MINING CLAIMS- NOT NEW-UNADJUD, ONE AUTH NO. ONLY / MINING CLAIM MONEY RECEIVED CASES: AMC429573/\$2790.00	MAINT FEE 2017	- n/a -	2790.00
<b>TOTAL:</b>					<b>\$2,790.00</b>

PAYMENT INFORMATION					
1	AMOUNT:	2790.00	POSTMARKED:	08/19/2016	
	TYPE:	CHECK	RECEIVED:	08/23/2016	
	CHECK NO:	20016			
	NAME:	QUARLES & BRADY LLP ONE RENAISSANCE SQUARE TWO NORTH CENTRAL AVE PHOENIX AZ 85004 US			

REMARKS

This receipt was generated by the automated BLM Collections and Billing System and is a paper representation of a portion of the official electronic record contained therein.

**ENTERED**  
 AUG 25 2016  
 BY: *[Signature]*

429573

## AVEN Associates LLC

L. Clark Arnold  
Alan F. Edwards  
Frank J. Nelson  
Steven D. Van Nort

7400 North Oracle Road  
Suite 131  
Tucson, Arizona 85704  
520 797-1393  
520 742-7280  
[clark.arnold@vaneminerals.com](mailto:clark.arnold@vaneminerals.com)

August 26, 2015

U.S. Bureau of Land Management  
Arizona State Office  
One North Central Avenue, Suite 800  
Phoenix, AZ 85004-4427

Ladies/Gentlemen,

Enclosed please find our check in the amount of \$2,790.00 to cover annual assessment fees for assessment year 2016 shown in the attached Exhibit A.

The receipt should be mailed to the address shown above.

Yours truly,

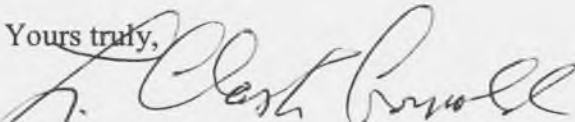

L. Clark Arnold  
AVEN Associates LLC

RECEIVED  
DLM / RECEIVED  
2015 SEP - 8 P 1: 36  
PHOENIX, ARIZONA

RECEIPT # 3389372

ENTERED  
SEP 10 2015  
BY: RAN



Ardmore Claims  
Exhibit A

Claim Name	Pinal Co. No.	BLM No.	Section	Twp.	Range
ARD-1	2014-057399	AMC 429573	NW/4 Sec.15	T8S	R14E
ARD-2	2014-057400	AMC 429574	NW/4 Sec.15	T8S	R14E
ARD-3	2014-057401	AMC 429575	NW/4 Sec.15	T8S	R14E
ARD-4	2014-057402	AMC 429576	NW/4 Sec.15	T8S	R14E
ARD-5	2014-057403	AMC 429577	NW/4 Sec.15	T8S	R14E
ARD-6	2014-057404	AMC 429578	NW/4 Sec.15	T8S	R14E
ARD-7	2014-057405	AMC 429579	NW/4 Sec.15	T8S	R14E
ARD-8	2014-057406	AMC 429580	NW/4 Sec.15	T8S	R14E
ARD-9	2014-057407	AMC 429581	NW/4 and SW/4 Sec. 15	T8S	R14E
ARD-10	2014-057408	AMC 429582	NW/4 and SW/4 Sec. 15	T8S	R14E
ARD-11	2014-057409	AMC 429583	SW/4 Sec.15	T8S	R14E
ARD-12	2014-057410	AMC 429584	SW/4 Sec.15	T8S	R14E
ARD-13	2014-057411	AMC 429585	SW/4 Sec.15	T8S	R14E
ARD-14	2014-057412	AMC 429586	SW/4 Sec.15	T8S	R14E
ARD-15	2014-057413	AMC 429587	SW/4 Sec.15	T8S	R14E
ARD-16	2014-057414	AMC 429588	SW/4 Sec.15	T8S	R14E
ARD-17	2014-057415	AMC 429589	SW/4 Sec.15	T8S	R14E
ARD-18	2014-057416	AMC 429590	SW/4 Sec.15	T8S	R14E

PHOENIX, ARIZONA

2015 SEP - 8 P 1:31

RECEIVED  
BLM OFFICE

AVEN Associates LLC  
7400 N. Oracle Rd. #131  
Tucson, AZ 85704



US Bureau of Land Management +  
Arizona State office  
One North Central Ave. #800  
Phoenix, AZ 85004

RECEIVED  
BLM ARIZONA OFFICE  
2015 SEP -8 P 1: 36  
PHOENIX, ARIZONA

RETURN RECEIPT  
REQUESTED

FIRST CLASS

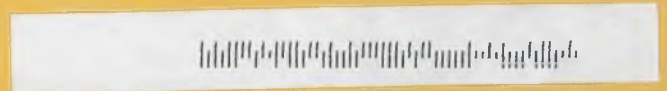

**United States Department of the Interior**  
**Bureau of Land Management**  
 LANDS/RECREATION & PLANNING  
 ONE N CENTRAL AVE  
 PHOENIX, AZ 85004 -2203  
 Phone: 602-417-9200

Receipt

No: 3389372

<b>Transaction #:</b> 3487763	
<b>Date of Transaction:</b> 09/09/2015	
CUSTOMER:	
AVEN ASSOCIATES LLC 7400 N ORACLE RD STE 131 TUCSON, AZ 85704-6339 US	

LINE #	QTY	DESCRIPTION	REMARKS	UNIT PRICE	TOTAL
1	1.00	LOCATABLE MINERALS / MINING CLAIMS-NOT NEW-UNADJUD, ONE AUTH NO. ONLY / MINING CLAIM MONEY RECEIVED CASES: AMC429573/\$2790.00	MAINT FEE PYMNT - 18 2016	- n/a -	2790.00
<b>TOTAL:</b>					<b>\$2,790.00</b>

PAYMENT INFORMATION			
1	AMOUNT:	2790.00	POSTMARKED: 08/27/2015
	TYPE:	CHECK	RECEIVED: 09/08/2015
	CHECK NO:	2643	
	NAME:	AVEN ASSOCIATES LLC 7400 N ORACLE RD STE 131 TUCSON AZ 85704-6339 US	

REMARKS

This receipt was generated by the automated BLM Collections and Billing System and is a paper representation of a portion of the official electronic record contained therein.

ENTERED  
 SEP 18 2015  
 RAN

# MINING CLAIM STATUS REPORT

Data Entered: 11/03/14 Rm

MTP Checked By: 11/03/14 Rm

GEO Checked By: 11/03/14 Rm

LEAD SERIAL NUMBER: AMC 429573 thru AMC 439590

### NUMBER OF CLAIMS & TYPE:

18 LODE  
 \_\_\_\_\_ PLACER  
 \_\_\_\_\_ ASSOCIATION PLACER  
 \_\_\_\_\_ MILL SITE  
 \_\_\_\_\_ TUNNEL SITE

### CHARGES:

Location Fee @ \$37 = \$ 666  
 Processing Fee @ \$20 = \$ 360  
 Maintenance Fee @ \$155 = \$ 2,790  
 Add'l Maint Fee for Assoc Placer = \$ \_\_\_\_\_  
**SUBTOTAL** \$ \_\_\_\_\_  
 Other Fees \$ \_\_\_\_\_  
 Other Fees \$ \_\_\_\_\_  
**TOTAL** \$ 3,816

TOTAL ACREAGE: \_\_\_\_\_ Per Claim  
(Placer Only)

NUMBER OF LOCATORS: \_\_\_\_\_

DOCUMENTS RECEIVED VIA: Over-the-Counter [ ] Mail [  ] TIMELY FILED: Yes [  ] No [ ]

LEGAL DESCRIPTION: T 85 R 14E SEC 15  
 T \_\_\_\_\_ R \_\_\_\_\_ SEC \_\_\_\_\_  
 T \_\_\_\_\_ R \_\_\_\_\_ SEC \_\_\_\_\_  
 T \_\_\_\_\_ R \_\_\_\_\_ SEC \_\_\_\_\_  
 T \_\_\_\_\_ R \_\_\_\_\_ SEC \_\_\_\_\_

BLM [ ] FOREST SERVICE [ ] \_\_\_\_\_ SUBJ TO PL 359: Yes [ ] No [ ]  
WILDERNESS AREA [ ] \_\_\_\_\_

SPLIT ESTATE: N/A [ ] SX [ ] PX [ ] OTHER [ ] \_\_\_\_\_  
SRHA [ ] Was proper Notice filed if located on SHRA Land? Yes [ ] No [ ]

RECONVEYED MINERALS ON BLM LAND REQUIRE OPENING ORDER FROM 1944 TO 1993:  
Open to Entry On \_\_\_\_\_ N/A [ ]

COMMENTS/STATUS: VOID [ ] PARTIALLY VOID [ ] PVT MINERALS [ ] WITHDRAWN LANDS [ ]  
OTHER [ ] \_\_\_\_\_

ARDZ - describes it in 14W instead of 14E - YMC  
PART OF CLAIMS OVERLAP ONTO STATE LAND. NO RIGHTS GIVEN ON THESE PARTS. RM

[ ] Claimant acknowledges that portions of the following claim(s) site(s) may be void or voidable.

Printed Name of Claimant \_\_\_\_\_ Signature of Claimant \_\_\_\_\_

\*\*\*\*\*FINAL ADJUDICATION\*\*\*\*\*

DATE 5-4-2019 INITIALS Rm

ARHC429573

ET2PS#CMA

**LOCATION NOTICE FOR LODE MINING CLAIM**

*CORRECTED*

NOTICE IS HEREBY GIVEN that the ARD-1  
 \_\_\_\_\_ lode mining claim has been located by AVEN  
 Associates LLC whose current mailing address is 7400 N. Oracle Road #131,  
 Tucson, Arizona 85704. The general course of this claim is  
E-W and it is situated in Pinal County, Arizona.

RECEIVED  
 BLM ARIZONA OFFICE  
 Date 2014 OCT 24 P 2:49  
 Stamp PHOENIX, ARIZONA

This claim is 1500 feet in length and 600 feet in width. This claim runs from the location monument on which this  
 location notice is posted approximately 1450 feet in a W direction to the W end center and  
50 feet in a E direction to the E end center. This claim is marked by four monuments,  
 one at each corner. The location monument on which this notice is posted is situated within Section 15,  
 Township 8 S, Range 14 E, Gila and Salt River Prime Meridian, Arizona and this claim encompasses portions of the  
 following quarter section(s), section(s), Township(s) and Range(s)  
NW 1/4 Sec. 15, T. 8 S., R. 14 E.

The locality of this claim with reference to some natural object or permanent monument and additional information (if any)  
 concerning its locality are as follows: This location is approximately 1400 feet  
east and 300 feet south of the NW Cor. Sec. 15,  
T. 8 S., R. 14 E.

DATED AND POSTED on the ground this 25<sup>TH</sup> day of Sept, 2014

LOCATOR (s) L. Josh Arnold

ANCh29513

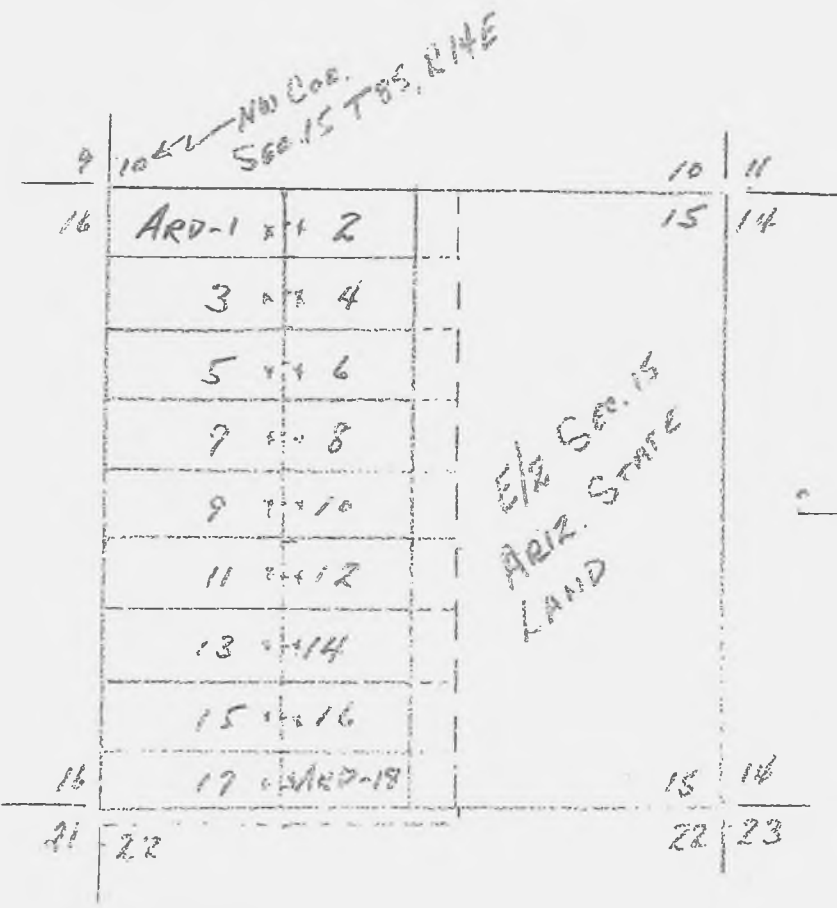

RECEIVED  
 BLM ARIZONA OFFICE  
 2015 MAY -4 P 3:25  
 PHOENIX, ARIZONA

**LOCATION NOTICE FOR LODE MINING CLAIM**

NOTICE IS HEREBY GIVEN that the ARD-1  
 \_\_\_\_\_ lode mining claim has been located by AVEN  
 Associates LLC whose current mailing address is 7400 N. Oracle Road #131,  
 Tucson, Arizona 85704. The general course of this claim is  
E-W and it is situated in Pinal County, Arizona.

RECEIVED  
 BLM AZ STATE OFFICE  
 BLM  
 Date 2014 OCT 24 P 2:45  
 Stamp PHOENIX, ARIZONA

This claim is 1500 feet in length and 600 feet in width. This claim runs from the location monument on which this  
 location notice is posted approximately 1450 feet in a W direction to the W end center and  
50 feet in a E direction to the E end center. This claim is marked by four monuments,  
 one at each corner. The location monument on which this notice is posted is situated within Section 15,  
 Township 8 S, Range 14 E, Gila and Salt River Prime Meridian, Arizona and this claim encompasses portions of the  
 following quarter section(s), section(s), Township(s) and Range(s)

NW 1/4 Sec. 15, T. 8 S., R. 14 E.

The locality of this claim with reference to some natural object or permanent monument and additional information (if any)  
 concerning its locality are as follows: This Location is approximately 1400 feet  
east and 300 feet south of the NW Cor. Sec. 15,  
T. 8 S., R. 14 E.

DATED AND POSTED on the ground this 25<sup>th</sup> day of Sept, 2014

LOCATOR (s) L. Oosh Arnold

AMC429513

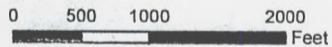
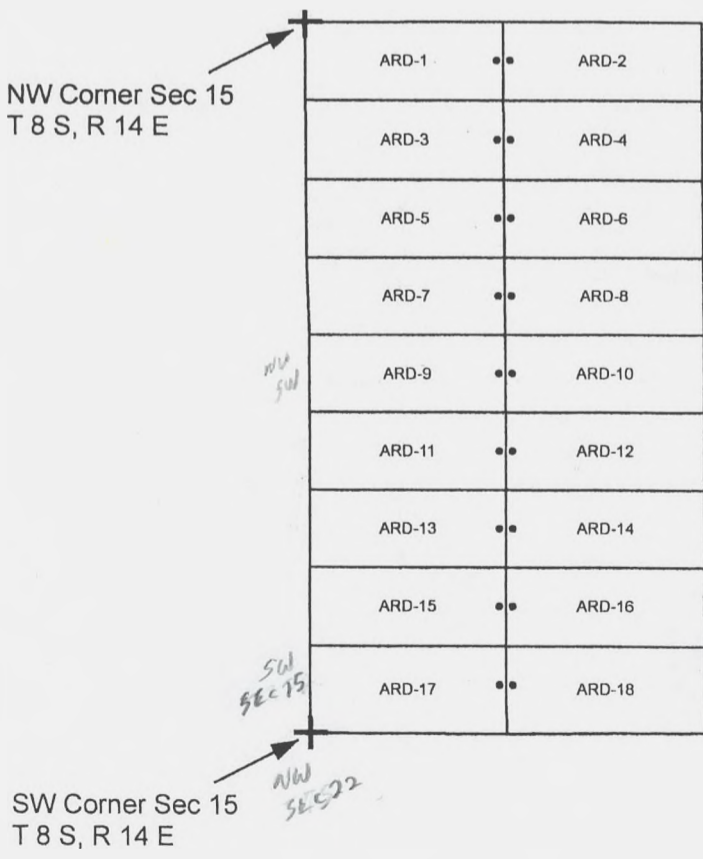

CORRECTED

LOCATION NOTICE FOR LOSE MINING CLAIM

NOTICE IS HEREBY GIVEN that the ARD-2 lode mining claim has been located by AVEN Associates LLC whose current mailing address is 7400 N. Oracle Road #131, Tucson, Arizona 85704. The general course of this claim is

RECEIVED  
BLM BUREAU OF LAND MANAGEMENT OFFICE  
Date 2014 OCT 24 P 2:45  
Stamp PHOENIX, ARIZONA

E-W and it is situated in Pinal County, Arizona.

This claim is 1500 feet in length and 600 feet in width. This claim runs from the location monument on which this location notice is posted approximately 1450 feet in a E direction to the E end center and 50 feet in a W direction to the W end center. This claim is marked by four monuments, one at each corner. The location monument on which this notice is posted is situated within Section 15 Township 8 S, Range 14 E, Gila and Salt River Prime Meridian, Arizona and this claim encompasses portions of the following quarter section(s), section(s), Township(s) and Range(s)

NW 1/4 Sec. 15, T. 8 S., R. 14 E.

The locality of this claim with reference to some natural object or permanent monument and additional information (if any) concerning its locality are as follows: This location is approximately 1500 feet east and 300 feet south of the NW cor. sec 15, T. 8 S., R. 14 E.

DATED AND POSTED on the ground this 25th day of SEPT, 20 14

LOCATOR (s) L. C. Oost Pennell

AMC429574

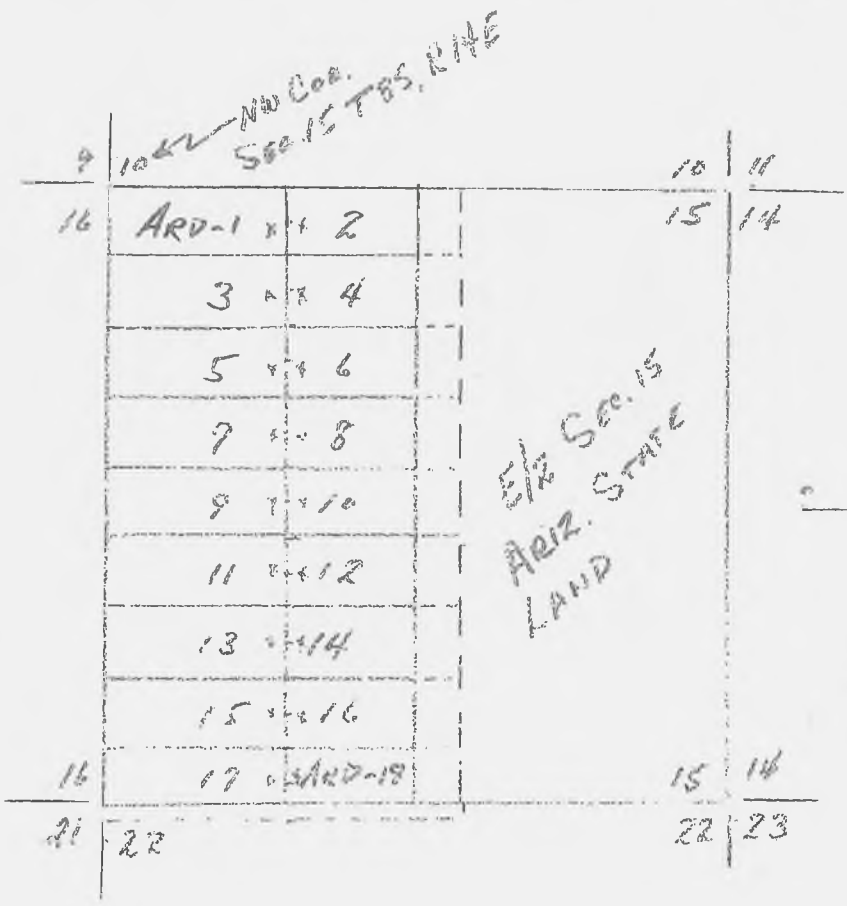

PHOENIX, ARIZONA  
2015 MAY - 4 P 3:25  
BLM BUREAU OF LAND MANAGEMENT OFFICE



**LOCATION NOTICE FOR LODE MINING CLAIM**

NOTICE IS HEREBY GIVEN that the ARD-2  
 \_\_\_\_\_ lode mining claim has been located by AVEN  
 Associates LLC whose current mailing address is 7400 N. Oracle Road #131,  
 Tucson, Arizona 85704. The general course of this claim is  
E-W and it is situated in Pinal County, Arizona.

RECEIVED  
 BLM AZ STATE OFFICE

BLM  
 Date 2014 OCT 24 P 2:45  
 Stamp PHOENIX, ARIZONA

This claim is 1500 feet in length and 600 feet in width. This claim runs from the location monument on which this location notice is posted approximately 1450 feet in a E direction to the E end center and 50 feet in a W direction to the W end center. This claim is marked by four monuments, one at each corner. The location monument on which this notice is posted is situated within Section 15, Township 8 S, Range 14 E, Gila and Salt River Prime Meridian, Arizona and this claim encompasses portions of the following quarter section(s), section(s), Township(s) and Range(s)  
NW 1/4 Sec. 15, T. 8 S., R. 14 E.

The locality of this claim with reference to some natural object or permanent monument and additional information (if any) concerning its locality are as follows: This location is approximately 1500 feet east and 300 feet south of the NW cor. sec. 15, T. 8 S., R. 14 W. - ?

DATED AND POSTED on the ground this 25<sup>TH</sup> day of SEPT, 2014

LOCATOR (s) A. Cash Cornell

AMC429574

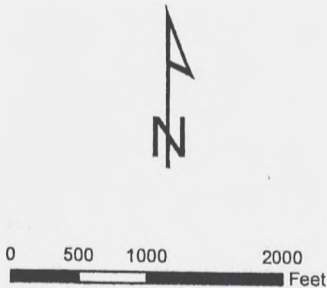
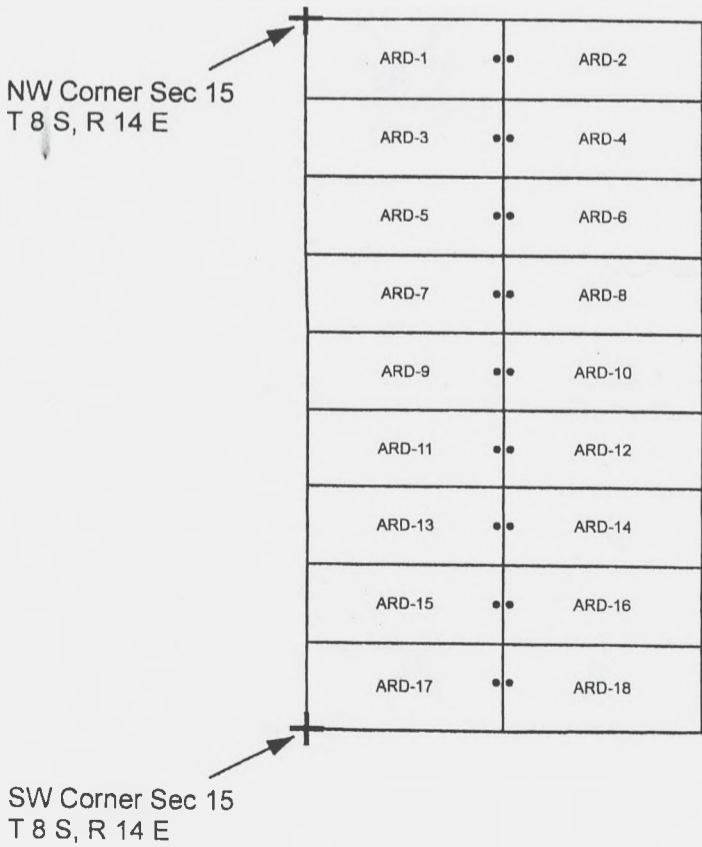

**LOCATION NOTICE FOR LOBE MINING CLAIM**

*CORRECTED*

RECEIVED  
BLM BUREAU OF LAND MANAGEMENT OFFICE  
Date: 2014 OCT 24 P 2:46  
Stamp  
PHOENIX, ARIZONA

NOTICE IS HEREBY GIVEN that the ARD-3  
\_\_\_\_\_ lode mining claim has been located by AVEN  
Associates LLC whose current mailing address is 7400 N. Oracle Road #131,  
Tucson, Arizona 85704. The general course of this claim is  
E-W and it is situated in Pinal County, Arizona.

This claim is 1500 feet in length and 600 feet in width. This claim runs from the location monument on which this  
location notice is posted approximately 1450 feet in a W direction to the W end center and  
50 feet in a E direction to the E end center. This claim is marked by four monuments,  
one at each corner. The location monument on which this notice is posted is situated within Section 15  
Township 8 S, Range 14 E, Gila and Salt River Prime Meridian, Arizona and this claim encompasses portions of the  
following quarter section(s), section(s), Township(s) and Range(s)

NW 1/4 Sec. 15, T. 8 S., R. 14 E.

The locality of this claim with reference to some natural object or permanent monument and additional information (if any)  
concerning its locality are as follows: This Location is approximately 1400 feet  
east and 870 feet south of the NW cor. Sec. 15,  
T. 8 S., R. 14 E.

DATED AND POSTED on the ground this 25<sup>th</sup> day of Sept 20 14

LOCATOR (s) A Clark Bonell

ANCL429515

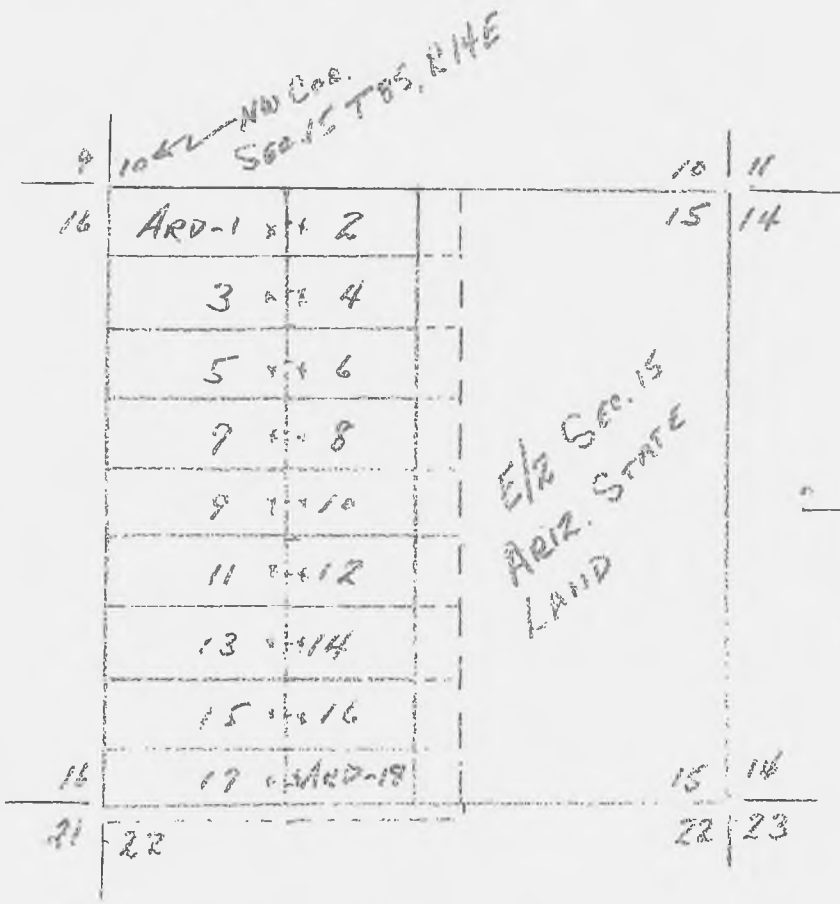

RECEIVED  
BLM BUREAU OF LAND MANAGEMENT OFFICE  
Date: 2015 MAY -4 P 3:25  
Stamp  
PHOENIX, ARIZONA

**LOCATION NOTICE FOR LODE MINING CLAIM**

NOTICE IS HEREBY GIVEN that the ARD-3  
\_\_\_\_\_ lode mining claim has been located by AVEN  
Associates LLC whose current mailing address is 7400 N. Oracle Road #131,  
Tucson, Arizona 85704. The general course of this claim is  
E-W and it is situated in Pinal County, Arizona.

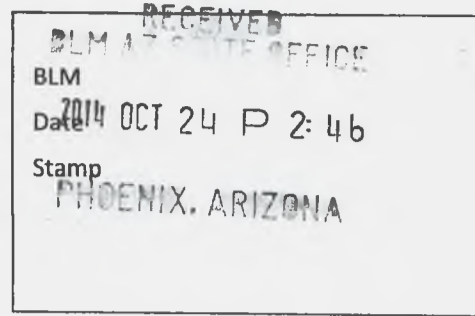

This claim is 1500 feet in length and 600 feet in width. This claim runs from the location monument on which this location notice is posted approximately 1450 feet in a W direction to the W end center and 50 feet in a E direction to the E end center. This claim is marked by four monuments, one at each corner. The location monument on which this notice is posted is situated within Section 15, Township 8 S, Range 14 E, Gila and Salt River Prime Meridian, Arizona and this claim encompasses portions of the following quarter section(s), section(s), Township(s) and Range(s)

NW 1/4 Sec. 15, T. 8 S., R. 14 E.

The locality of this claim with reference to some natural object or permanent monument and additional information (if any) concerning its locality are as follows: This Location is approximately 1400 feet east and 870 feet south of the NW cor. Sec. 15, T. 8 S., R. 14 E.

DATED AND POSTED on the ground this 25<sup>th</sup> day of Sept, 20 14.

LOCATOR (s) A. Clark Bonnell

AMC429575

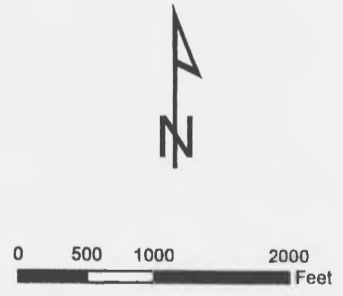
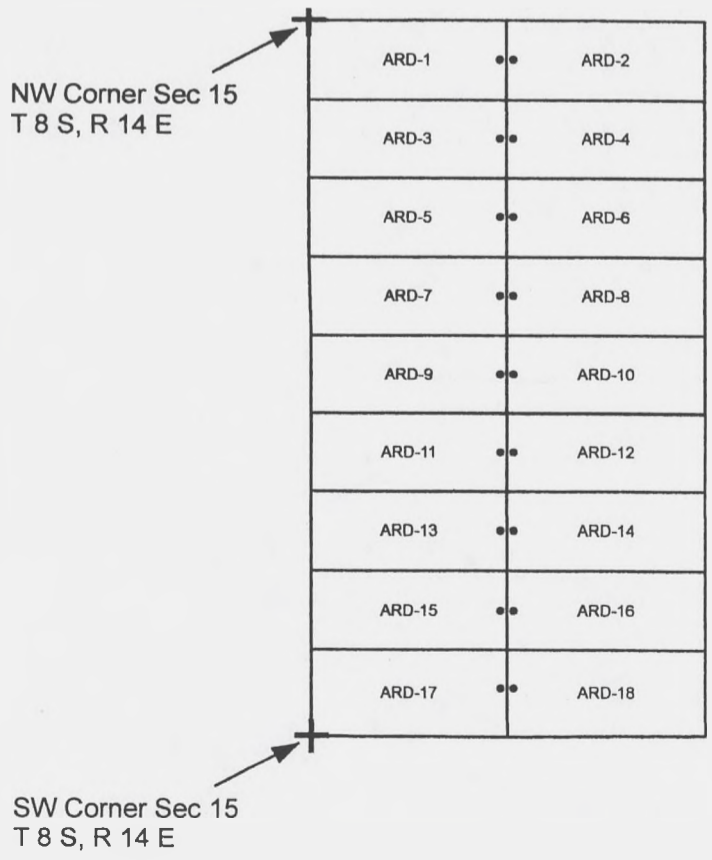

CORRECTED

LOCATION NOTICE FOR LODE MINING CLAIM

NOTICE IS HEREBY GIVEN that the ARD-4 lode mining claim has been located by AVEN Associates LLC whose current mailing address is 7400 N. Oracle Road #131, Tucson, Arizona 85704. The general course of this claim is

RECEIVED  
BLM STATE OFFICE  
Date 2014 OCT 24 P 2:46  
Stamp PHOENIX, ARIZONA

E-W and it is situated in Pinal County, Arizona.

This claim is 1500 feet in length and 600 feet in width. This claim runs from the location monument on which this location notice is posted approximately 1450 feet in a E direction to the E end center and 50 feet in a W direction to the W end center. This claim is marked by four monuments, one at each corner. The location monument on which this notice is posted is situated within Section 15, Township 8 S, Range 14 E, Gila and Salt River Prime Meridian, Arizona and this claim encompasses portions of the following quarter section(s), section(s), Township(s) and Range(s)

NW 1/4 Sec. 15, T. 8 S., R. 14 E.

The locality of this claim with reference to some natural object or permanent monument and additional information (if any) concerning its locality are as follows: This location is approximately 1500 feet east and 870 feet south of the NW cor. Sec. 15, T. 8 S., R. 14 E.

DATED AND POSTED on the ground this 25<sup>TH</sup> day of Sept, 2014

LOCATOR (s) A Cash Small

AMC429576

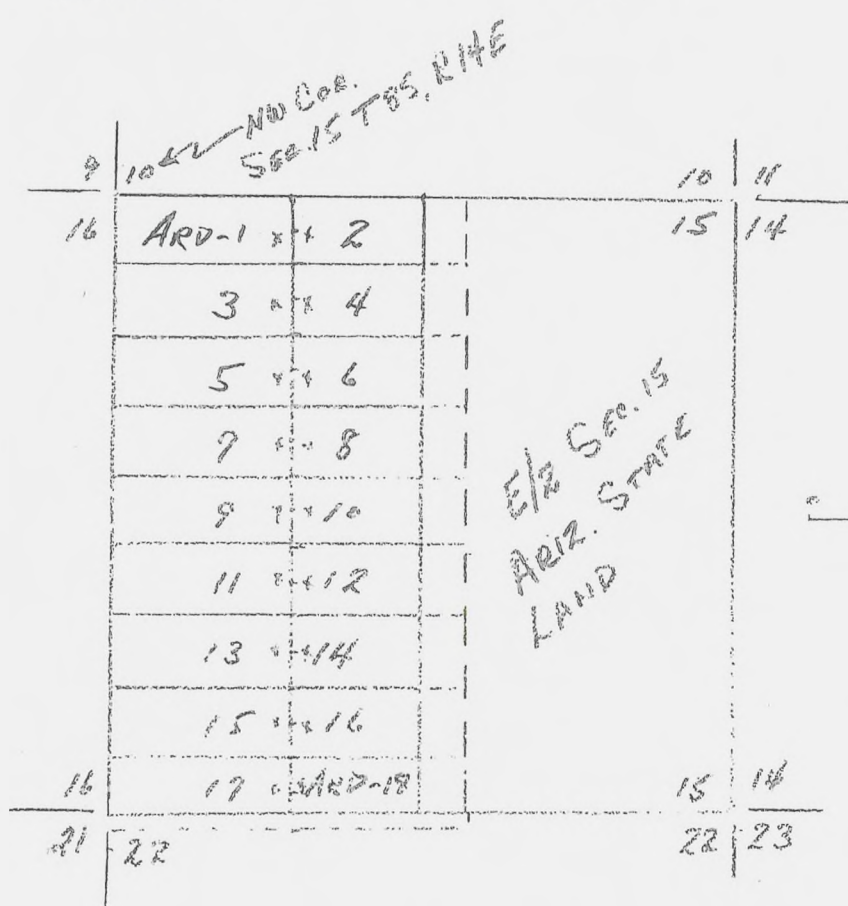

RECEIVED  
BLM STATE OFFICE  
2015 MAY -4 P 3:25  
PHOENIX, ARIZONA

**LOCATION NOTICE FOR LODE MINING CLAIM**

NOTICE IS HEREBY GIVEN that the ARD-4  
 \_\_\_\_\_ lode mining claim has been located by AVEN  
 Associates LLC whose current mailing address is 7400 N. Oracle Road #131,  
 Tucson, Arizona 85704. The general course of this claim is  
E-W and it is situated in Pinal County, Arizona.

**RECEIVED**  
 BLM AZ STATE OFFICE

BLM  
 Date 2014 OCT 24 P 2:46  
 Stamp PHOENIX, ARIZONA

This claim is 1500 feet in length and 600 feet in width. This claim runs from the location monument on which this location notice is posted approximately 1450 feet in a E direction to the E end center and 50 feet in a W direction to the W end center. This claim is marked by four monuments, one at each corner. The location monument on which this notice is posted is situated within Section 15, Township 8 S, Range 14 E, Gila and Salt River Prime Meridian, Arizona and this claim encompasses portions of the following quarter section(s), section(s), Township(s) and Range(s)

NW 1/4 Sec. 15, T. 8 S., R. 14 E.

The locality of this claim with reference to some natural object or permanent monument and additional information (if any) concerning its locality are as follows: This Location is approximately 1500 feet east and 870 feet south of the NW cor. Sec. 15, T. 8 S., R. 14 E.

DATED AND POSTED on the ground this 25<sup>TH</sup> day of Sept, 2014.

LOCATOR (s) A Cash Arnold

AMC429576

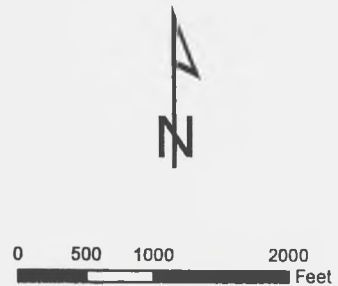
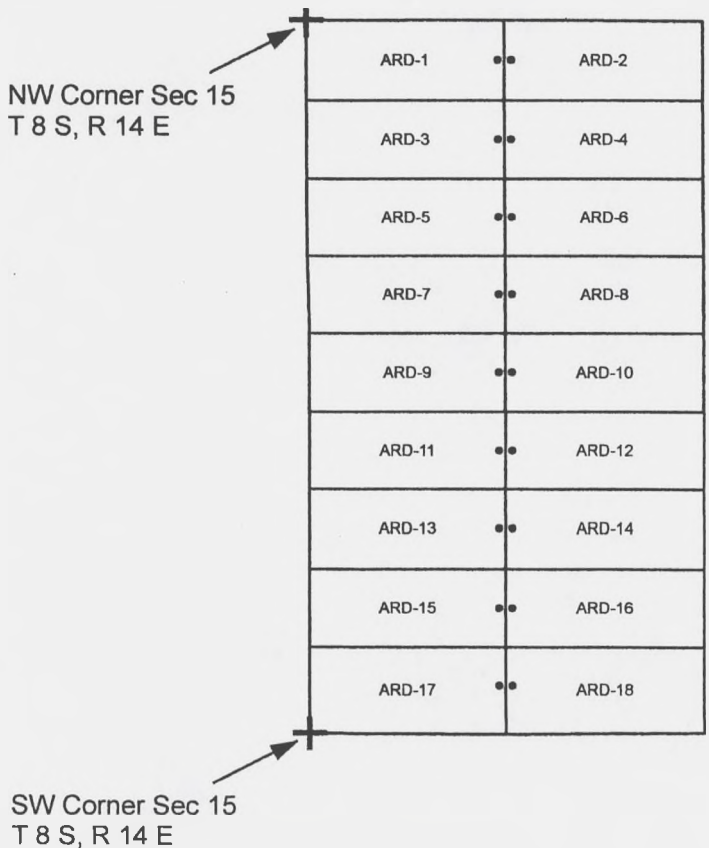

**LOCATION NOTICE FOR LOBE MINING CLAIM**

*CORRECTED*

NOTICE IS HEREBY GIVEN that the ARD-5  
 \_\_\_\_\_ lode mining claim has been located by AVEN  
 Associates LLC whose current mailing address is 7400 N. Oracle Road #131,  
 Tucson, Arizona 85704. The general course of this claim is  
E-W and it is situated in Pinal County, Arizona.

RECEIVED  
 BLM / LAND OFFICE  
 BLM  
 Date 2014 OCT 24 P 2:46  
 Stamp PHOENIX, ARIZONA

This claim is 1500 feet in length and 600 feet in width. This claim runs from the location monument on which this location notice is posted approximately 1450 feet in a W direction to the W end center and 50 feet in a E direction to the E end center. This claim is marked by four monuments, one at each corner. The location monument on which this notice is posted is situated within Section 15 Township 8 S, Range 14 E, Gila and Salt River Prime Meridian, Arizona and this claim encompasses portions of the following quarter section(s), section(s), Township(s) and Range(s)

NW 1/4 Sec. 15, T. 8 S., R. 14 E.

The locality of this claim with reference to some natural object or permanent monument and additional information (if any) concerning its locality are as follows: This location is approximately 1400 feet east and 1440 feet south of the NW cor. Sec. 15, T. 8 S., R. 14 E.

DATED AND POSTED on the ground this 25<sup>TH</sup> day of SEPT, 2014.

LOCATOR (s) L. Claster Arnold

AMC429517

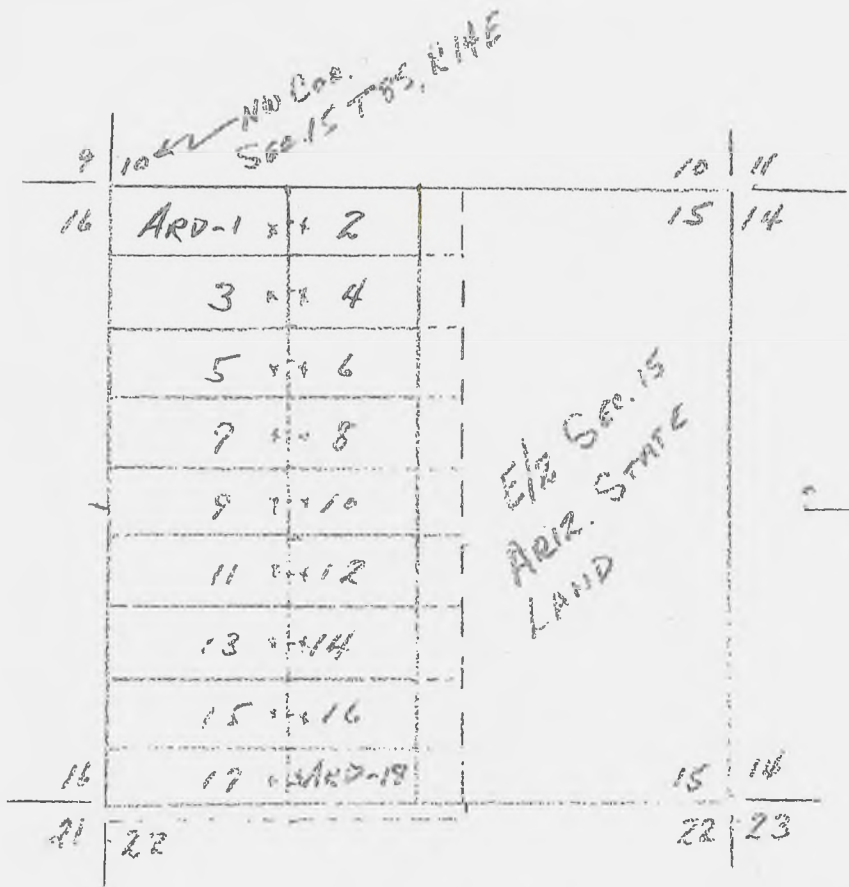

**LOCATION NOTICE FOR LODE MINING CLAIM**

NOTICE IS HEREBY GIVEN that the ARD-5  
 \_\_\_\_\_ lode mining claim has been located by AVEN  
 Associates LLC whose current mailing address is 7400 N. Oracle Road #131,  
 Tucson, Arizona 85704. The general course of this claim is  
E-W and it is situated in Pinal County, Arizona.

RECEIVED  
 BLM AZ STATE OFFICE

BLM  
 Date 2014 OCT 24 P 2:46  
 Stamp PHOENIX, ARIZONA

This claim is 1500 feet in length and 600 feet in width. This claim runs from the location monument on which this location notice is posted approximately 1450 feet in a W direction to the W end center and 50 feet in a E direction to the E end center. This claim is marked by four monuments, one at each corner. The location monument on which this notice is posted is situated within Section 15, Township 8 S, Range 14 E, Gila and Salt River Prime Meridian, Arizona and this claim encompasses portions of the following quarter section(s), section(s), Township(s) and Range(s)

NW 1/4 Sec. 15, T. 8 S., R. 14 E.

The locality of this claim with reference to some natural object or permanent monument and additional information (if any) concerning its locality are as follows: This location is approximately 1400 feet east and 1440 feet south of the NW cor. Sec. 15, T. 8 S., R. 14 E.

DATED AND POSTED on the ground this 25<sup>TH</sup> day of SEPT, 2014.

LOCATOR (s) A. Clark Arnold

AMC429577

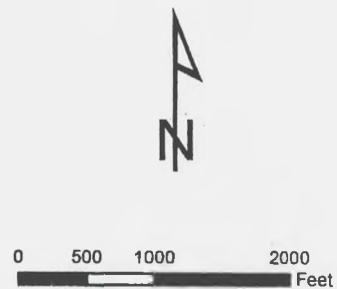
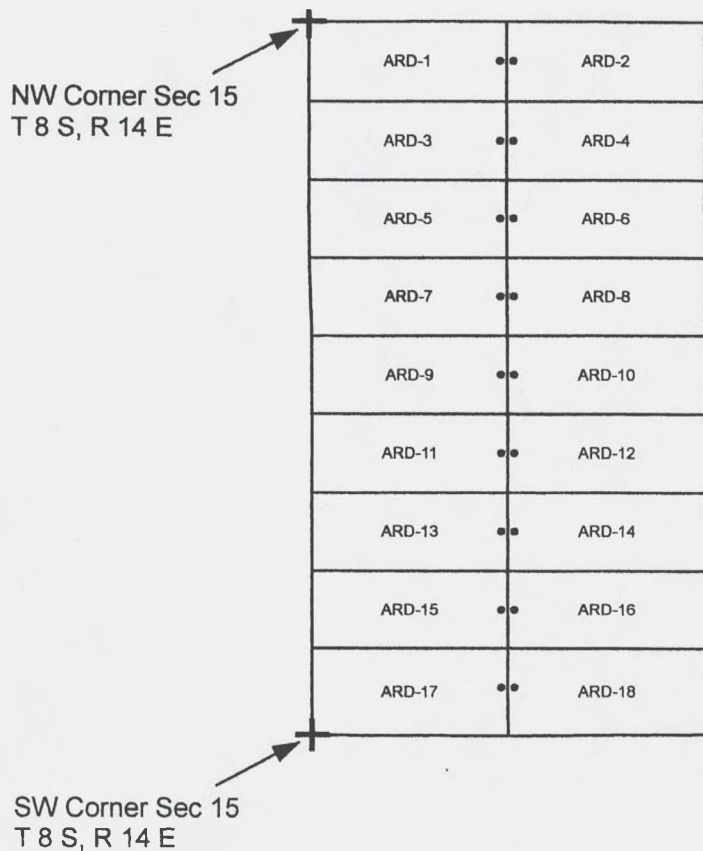

**LOCATION NOTICE FOR LODE MINING CLAIM**

*CORRECTED*

NOTICE IS HEREBY GIVEN that the ARD-6  
 \_\_\_\_\_ lode mining claim has been located by AVEN  
 Associates LLC whose current mailing address is 7400 N. Oracle Road #131,  
 Tucson, Arizona 85704. The general course of this claim is  
E-W and it is situated in Pinal County, Arizona.

RECEIVED  
 BLM PHOENIX OFFICE  
 BLM  
 Date 2014 OCT 24 P 2:46  
 Stamp  
 PHOENIX, ARIZONA

This claim is 1500 feet in length and 600 feet in width. This claim runs from the location monument on which this  
 location notice is posted approximately 1450 feet in a E direction to the E end center and  
50 feet in a W direction to the W end center. This claim is marked by four monuments,  
 one at each corner. The location monument on which this notice is posted is situated within Section 15,  
 Township 8 S, Range 14 E, Gila and Salt River Prime Meridian, Arizona and this claim encompasses portions of the  
 following quarter section(s), section(s), Township(s) and Range(s)

NW 1/4 Sec. 15, T. 8 S., R. 14 E.

The locality of this claim with reference to some natural object or permanent monument and additional information (if any)  
 concerning its locality are as follows: This location is approximately 1500 feet  
past and 1440 feet south of the NW cor. Sec. 15,  
T. 8 S., R. 14 E.

DATED AND POSTED on the ground this 25<sup>th</sup> day of SEPT, 2014

LOCATOR (s) L Clark Small

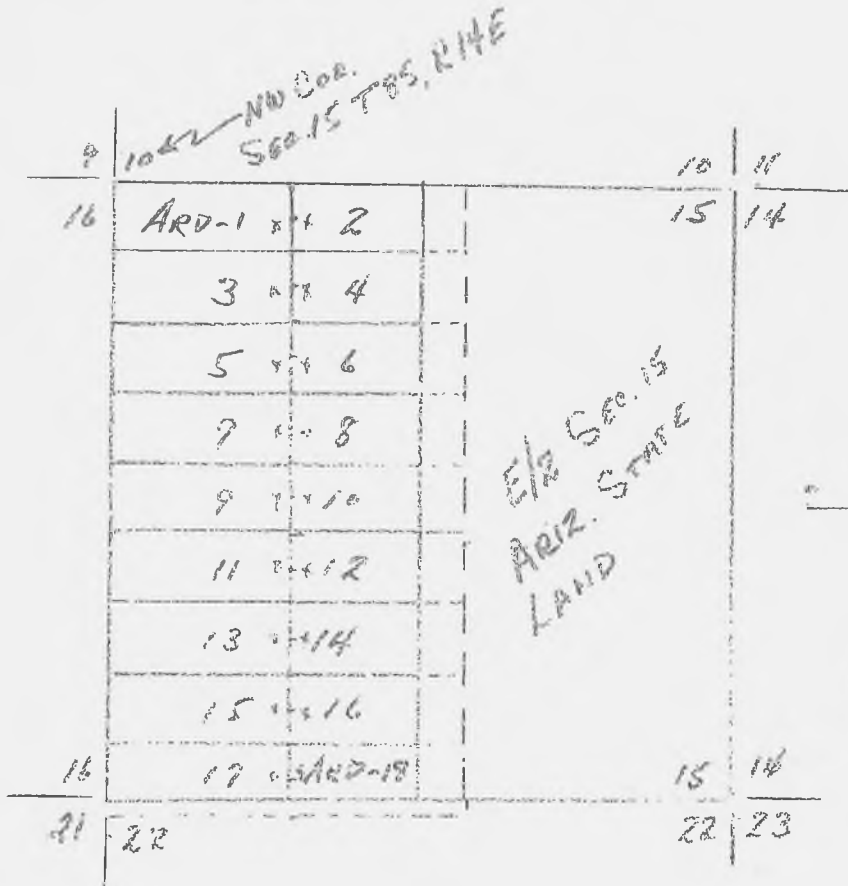

Stamp  
 PHOENIX, ARIZONA  
 2015 MAY -4 P 3:25

ANC429578



**LOCATION NOTICE FOR LODE MINING CLAIM**

NOTICE IS HEREBY GIVEN that the ARD-6  
 \_\_\_\_\_ lode mining claim has been located by AVEN  
 Associates LLC whose current mailing address is 7400 N. Oracle Road #131,  
 Tucson, Arizona 85704. The general course of this claim is  
E-W and it is situated in Pinal County, Arizona.

**RECEIVED**

BLM AT STATE OFFICE  
 BLM  
 Date 2014 OCT 24 P 2:46  
 Stamp  
 PHOENIX, ARIZONA

This claim is 1500 feet in length and 600 feet in width. This claim runs from the location monument on which this location notice is posted approximately 1450 feet in a E direction to the E end center and 50 feet in a W direction to the W end center. This claim is marked by four monuments, one at each corner. The location monument on which this notice is posted is situated within Section 15, Township 8 S, Range 14 E, Gila and Salt River Prime Meridian, Arizona and this claim encompasses portions of the following quarter section(s), section(s), Township(s) and Range(s)

NW 1/4 Sec. 15, T. 8 S., R. 14 E.

The locality of this claim with reference to some natural object or permanent monument and additional information (if any) concerning its locality are as follows: This location is approximately 1500 feet east and 1440 feet south of the NW cor. Sec. 15, T. 8 S., R. 14 E.

DATED AND POSTED on the ground this 25<sup>th</sup> day of SEPT, 2014.

LOCATOR (s) L Clark Arnold

AMC429578

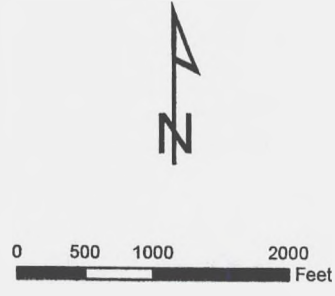
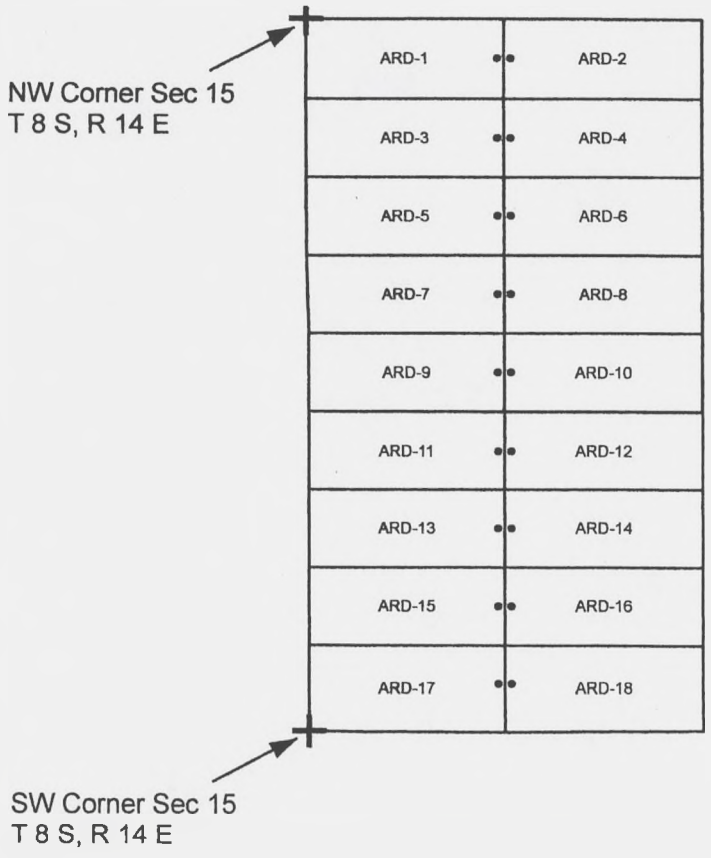

**LOCATION NOTICE FOR LODE MINING CLAIM**

*CORRECTED*

RECEIVED  
BLM PHOENIX OFFICE  
Date 2014 OCT 24 P 2:46  
Stamp  
PHOENIX, ARIZONA

NOTICE IS HEREBY GIVEN that the ARD-7  
\_\_\_\_\_ lode mining claim has been located by AVEN  
Associates LLC whose current mailing address is 7400 N. Oracle Road #131,  
Tucson, Arizona 85704. The general course of this claim is  
E-W and it is situated in Pinal County, Arizona.

This claim is 1500 feet in length and 600 feet in width. This claim runs from the location monument on which this  
location notice is posted approximately 1450 feet in a W direction to the W end center and  
50 feet in a E direction to the E end center. This claim is marked by four monuments,  
one at each corner. The location monument on which this notice is posted is situated within Section 15,  
Township 8 S, Range 14 E, Gila and Salt River Prime Meridian, Arizona and this claim encompasses portions of the  
following quarter section(s), section(s), Township(s) and Range(s)

NW 1/4 Sec. 15, T. 8 S., R. 14 E.

The locality of this claim with reference to some natural object or permanent monument and additional information (if any)  
concerning its locality are as follows: This Location is approximately 1400 feet  
east and 2000 feet south of the NW cor. Sec. 15,  
T. 8 S., R. 14 E.

DATED AND POSTED on the ground this 25<sup>TH</sup> day of Sept, 2014

LOCATOR (s) L. Clask Randall

AMC429519

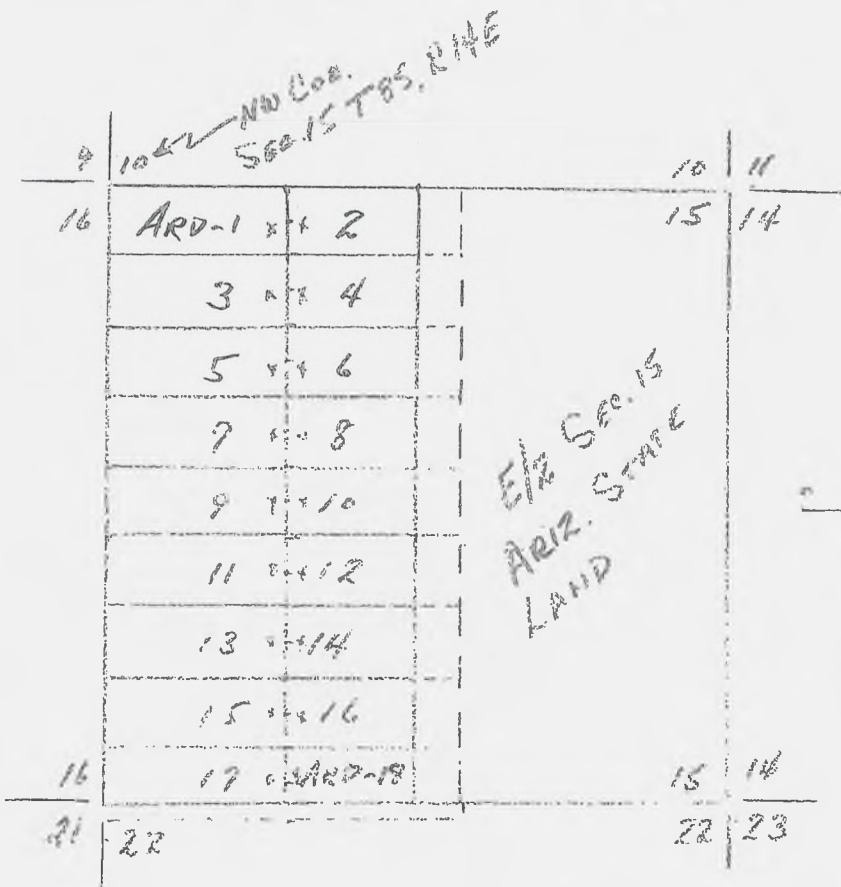

SEARCHED  
INDEXED  
SERIALIZED  
OCT 25 2014  
BLM PHOENIX OFFICE  
PHOENIX, ARIZONA

**LOCATION NOTICE FOR LODE MINING CLAIM**

NOTICE IS HEREBY GIVEN that the ARD-7  
\_\_\_\_\_ lode mining claim has been located by AVEN  
Associates LLC whose current mailing address is 7400 N. Oracle Road #131,  
Tucson, Arizona 85704. The general course of this claim is  
E-W and it is situated in Pinal County, Arizona.

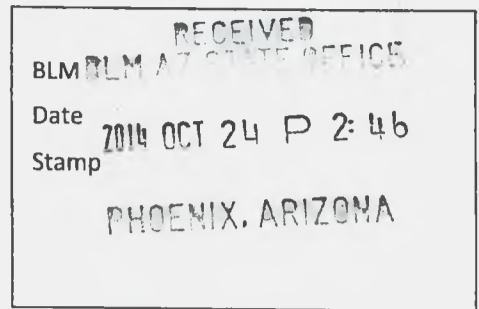

This claim is 1500 feet in length and 600 feet in width. This claim runs from the location monument on which this location notice is posted approximately 1450 feet in a W direction to the W end center and 50 feet in a E direction to the E end center. This claim is marked by four monuments, one at each corner. The location monument on which this notice is posted is situated within Section 15, Township 8 S, Range 14 E, Gila and Salt River Prime Meridian, Arizona and this claim encompasses portions of the following quarter section(s), section(s), Township(s) and Range(s)  
NW 1/4 Sec. 15, T. 8 S., R. 14 E.

The locality of this claim with reference to some natural object or permanent monument and additional information (if any) concerning its locality are as follows: This Location is approximately 1400 feet east and 2000 feet south of the NW cor. Sec. 15, T. 8 S., R. 14 E.

DATED AND POSTED on the ground this 25<sup>TH</sup> day of Sept, 2014.

LOCATOR (s) L. Clark Conrad

AMC429579

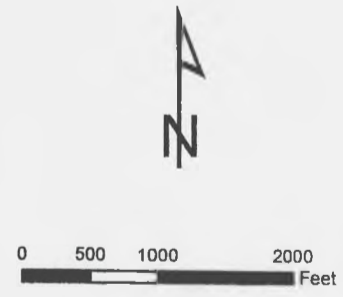
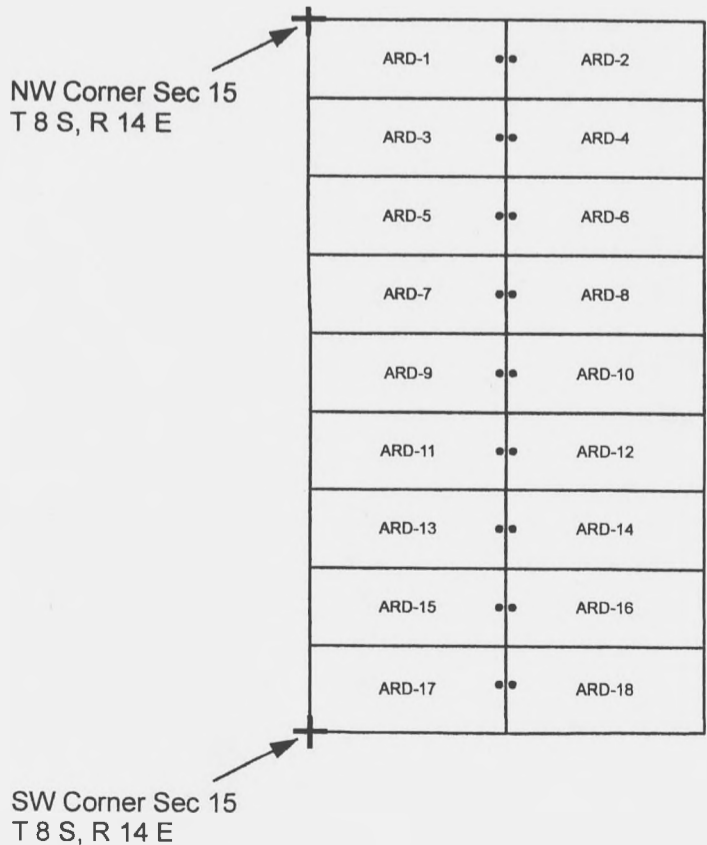

**LOCATION NOTICE FOR LODE MINING CLAIM**

*CORRECTED*

RECEIVED  
BLM OFFICE  
Date 2014 OCT 24 P 2:47  
Stamp PHOENIX, ARIZONA

NOTICE IS HEREBY GIVEN that the ARD-8  
lode mining claim has been located by AVEN  
Associates LLC whose current mailing address is 7400 N. Oracle Road #131,  
Tucson, Arizona 85704. The general course of this claim is  
E-W and it is situated in Pinal County, Arizona.

This claim is 1500 feet in length and 600 feet in width. This claim runs from the location monument on which this location notice is posted approximately 1450 feet in a E direction to the E end center and 50 feet in a W direction to the W end center. This claim is marked by four monuments, one at each corner. The location monument on which this notice is posted is situated within Section 15, Township 8 S, Range 14 E, Gila and Salt River Prime Meridian, Arizona and this claim encompasses portions of the following quarter section(s), section(s), Township(s) and Range(s)  
NW 1/4 Sec. 15, T. 8 S., R. 14 E.

The locality of this claim with reference to some natural object or permanent monument and additional information (if any) concerning its locality are as follows: This Location is approximately 1500 feet past and 2000 feet south of the NW cor. Sec. 15, T. 8 S., R. 14 E.

DATED AND POSTED on the ground this 25<sup>TH</sup> day of SEPT, 2014.

LOCATOR (s) L Plaster Brndell

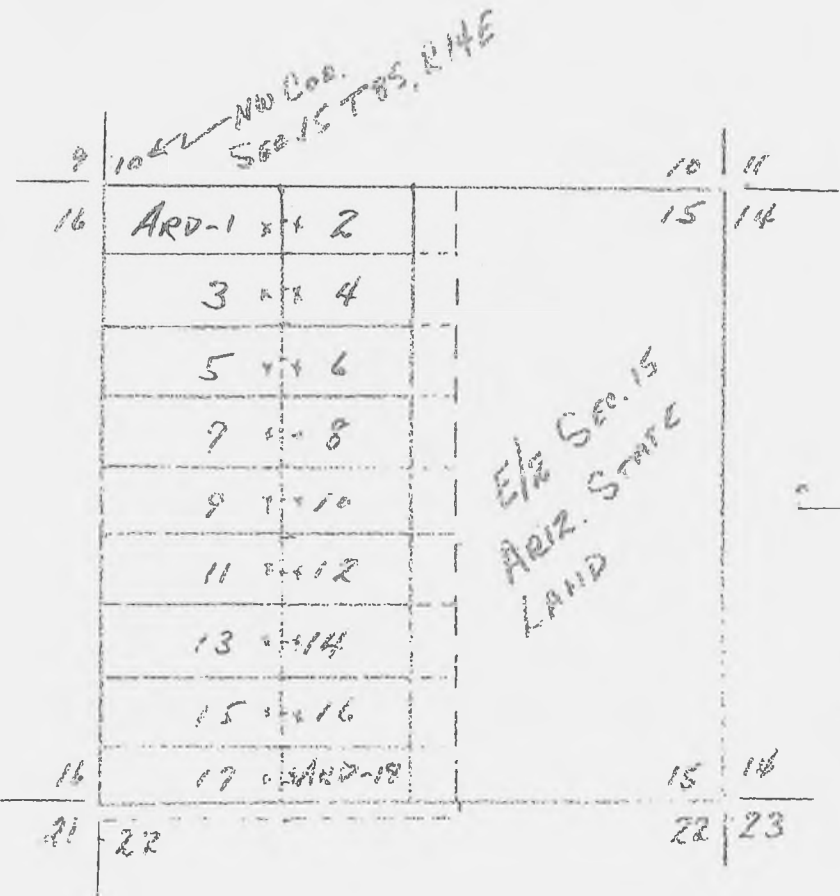

SCALE 1 IN = 100 FT.  
BLM / Z. LAND OFFICE  
PHOENIX, ARIZONA  
2015 MAY -4 P 3:25

ANCL 29580

**LOCATION NOTICE FOR LODE MINING CLAIM**

NOTICE IS HEREBY GIVEN that the ARD-8  
\_\_\_\_\_ lode mining claim has been located by AVEN  
Associates LLC whose current mailing address is 7400 N. Oracle Road #131,  
Tucson, Arizona 85704. The general course of this claim is  
E-W and it is situated in Pinal County, Arizona.

**RECEIVED**  
BLM A7 STATE OFFICE  
BLM  
Date **2014 OCT 24 P 2:47**  
Stamp  
**PHOENIX, ARIZONA**

This claim is 1500 feet in length and 600 feet in width. This claim runs from the location monument on which this location notice is posted approximately 1450 feet in a E direction to the E end center and 50 feet in a W direction to the W end center. This claim is marked by four monuments, one at each corner. The location monument on which this notice is posted is situated within Section 15, Township 8 S, Range 14 E, Gila and Salt River Prime Meridian, Arizona and this claim encompasses portions of the following quarter section(s), section(s), Township(s) and Range(s)

NW 1/4 Sec. 15, T. 8 S., R. 14 E.

The locality of this claim with reference to some natural object or permanent monument and additional information (if any) concerning its locality are as follows: This Location is approximately 1500 feet east and 2000 feet south of the NW cor. Sec. 15, T. 8 S., R. 14 E.

DATED AND POSTED on the ground this 25<sup>TH</sup> day of SEPT, 2014.

LOCATOR (s) L Clark Arnold

AMC429580

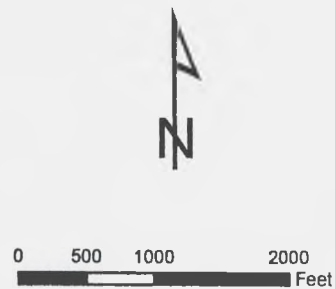
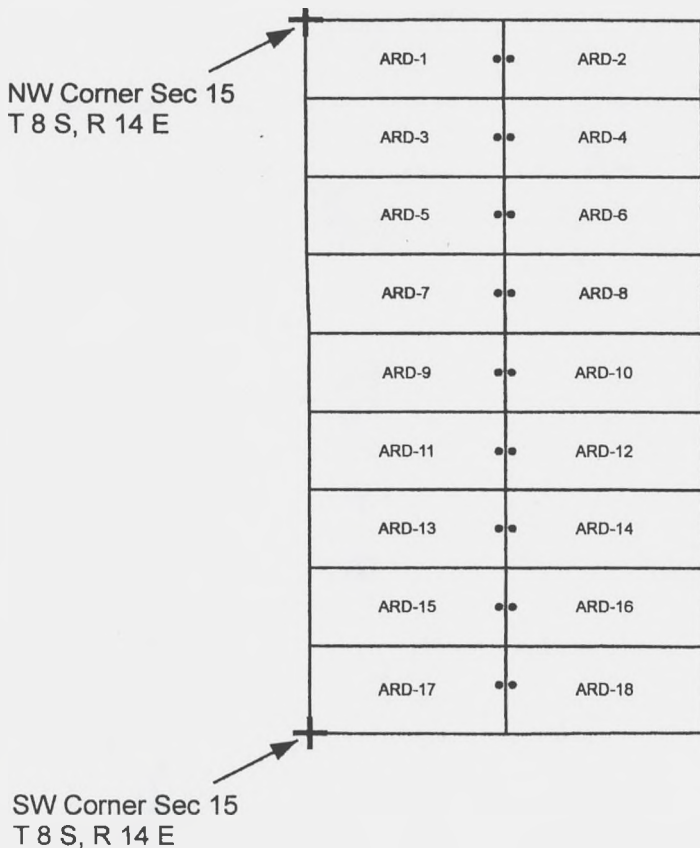

**LOCATION NOTICE FOR LODE MINING CLAIM**

*Corrected*

RECEIVED  
BLM BLM OFFICE  
Date 2014 OCT 24 P 2:47  
Stamp  
PHOENIX, ARIZONA

NOTICE IS HEREBY GIVEN that the ARD-9  
lode mining claim has been located by AVEN  
Associates LLC whose current mailing address is 7400 N. Oracle Road #131,  
Tucson, Arizona 85704. The general course of this claim is  
E-W and it is situated in Pinal County, Arizona.

This claim is 1500 feet in length and 600 feet in width. This claim runs from the location monument on which this  
location notice is posted approximately 1450 feet in a W direction to the W end center and  
50 feet in a E direction to the E end center. This claim is marked by four monuments,  
one at each corner. The location monument on which this notice is posted is situated within Section 15,  
Township 8 S, Range 14 E, Gila and Salt River Prime Meridian, Arizona and this claim encompasses portions of the  
following quarter section(s), section(s), Township(s) and Range(s)

NW 1/4 and SW 1/4 Sec. 15, T. 8 S., R. 14 E.

The locality of this claim with reference to some natural object or permanent monument and additional information (if any)  
concerning its locality are as follows: This Location is approximately 1400 feet  
east and 2570 feet south of the NW cor. Sec. 15,  
T. 8 S., R. 14 E.

DATED AND POSTED on the ground this 25<sup>TH</sup> day of SEPT, 2014.

LOCATOR (s) *A. Clark Conrad*

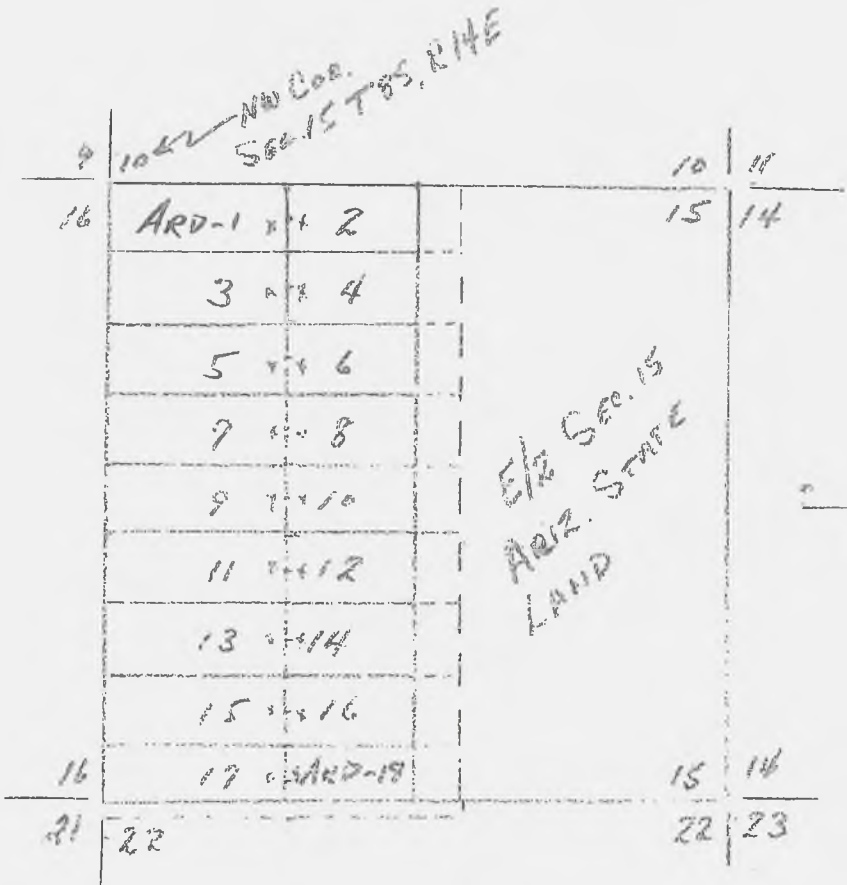

AMC42958

RECEIVED  
BLM BLM OFFICE  
2015 MAY -4 P 3:25  
PHOENIX, ARIZONA

**LOCATION NOTICE FOR LODE MINING CLAIM**

NOTICE IS HEREBY GIVEN that the ARD-9  
\_\_\_\_\_ lode mining claim has been located by AVEN  
Associates LLC whose current mailing address is 7400 N. Oracle Road #131,  
Tucson, Arizona 85704. The general course of this claim is  
E-W and it is situated in Pinal County, Arizona.

RECEIVED  
BLM BLM ARIZONA STATE OFFICE  
Date 2014 OCT 24 P 2:47  
Stamp  
PHOENIX, ARIZONA

This claim is 1500 feet in length and 600 feet in width. This claim runs from the location monument on which this location notice is posted approximately 1450 feet in a W direction to the W end center and 50 feet in a E direction to the E end center. This claim is marked by four monuments, one at each corner. The location monument on which this notice is posted is situated within Section 15, Township 8 S, Range 14 E, Gila and Salt River Prime Meridian, Arizona and this claim encompasses portions of the following quarter section(s), section(s), Township(s) and Range(s)

NW 1/4 and SW 1/4 Sec. 15, T. 8 S., R. 14 E.

The locality of this claim with reference to some natural object or permanent monument and additional information (if any) concerning its locality are as follows: This Location is approximately 1400 feet east and 2570 feet south of the NW cor. Sec. 15, T. 8 S., R. 14 E.

DATED AND POSTED on the ground this 25<sup>TH</sup> day of SEPT, 2014.

LOCATOR (s) A. Clash Corral

AMC429581

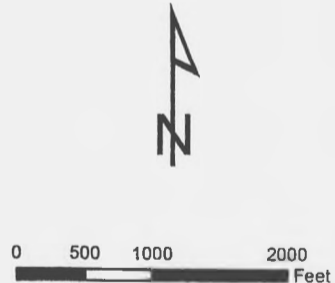
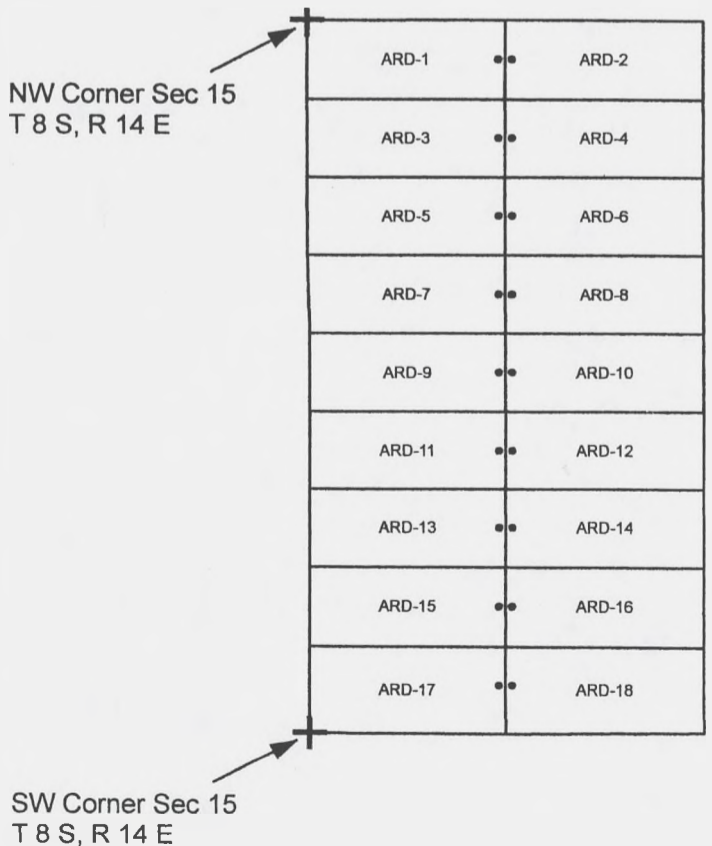

CORRECTED

LOCATION NOTICE FOR LODE MINING CLAIM

NOTICE IS HEREBY GIVEN that the ARD-10 lode mining claim has been located by AVEN Associates LLC whose current mailing address is 7400 N. Oracle Road #131, Tucson, Arizona 85704. The general course of this claim is E-W and it is situated in Pinal County, Arizona.

RECEIVED  
BLM PHOENIX OFFICE  
Date 2014 OCT 24 P 2:47  
Stamp PHOENIX, ARIZONA

This claim is 1500 feet in length and 600 feet in width. This claim runs from the location monument on which this location notice is posted approximately 1450 feet in a E direction to the E end center and 50 feet in a W direction to the W end center. This claim is marked by four monuments, one at each corner. The location monument on which this notice is posted is situated within Section 15, Township 8 S, Range 14 E, Gila and Salt River Prime Meridian, Arizona and this claim encompasses portions of the following quarter section(s), section(s), Township(s) and Range(s)

NW 1/4 and SW 1/4 Sec 15, T. 8 S., R. 14 E.

The locality of this claim with reference to some natural object or permanent monument and additional information (if any) concerning its locality are as follows: This location is approximately 1500 feet east and 2570 feet south of the NW cor. Sec. 15, T. 8 S., R. 14 E.

DATED AND POSTED on the ground this 25TH day of SEPT, 2014

LOCATOR (s) L. Clark Arnold

AMC429582

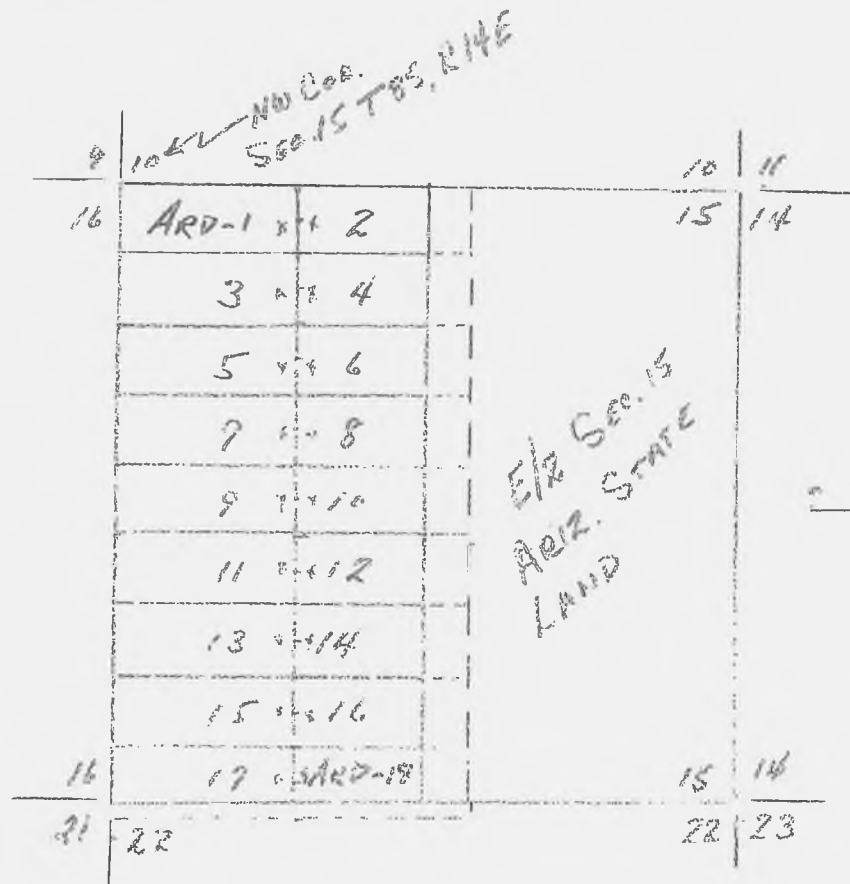

SCALE IN FT.  
2015 MAY -4 P 3:25  
PHOENIX, ARIZONA



**LOCATION NOTICE FOR LODE MINING CLAIM**

NOTICE IS HEREBY GIVEN that the ARD-10  
\_\_\_\_\_ lode mining claim has been located by AVEN  
Associates LLC whose current mailing address is 7400 N. Oracle Road #131,  
Tucson, Arizona 85704. The general course of this claim is  
E-W and it is situated in Pinal County, Arizona.

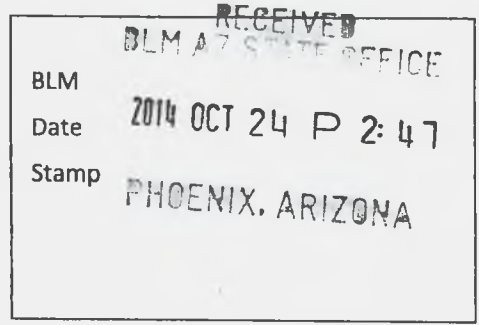

This claim is 1500 feet in length and 600 feet in width. This claim runs from the location monument on which this location notice is posted approximately 1450 feet in a E direction to the E end center and 50 feet in a W direction to the W end center. This claim is marked by four monuments, one at each corner. The location monument on which this notice is posted is situated within Section 15 Township 8 S, Range 14 E, Gila and Salt River Prime Meridian, Arizona and this claim encompasses portions of the following quarter section(s), section(s), Township(s) and Range(s)

NW 1/4 and SW 1/4 Sec. 15, T. 8 S., R. 14 E.

The locality of this claim with reference to some natural object or permanent monument and additional information (if any) concerning its locality are as follows: This Location is approximately 1500 feet east and 2570 feet south of the NW cor. Sec. 15, T. 8 S., R. 14 E.

DATED AND POSTED on the ground this 25TH day of SEPT, 2014

LOCATOR (s) L. Clark Arnold

AMC 429582

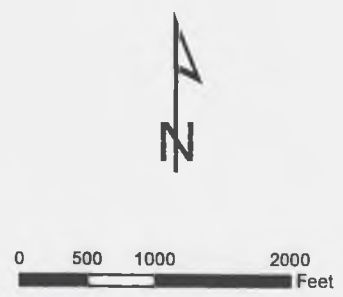
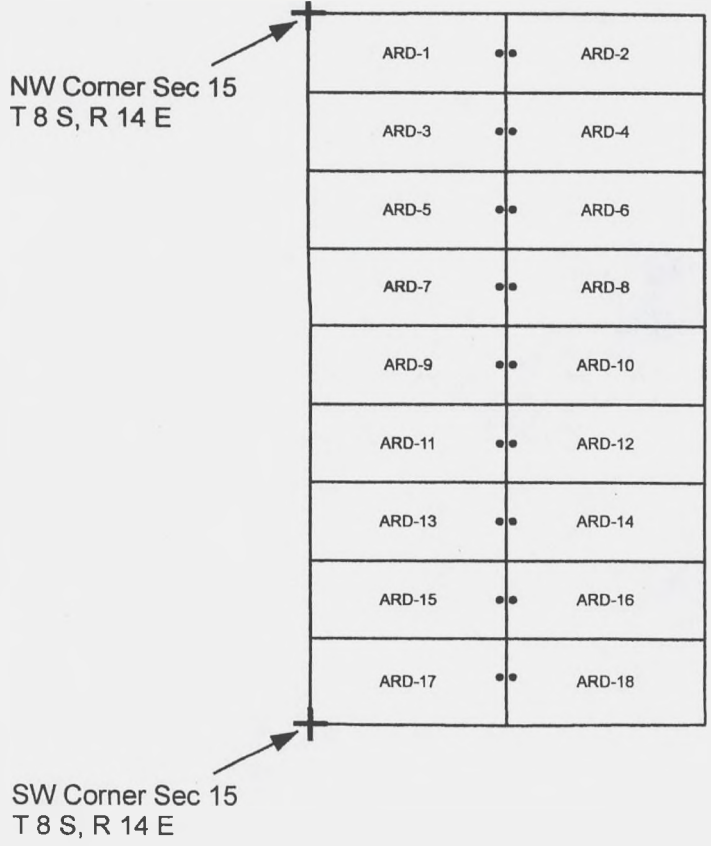

**LOCATION NOTICE FOR LODE MINING CLAIM**

*CORRECTED*

NOTICE IS HEREBY GIVEN that the ARD-11  
 \_\_\_\_\_ lode mining claim has been located by AVEN  
 Associates LLC whose current mailing address is 7400 N. Oracle Road #131,  
 Tucson, Arizona 85704. The general course of this claim is  
E-W and it is situated in Pinal County, Arizona.

RECEIVED  
 BLM DISTRICT OFFICE  
 Date 2014 OCT 24 P 2:47  
 Stamp PHOENIX, ARIZONA

This claim is 1500 feet in length and 600 feet in width. This claim runs from the location monument on which this location notice is posted approximately 1450 feet in a W direction to the W end center and 50 feet in a E direction to the E end center. This claim is marked by four monuments, one at each corner. The location monument on which this notice is posted is situated within Section 15, Township 8 S, Range 14 E, Gila and Salt River Prime Meridian, Arizona and this claim encompasses portions of the following quarter section(s), section(s), Township(s) and Range(s)  
SW 1/4 Sec 15, T. 8 S., R. 14 E.

The locality of this claim with reference to some natural object or permanent monument and additional information (if any) concerning its locality are as follows: This location is approximately 1400 feet east and 3140 feet south of the NW cor. SEC 15, T. 8 S., R. 14 E.

DATED AND POSTED on the ground this 25<sup>TH</sup> day of SEPT, 2014

LOCATOR (s) A Clark Cornell

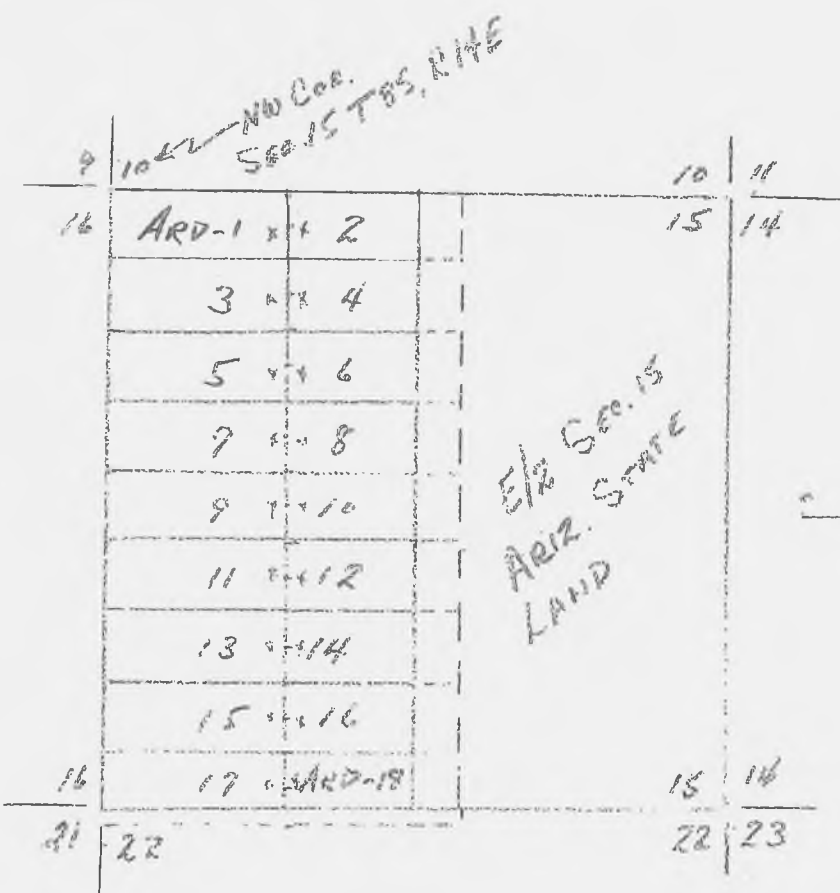

RECEIVED  
 BLM DISTRICT OFFICE  
 Date 2015 MAY -4 P 3:26  
 PHOENIX, ARIZONA

ANCL 29583

**LOCATION NOTICE FOR LODE MINING CLAIM**

NOTICE IS HEREBY GIVEN that the ARD-11  
\_\_\_\_\_ lode mining claim has been located by AVEN  
Associates LLC whose current mailing address is 7400 N. Oracle Road #131,  
Tucson, Arizona 85704. The general course of this claim is  
E-W and it is situated in Pinal County, Arizona.

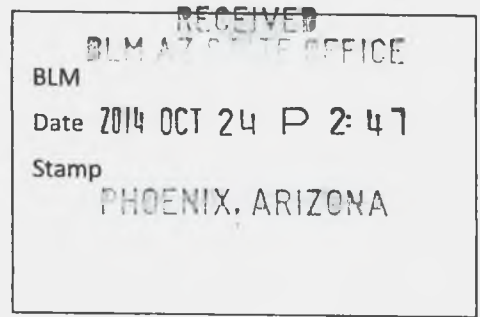

This claim is 1500 feet in length and 600 feet in width. This claim runs from the location monument on which this location notice is posted approximately 1450 feet in a W direction to the W end center and 50 feet in a E direction to the E end center. This claim is marked by four monuments, one at each corner. The location monument on which this notice is posted is situated within Section 15, Township 8 S, Range 14 E, Gila and Salt River Prime Meridian, Arizona and this claim encompasses portions of the following quarter section(s), section(s), Township(s) and Range(s)  
SW 1/4 Sec 15, T. 8 S., R. 14 E.

The locality of this claim with reference to some natural object or permanent monument and additional information (if any) concerning its locality are as follows: This Location is approximately 1400 feet east and 3140 feet south of the NW cor. Sec. 15, T. 8 S., R. 14 E.

DATED AND POSTED on the ground this 25<sup>TH</sup> day of SEPT, 2014.

LOCATOR (s) Clark Cornell

AMC429583

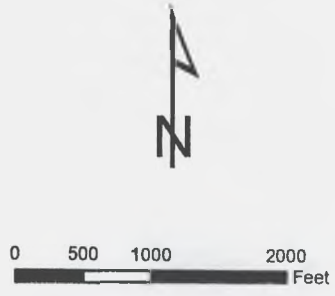
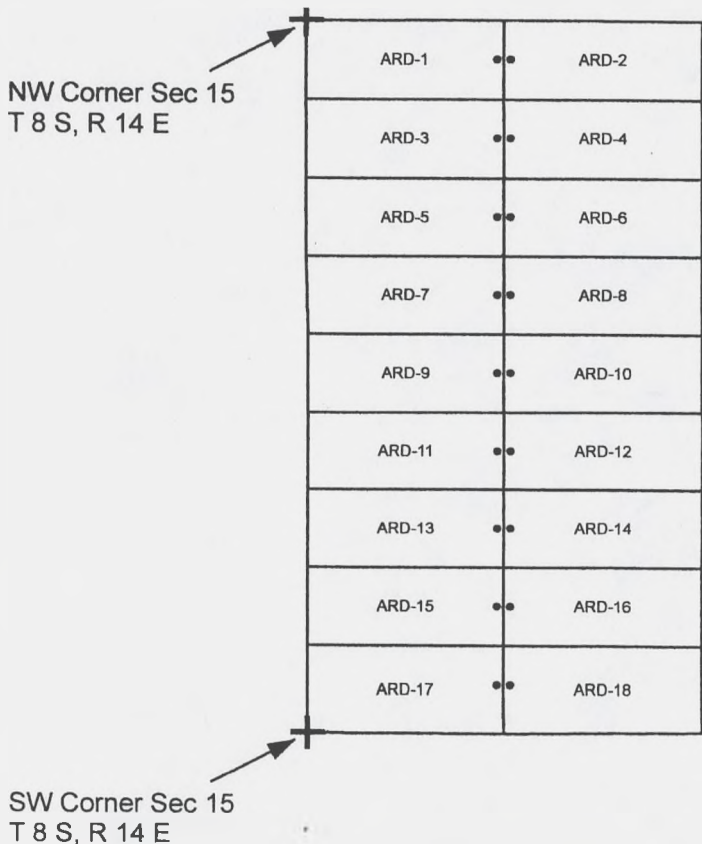

CORRECTED

LOCATION NOTICE FOR LOBE MINING CLAIM

RECEIVED  
BLM OFFICE  
Date 2014 OCT 24 P 2:47  
Stamp  
PHOENIX, ARIZONA

NOTICE IS HEREBY GIVEN that the ARD-12  
lode mining claim has been located by AVEN  
Associates LLC whose current mailing address is 7400 N. Oracle Road #131,  
Tucson, Arizona 85704. The general course of this claim is  
E-W and it is situated in Pinal County, Arizona.

This claim is 1500 feet in length and 600 feet in width. This claim runs from the location monument on which this  
location notice is posted approximately 1450 feet in a E direction to the E end center and  
50 feet in a W direction to the W end center. This claim is marked by four monuments,  
one at each corner. The location monument on which this notice is posted is situated within Section 15  
Township 8 S, Range 14 E, Gila and Salt River Prime Meridian, Arizona and this claim encompasses portions of the  
following quarter section(s), section(s), Township(s) and Range(s)

SW 1/4 Sec. 15, T. 8 S., R. 14 E.

The locality of this claim with reference to some natural object or permanent monument and additional information (if any)  
concerning its locality are as follows: This Location is approximately 1500 feet  
east and 3140 feet south of the NW Cor. Sec. 15,  
T. 8 S., R. 14 E.

DATED AND POSTED on the ground this 25<sup>TH</sup> day of SEPT, 2014

LOCATOR (s) L. Clash Arnold

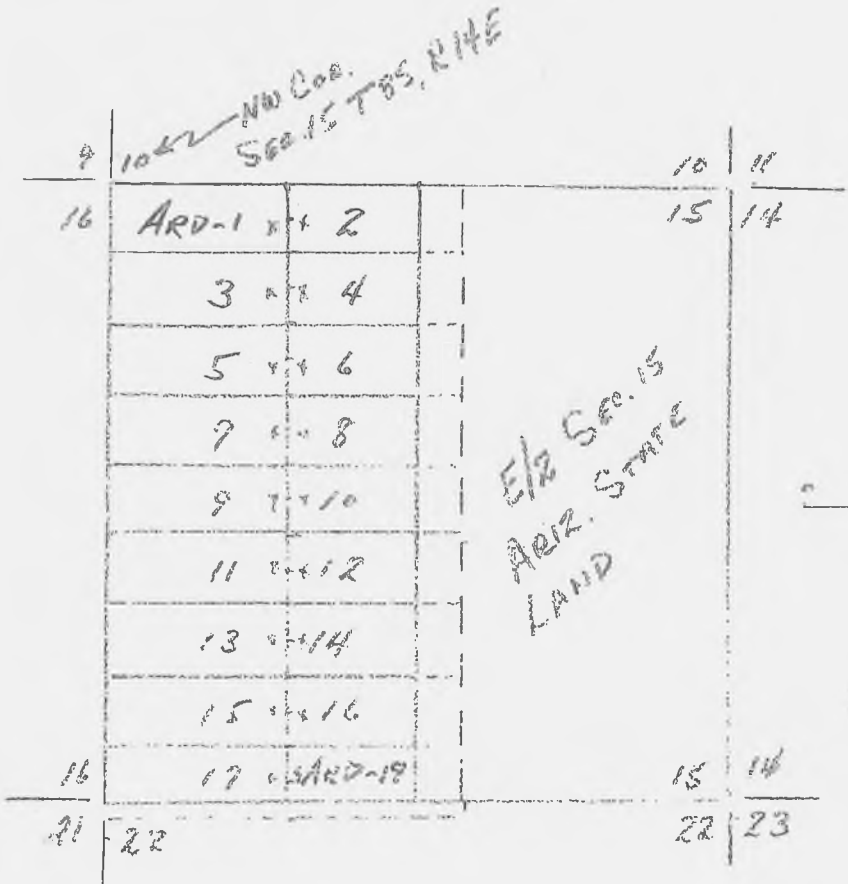

AMC 429584  
N  
0 1000 2000 3000  
SCALE IN FT.  
PHOENIX, ARIZONA  
2015 MAY -4 P 3:26

**LOCATION NOTICE FOR LODE MINING CLAIM**

NOTICE IS HEREBY GIVEN that the ARD-12  
\_\_\_\_\_ lode mining claim has been located by AVEN  
Associates LLC whose current mailing address is 7400 N. Oracle Road #131,  
Tucson, Arizona 85704. The general course of this claim is  
E-W and it is situated in Pinal County, Arizona.

RECEIVED  
BLM AT STATE OFFICE  
Date 2014 OCT 24 P 2:47  
Stamp  
PHOENIX, ARIZONA

This claim is 1500 feet in length and 600 feet in width. This claim runs from the location monument on which this  
location notice is posted approximately 1450 feet in a E direction to the E end center and  
50 feet in a W direction to the W end center. This claim is marked by four monuments,  
one at each corner. The location monument on which this notice is posted is situated within Section 15,  
Township 8 S, Range 14 E, Gila and Salt River Prime Meridian, Arizona and this claim encompasses portions of the  
following quarter section(s), section(s), Township(s) and Range(s)

SW 1/4 Sec. 15, T. 8 S., R. 14 E.

The locality of this claim with reference to some natural object or permanent monument and additional information (if any)  
concerning its locality are as follows: This Location is approximately 1500 feet  
east and 3140 feet south of the NW Cor. Sec. 15,  
T. 8 S., R. 14 E.

DATED AND POSTED on the ground this 25<sup>TH</sup> day of SEPT, 2014.

LOCATOR (s) L Clark Arnold

AMC429584

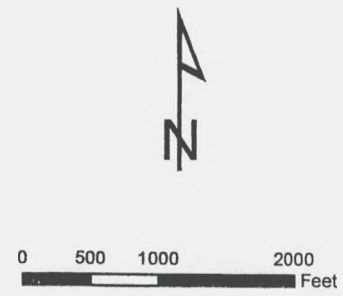
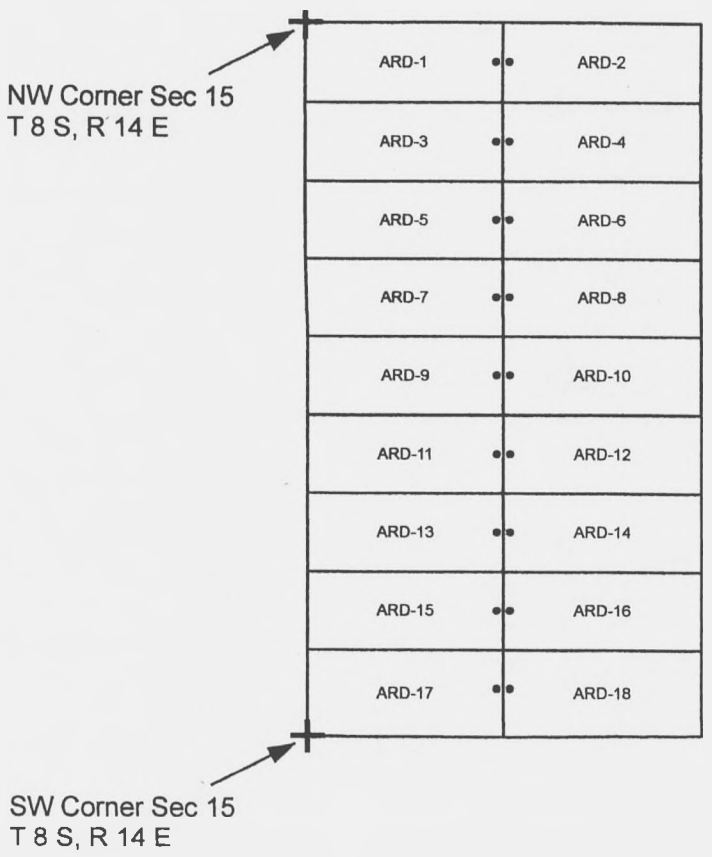

**LOCATION NOTICE FOR LODE MINING CLAIM**

*CORRECTED*

NOTICE IS HEREBY GIVEN that the ARD-13  
 \_\_\_\_\_ lode mining claim has been located by AVEN  
 Associates LLC whose current mailing address is 7400 N. Oracle Road #131,  
 Tucson, Arizona 85704. The general course of this claim is  
E-W and it is situated in Pinal County, Arizona.

RECEIVED  
 BLM OFFICE  
 DATE OCT 24 P 2:48  
 Stamp  
 PHOENIX, ARIZONA

This claim is 1500 feet in length and 600 feet in width. This claim runs from the location monument on which this location notice is posted approximately 1450 feet in a W direction to the W end center and 50 feet in a E direction to the E end center. This claim is marked by four monuments, one at each corner. The location monument on which this notice is posted is situated within Section 15, Township 8 S, Range 14 E, Gila and Salt River Prime Meridian, Arizona and this claim encompasses portions of the following quarter section(s), section(s), Township(s) and Range(s)

SW 1/4 Sec. 15, T. 8 S., R. 14 E.

The locality of this claim with reference to some natural object or permanent monument and additional information (if any) concerning its locality are as follows: This Location is approximately 1400 feet east and 3740 feet south of the NW cor. Sec. 15, T. 8 S., R. 14 E.

DATED AND POSTED on the ground this 25<sup>TH</sup> day of SEPT, 2014

LOCATOR (s) L. Clark Brall

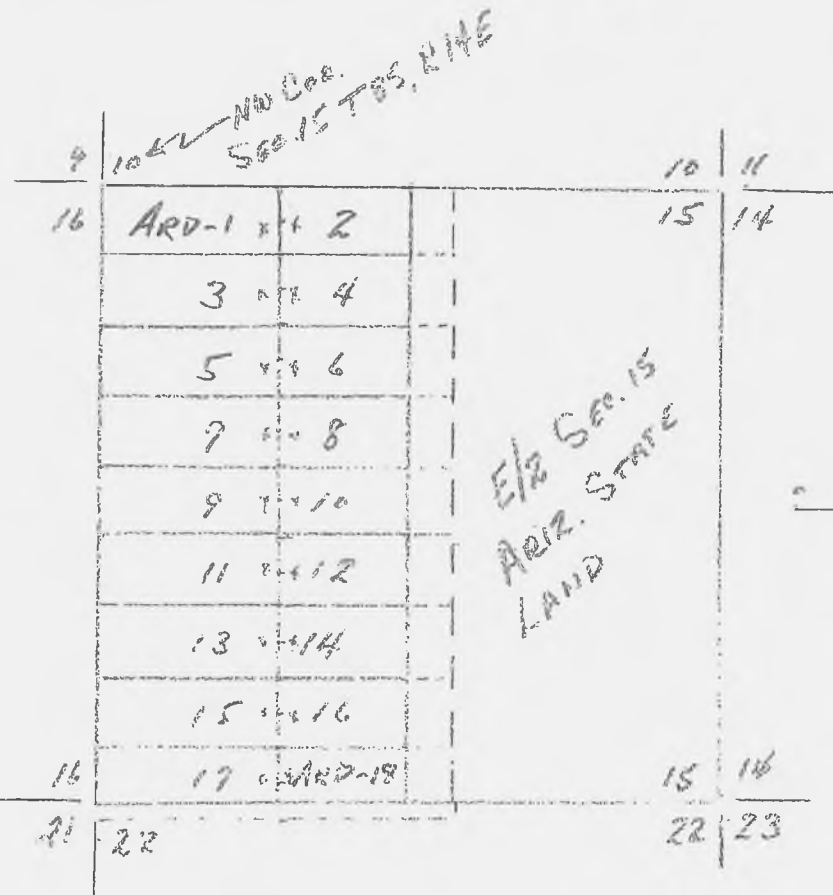

AMC429585

**LOCATION NOTICE FOR LODE MINING CLAIM**

NOTICE IS HEREBY GIVEN that the ARD-13  
lode mining claim has been located by AVEN  
Associates LLC whose current mailing address is 7400 N. Oracle Road #131,  
Tucson, Arizona 85704. The general course of this claim is  
E-W and it is situated in Pinal County, Arizona.

RECEIVED  
BLM AZ STATE OFFICE  
Date Stamp  
2014 OCT 24 P 2:48  
PHOENIX, ARIZONA

This claim is 1500 feet in length and 600 feet in width. This claim runs from the location monument on which this location notice is posted approximately 1450 feet in a W direction to the W end center and 50 feet in a E direction to the E end center. This claim is marked by four monuments, one at each corner. The location monument on which this notice is posted is situated within Section 15, Township 8 S, Range 14 E, Gila and Salt River Prime Meridian, Arizona and this claim encompasses portions of the following quarter section(s), section(s), Township(s) and Range(s)  
SW 1/4 Sec. 15, T. 8 S., R. 14 E.

The locality of this claim with reference to some natural object or permanent monument and additional information (if any) concerning its locality are as follows: This Location is approximately 1400 feet east and 3740 feet south of the NW cor. Sec. 15, T. 8 S., R. 14 E.

DATED AND POSTED on the ground this 25<sup>TH</sup> day of SEPT, 2014.

LOCATOR (s) L. Clark Arnold

AMC429585

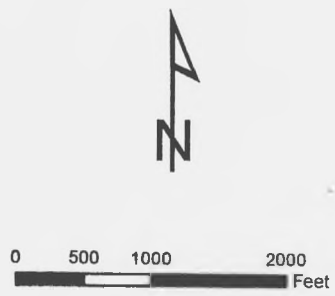
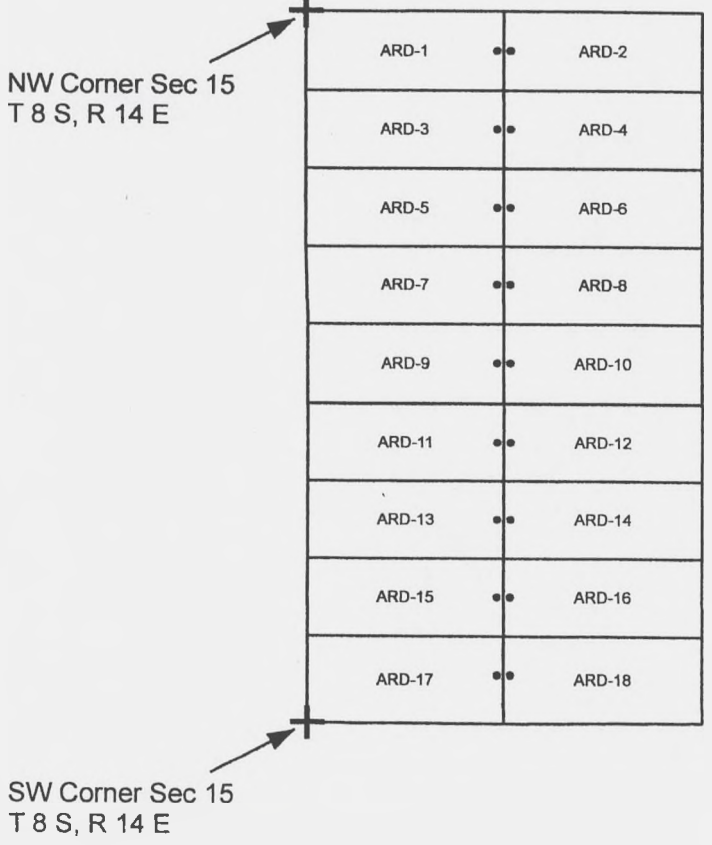

**LOCATION NOTICE FOR LODE MINING CLAIM**

*CORRECTED*

NOTICE IS HEREBY GIVEN that the ARD-14  
 \_\_\_\_\_ lode mining claim has been located by AVEN  
 Associates LLC whose current mailing address is 7400 N. Oracle Road #131,  
 Tucson, Arizona 85704. The general course of this claim is  
E-W and it is situated in Pinal County, Arizona.

RECEIVED  
 BLM  
 Date 2014 OCT 24 P 2:48  
 Stamp  
 PHOENIX, ARIZONA

This claim is 1500 feet in length and 606 feet in width. This claim runs from the location monument on which this location notice is posted approximately 1450 feet in a E direction to the E end center and 50 feet in a W direction to the W end center. This claim is marked by four monuments, one at each corner. The location monument on which this notice is posted is situated within Section 15, Township 8 S, Range 14 E, Gila and Salt River Prime Meridian, Arizona and this claim encompasses portions of the following quarter section(s), section(s), Township(s) and Range(s)

SW 1/4 Sec. 15, T. 8 S., R. 14 E.

The locality of this claim with reference to some natural object or permanent monument and additional information (if any) concerning its locality are as follows: This Location is approximately 1500 feet east and 3740 feet south of the NW cor. Sec. 15, T. 8 S., R. 14 E.

DATED AND POSTED on the ground this 25<sup>TH</sup> day of SEPT, 2014.

LOCATOR (s) A. Clash Connold

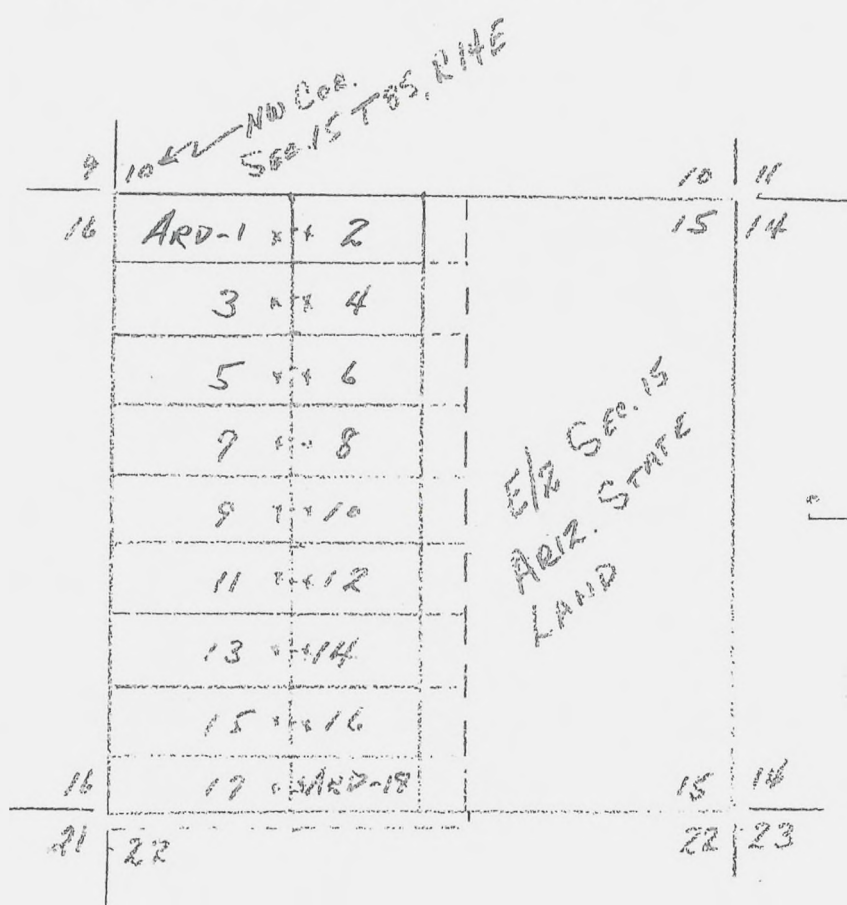

AMC 429586



**LOCATION NOTICE FOR LODE MINING CLAIM**

NOTICE IS HEREBY GIVEN that the ARD-14  
\_\_\_\_\_ lode mining claim has been located by AVEN  
Associates LLC whose current mailing address is 7400 N. Oracle Road #131,  
Tucson, Arizona 85704. The general course of this claim is  
E-W and it is situated in Pinal County, Arizona.

RECEIVED  
BLM AZ STATE OFFICE  
BLM  
Date 2014 OCT 24 P 2:48  
Stamp  
PHOENIX, ARIZONA

This claim is 1500 feet in length and 600 feet in width. This claim runs from the location monument on which this  
location notice is posted approximately 1450 feet in a E direction to the E end center and  
50 feet in a W direction to the W end center. This claim is marked by four monuments,  
one at each corner. The location monument on which this notice is posted is situated within Section 15,  
Township 8 S, Range 14 E, Gila and Salt River Prime Meridian, Arizona and this claim encompasses portions of the  
following quarter section(s), section(s), Township(s) and Range(s)  
SW 1/4 Sec. 15, T. 8 S., R. 14 E.

The locality of this claim with reference to some natural object or permanent monument and additional information (if any)  
concerning its locality are as follows: This Location is approximately 1500 feet  
east and 3740 feet south of the NW cor. Sec. 15,  
T. 8 S., R. 14 E.

DATED AND POSTED on the ground this 25<sup>TH</sup> day of SEPT, 2014.

LOCATOR (s) A. Closh Corrold

AMC 429586

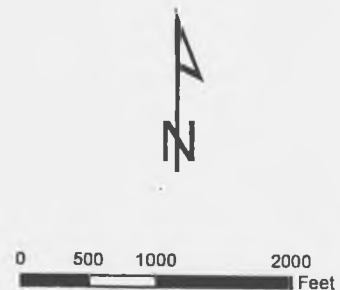
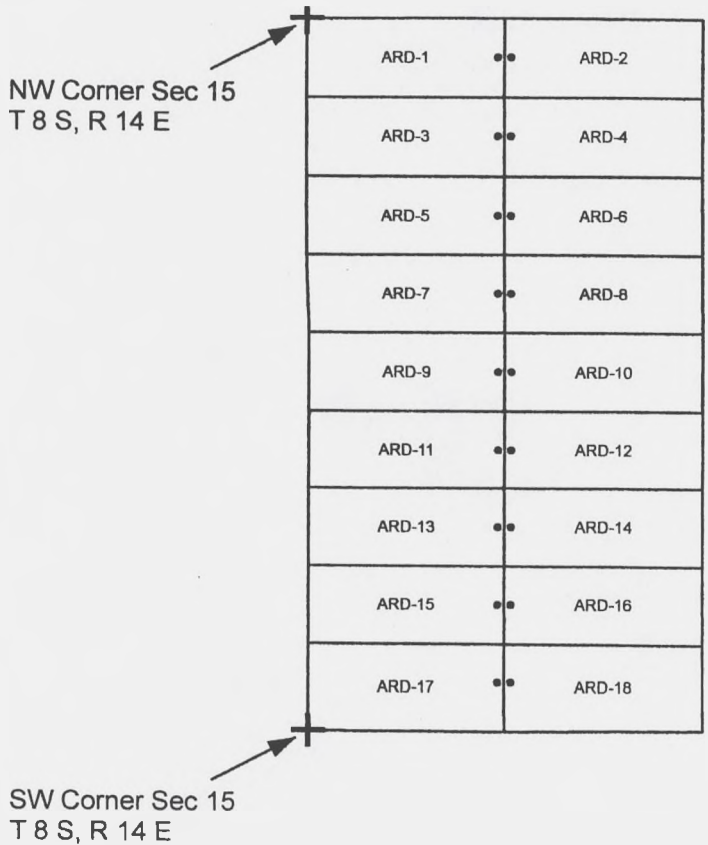

**LOCATION NOTICE FOR LOOSE MINING CLAIM**

NOTICE IS HEREBY GIVEN that the ARD-15 *Copy*  
 \_\_\_\_\_ lode mining claim has been located by AVEN  
 Associates LLC whose current mailing address is 7400 N. Oracle Road #131,  
 Tucson, Arizona 85704. The general course of this claim is  
E-W and it is situated in Pinal County, Arizona.

BLM  
 Date  
 Stamp  
**RECEIVED**  
 2014 OCT 24 P 2:48  
 PHOENIX, ARIZONA

This claim is 1500 feet in length and 600 feet in width. This claim runs from the location monument on which this location notice is posted approximately 1450 feet in a W direction to the W end center and 50 feet in a E direction to the E end center. This claim is marked by four monuments, one at each corner. The location monument on which this notice is posted is situated within Section 15, Township 8 S, Range 14 E, Gila and Salt River Prime Meridian, Arizona and this claim encompasses portions of the following quarter section(s), section(s), Township(s) and Range(s)

SW 1/4 Sec. 15, T. 8 S., R. 14 E.

The locality of this claim with reference to some natural object or permanent monument and additional information (if any) concerning its locality are as follows: This location is approximately 1400 feet east and 4340 feet south of the NW cor. Sec 15, T. 8 S., R. 14 E.

DATED AND POSTED on the ground this 25<sup>TH</sup> day of SEPT, 2014

LOCATOR (s) Clark Ronald

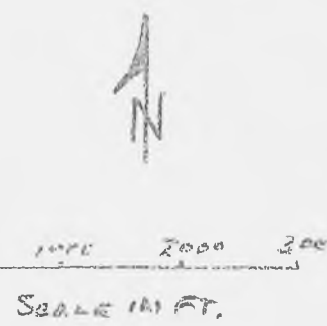
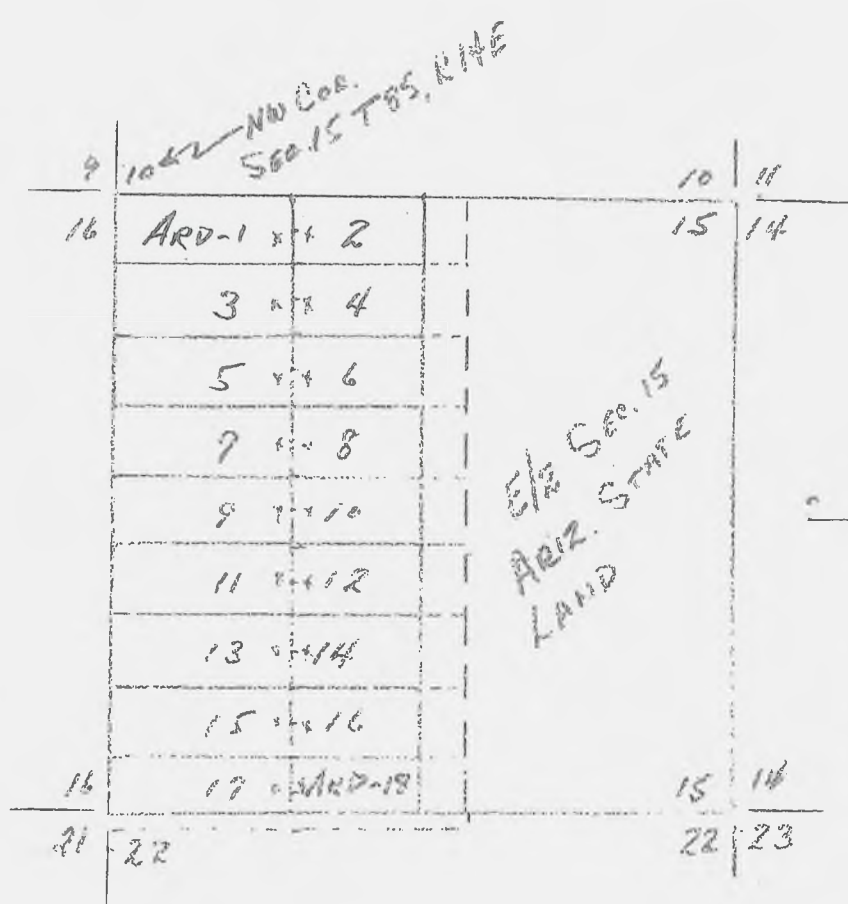

BLM AZ STATE OFFICE  
 2015 MAY -4 P 3:26  
 PHOENIX, ARIZONA

AMC429587

**LOCATION NOTICE FOR LODE MINING CLAIM**

NOTICE IS HEREBY GIVEN that the ARD-15  
 \_\_\_\_\_ lode mining claim has been located by AVEN  
 Associates LLC whose current mailing address is 7400 N. Oracle Road #131,  
 Tucson, Arizona 85704. The general course of this claim is  
E-W and it is situated in Pinal County, Arizona.

BLM  
 Date  
 Stamp RECEIVED  
 ARIZONA STATE OFFICE  
 2014 OCT 24 P 2:48  
 PHOENIX, ARIZONA

This claim is 1500 feet in length and 600 feet in width. This claim runs from the location monument on which this  
 location notice is posted approximately 1450 feet in a W direction to the W end center and  
50 feet in a E direction to the E end center. This claim is marked by four monuments,  
 one at each corner. The location monument on which this notice is posted is situated within Section 15,  
 Township 8 S, Range 14 E, Gila and Salt River Prime Meridian, Arizona and this claim encompasses portions of the  
 following quarter section(s), section(s), Township(s) and Range(s)  
SW 1/4 Sec. 15, T. 8 S., R. 14 E.

The locality of this claim with reference to some natural object or permanent monument and additional information (if any)  
 concerning its locality are as follows: This location is approximately 1400 feet  
east and 4340 feet south of the NW cor. Sec. 15,  
T. 8 S., R. 14 E.

DATED AND POSTED on the ground this 25<sup>TH</sup> day of SEPT, 2014.

LOCATOR (s) L Clark Arnold

AMC429587

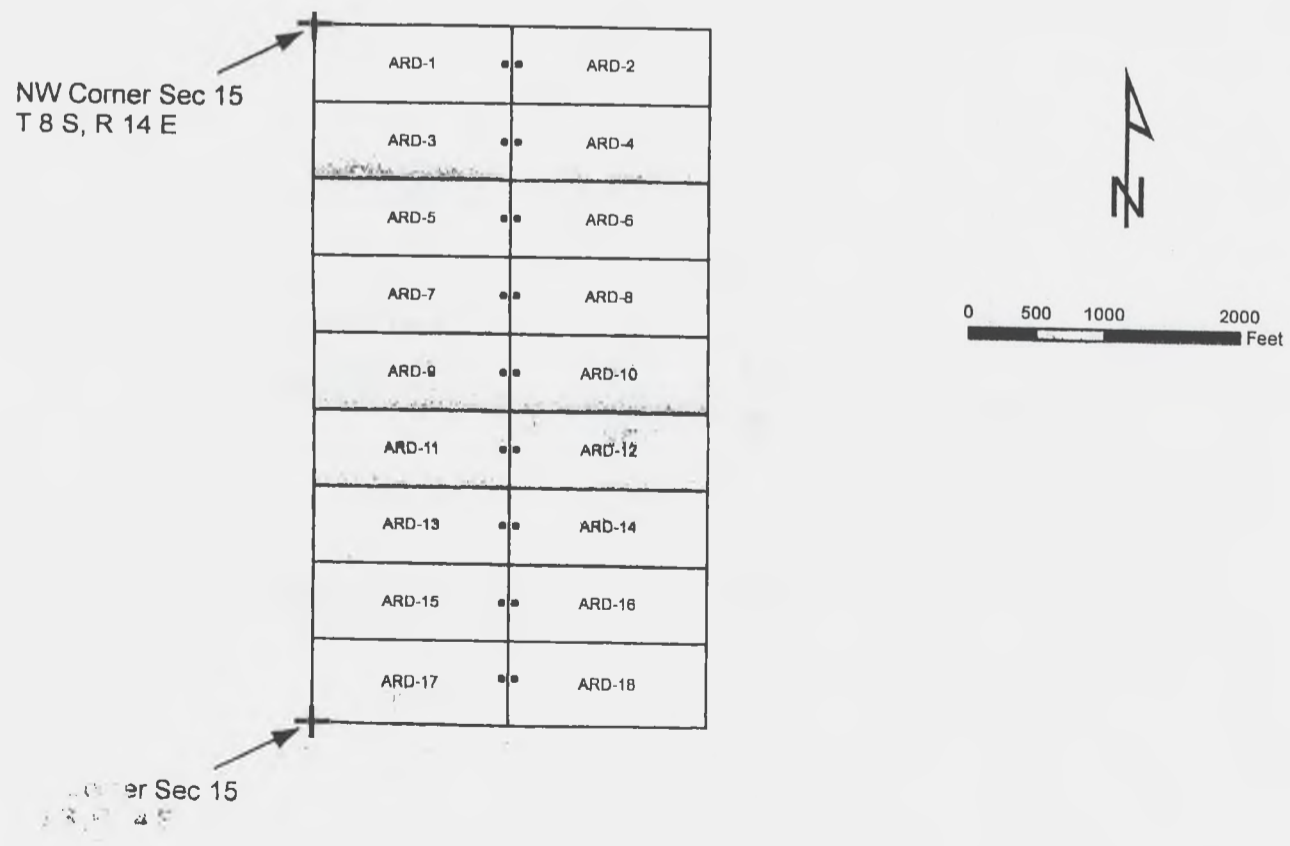

**LOCATION NOTICE FOR LODE MINING CLAIM**

*CORRECTED*

RECEIVED  
BLM PHOENIX OFFICE  
Date 2014 OCT 24 P 2:48  
Stamp  
PHOENIX, ARIZONA

NOTICE IS HEREBY GIVEN that the ARD-16  
\_\_\_\_\_ lode mining claim has been located by AVEN  
Associates LLC whose current mailing address is 7400 N. Oracle Road #131,  
Tucson, Arizona 85704. The general course of this claim is  
E-W and it is situated in Pinal County, Arizona.

This claim is 1500 feet in length and 600 feet in width. This claim runs from the location monument on which this  
location notice is posted approximately 1450 feet in a E direction to the E end center and  
50 feet in a W direction to the W end center. This claim is marked by four monuments,  
one at each corner. The location monument on which this notice is posted is situated within Section 15,  
Township 8 S, Range 14 E, Gila and Salt River Prime Meridian, Arizona and this claim encompasses portions of the  
following quarter section(s), section(s), Township(s) and Range(s)

SW 1/4 Sec. 15, T. 8 S., R. 14 E.

The locality of this claim with reference to some natural object or permanent monument and additional information (if any)  
concerning its locality are as follows: This Location is approximately 1500 feet  
east and 4340 feet south of the NW cor. Sec. 15,  
T. 8 S., R. 14 E.

DATED AND POSTED on the ground this 25<sup>TH</sup> day of SEPT, 2014

LOCATOR (s) L. Clark Connell

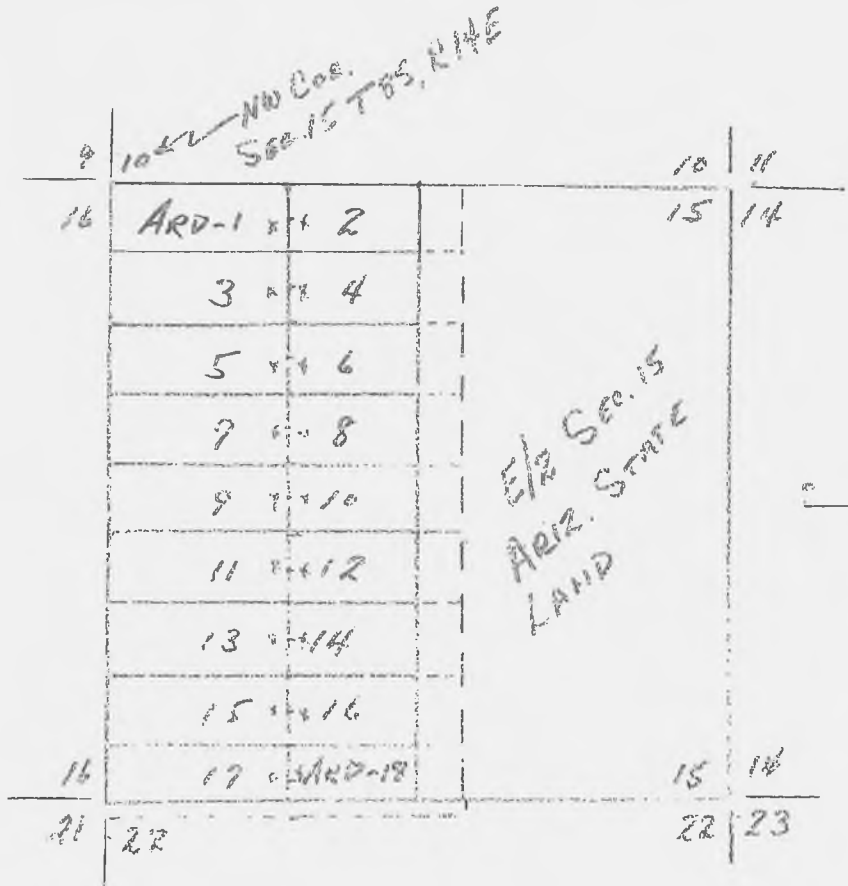

AMC 429588

RECEIVED  
BLM PHOENIX OFFICE  
Date 2014 OCT 24 P 3:26  
Stamp  
PHOENIX, ARIZONA

**LOCATION NOTICE FOR LODE MINING CLAIM**

NOTICE IS HEREBY GIVEN that the ARD-16  
\_\_\_\_\_ lode mining claim has been located by AVEN  
Associates LLC whose current mailing address is 7400 N. Oracle Road #131,  
Tucson, Arizona 85704. The general course of this claim is  
E-W and it is situated in Pinal County, Arizona.

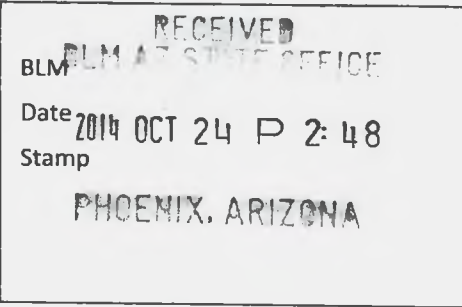

This claim is 1500 feet in length and 600 feet in width. This claim runs from the location monument on which this location notice is posted approximately 1450 feet in a E direction to the E end center and 50 feet in a W direction to the W end center. This claim is marked by four monuments, one at each corner. The location monument on which this notice is posted is situated within Section 15, Township 8 S, Range 14 E, Gila and Salt River Prime Meridian, Arizona and this claim encompasses portions of the following quarter section(s), section(s), Township(s) and Range(s)

SW 1/4 Sec. 15, T. 8 S., R. 14 E.

The locality of this claim with reference to some natural object or permanent monument and additional information (if any) concerning its locality are as follows: This Location is approximately 1500 feet east and 4340 feet south of the NW cor. Sec. 15, T. 8 S., R. 14 E.

DATED AND POSTED on the ground this 25TH day of SEPT, 2014.

LOCATOR (s) L. Clark Connell

AMC429588

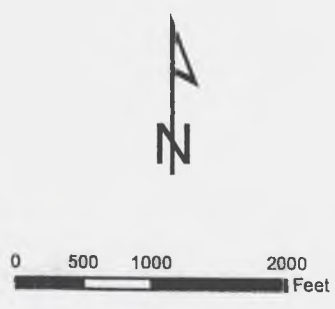
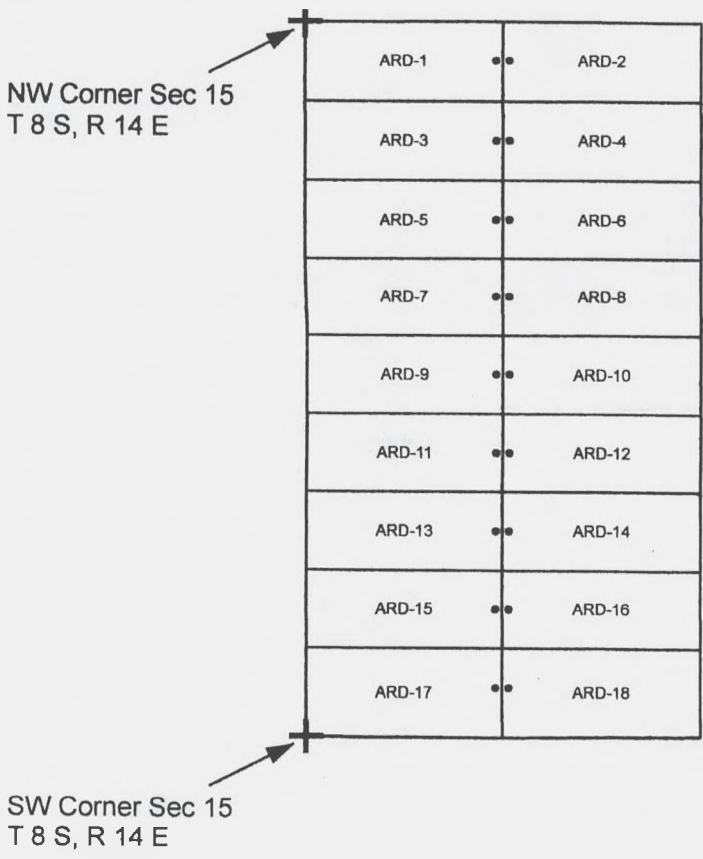

**LOCATION NOTICE FOR LODE MINING CLAIM**

*CORRECTED*

NOTICE IS HEREBY GIVEN that the ARD-17  
 \_\_\_\_\_ lode mining claim has been located by AVEN  
 Associates LLC whose current mailing address is 7400 N. Oracle Road #131,  
 Tucson, Arizona 85704. The general course of this claim is

RECEIVED  
 BLM ARIZONA OFFICE  
 BLM  
 Date 2014 OCT 24 P 2:49  
 Stamp PHOENIX, ARIZONA

E-W and it is situated in Pinal County, Arizona.  
 This claim is 1500 feet in length and 600 feet in width. This claim runs from the location monument on which this  
 location notice is posted approximately 1450 feet in a W direction to the W end center and  
50 feet in a E direction to the E end center. This claim is marked by four monuments,  
 one at each corner. The location monument on which this notice is posted is situated within Section 15,  
 Township 8 S, Range 14 E, Gila and Salt River Prime Meridian, Arizona and this claim encompasses portions of the  
 following quarter section(s), section(s), Township(s) and Range(s)

SW 1/4 Sec. 15, T. 8 S., R. 14 E.

The locality of this claim with reference to some natural object or permanent monument and additional information (if any)  
 concerning its locality are as follows: This location is approximately 1400 feet  
east and 4930 feet south of the NW cor. Sec. 15,  
T. 8 S., R. 14 E.

DATED AND POSTED on the ground this 25<sup>TH</sup> day of Sept, 2014

LOCATOR (s) L Clark Bunnell

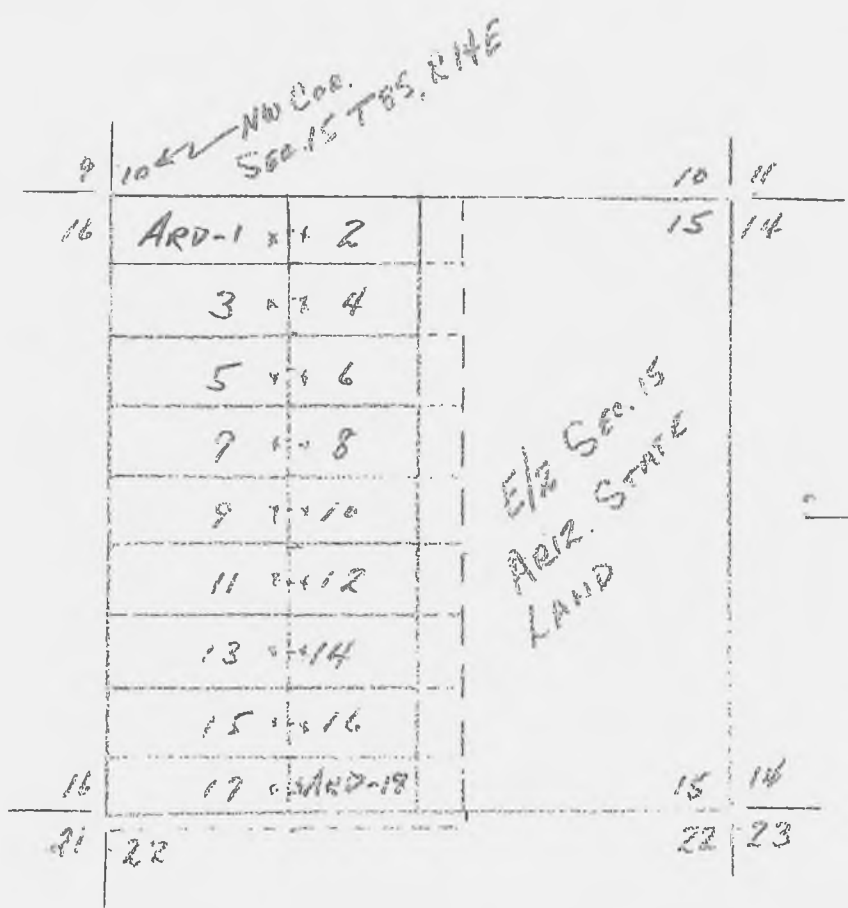

AMC42958

RECEIVED  
 BLM ARIZONA OFFICE  
 2015 MAY -4 P 3:26  
 PHOENIX, ARIZONA

**LOCATION NOTICE FOR LODE MINING CLAIM**

NOTICE IS HEREBY GIVEN that the ARD-17  
\_\_\_\_\_ lode mining claim has been located by AVEN  
Associates LLC whose current mailing address is 7400 N. Oracle Road #131,  
Tucson, Arizona 85704. The general course of this claim is  
E-W and it is situated in Pinal County, Arizona.

RECEIVED  
BLM AZ STATE OFFICE  
BLM  
Date 2014 OCT 24 P 2:49  
Stamp PHOENIX, ARIZONA

This claim is 1500 feet in length and 600 feet in width. This claim runs from the location monument on which this location notice is posted approximately 1450 feet in a W direction to the W end center and 50 feet in a E direction to the E end center. This claim is marked by four monuments, one at each corner. The location monument on which this notice is posted is situated within Section 15, Township 8 S, Range 14 E, Gila and Salt River Prime Meridian, Arizona and this claim encompasses portions of the following quarter section(s), section(s), Township(s) and Range(s)  
SW 1/4 Sec. 15, T. 8 S., R. 14 E.

The locality of this claim with reference to some natural object or permanent monument and additional information (if any) concerning its locality are as follows: This Location is approximately 1400 feet east and 4930 feet south of the NW cor. Sec. 15, T. 8 S., R. 14 E.

DATED AND POSTED on the ground this 25<sup>TH</sup> day of Sept, 2014.

LOCATOR (s) L Clark Bunnell

AMC429589

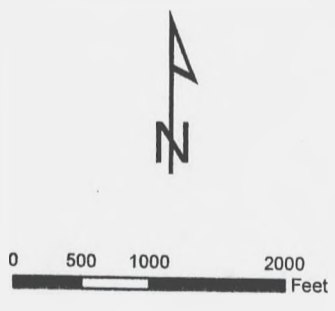
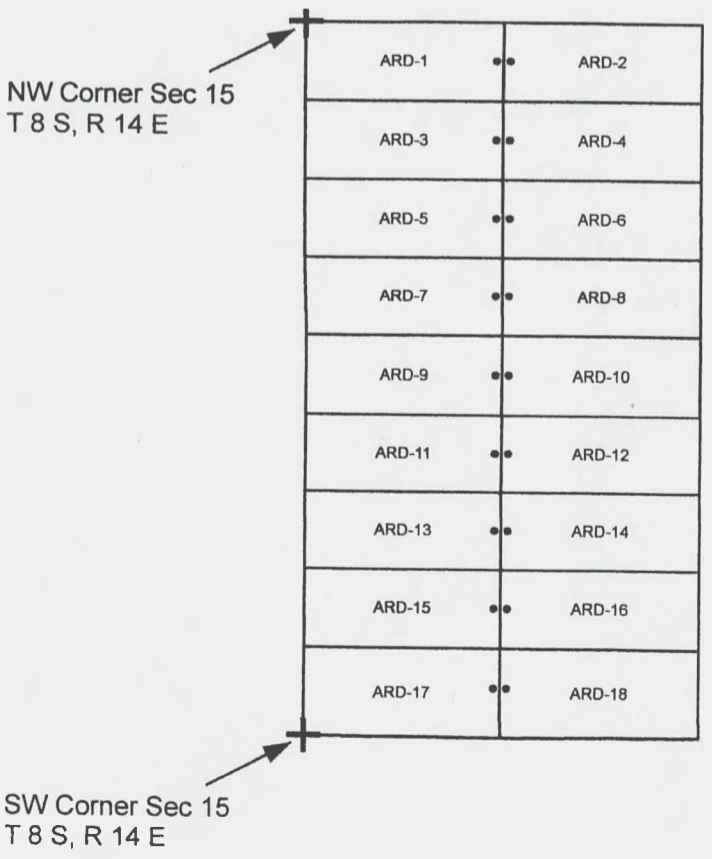

**LOCATION NOTICE FOR LODE MINING CLAIM**

*CORRECTED*

NOTICE IS HEREBY GIVEN that the ARD-18  
 \_\_\_\_\_ lode mining claim has been located by AVEN  
 Associates LLC whose current mailing address is 7400 N. Oracle Road #131,  
 Tucson, Arizona 85704. The general course of this claim is  
E-W and it is situated in Pinal County, Arizona.

RECEIVED  
 BLM OFFICE  
 Date 2014 OCT 24 P 2:49  
 Stamp  
 PHOENIX, ARIZONA

This claim is 1500 feet in length and 600 feet in width. This claim runs from the location monument on which this location notice is posted approximately 1450 feet in a E direction to the E end center and 50 feet in a W direction to the W end center. This claim is marked by four monuments, one at each corner. The location monument on which this notice is posted is situated within Section 15, Township 8 S, Range 14 E, Gila and Salt River Prime Meridian, Arizona and this claim encompasses portions of the following quarter section(s), section(s), Township(s) and Range(s)

SW 1/4 Sec. 15, T. 8 S., R. 14 E.

The locality of this claim with reference to some natural object or permanent monument and additional information (if any) concerning its locality are as follows: This location is approximately 1500 feet east and 4930 feet south of the NW cor. Sec. 15, T. 8 S., R. 14 E.

DATED AND POSTED on the ground this 25<sup>TH</sup> day of SEPT, 2014.

LOCATOR (s) L. Bert. Gould

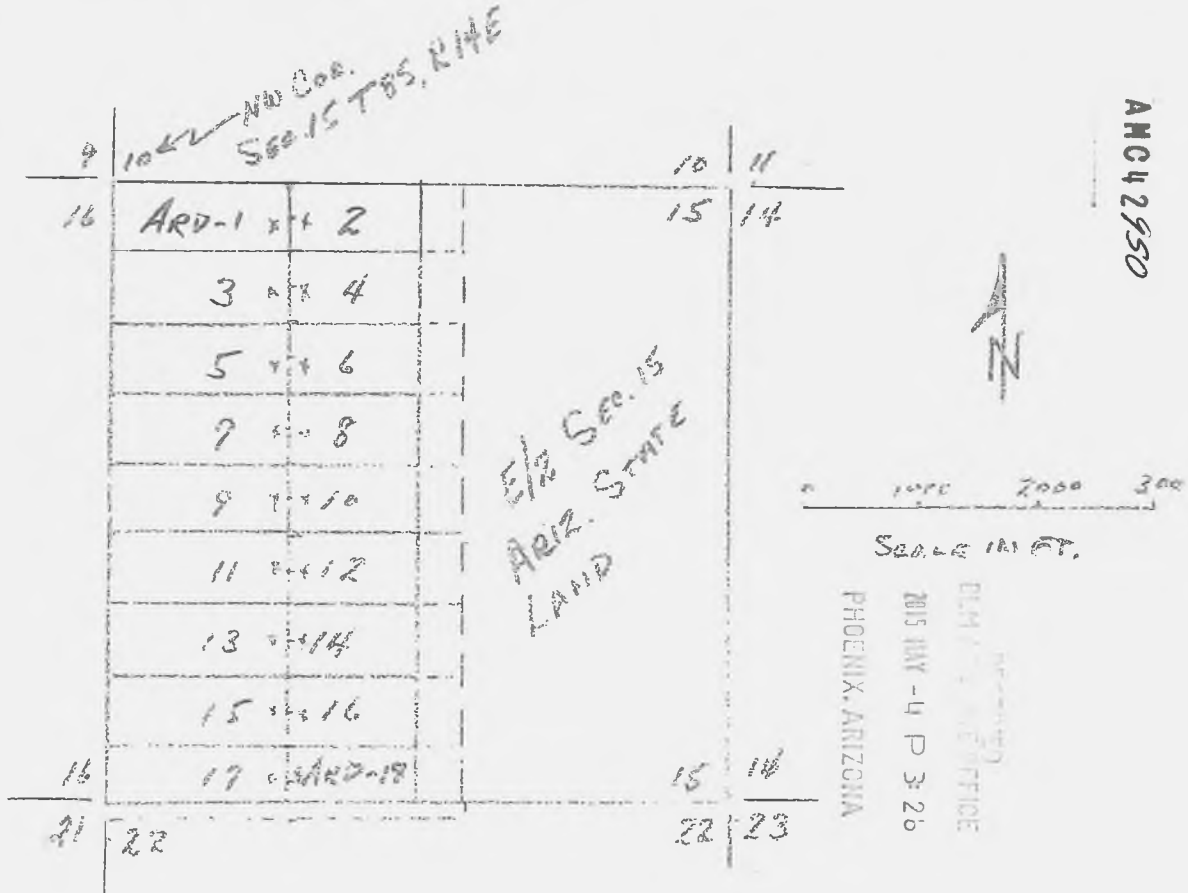



**LOCATION NOTICE FOR LODE MINING CLAIM**

NOTICE IS HEREBY GIVEN that the ARD-18  
\_\_\_\_\_ lode mining claim has been located by AVEN  
Associates LLC whose current mailing address is 7400 N. Oracle Road #131,  
Tucson, Arizona 85704. The general course of this claim is  
E-W and it is situated in Pinal County, Arizona.

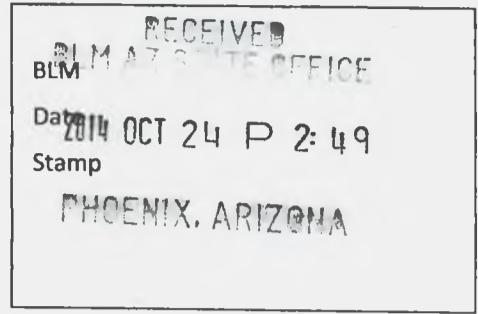

This claim is 1500 feet in length and 600 feet in width. This claim runs from the location monument on which this location notice is posted approximately 1450 feet in a E direction to the E end center and 50 feet in a W direction to the W end center. This claim is marked by four monuments, one at each corner. The location monument on which this notice is posted is situated within Section 15, Township 8 S, Range 14 E, Gila and Salt River Prime Meridian, Arizona and this claim encompasses portions of the following quarter section(s), section(s), Township(s) and Range(s)  
SW 1/4 Sec. 15, T. 8 S., R. 14 E.

The locality of this claim with reference to some natural object or permanent monument and additional information (if any) concerning its locality are as follows: This Location is approximately 1500 feet east and 4930 feet south of the NW cor. Sec. 15, T. 8 S., R. 14 E.

DATED AND POSTED on the ground this 25<sup>TH</sup> day of SEPT, 2014.

LOCATOR (s) L. Carl Conrad

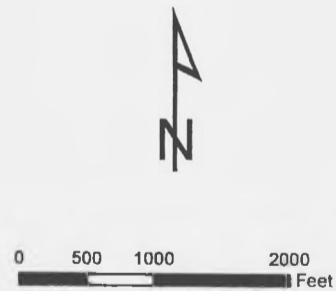
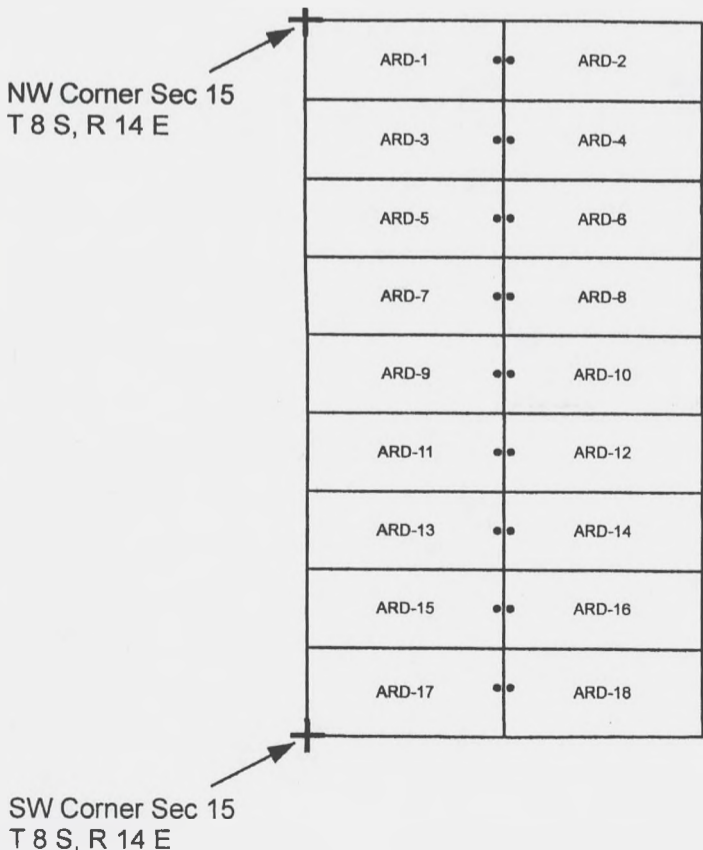

AMC429590

DEPARTMENT OF INTERIOR  
BUREAU OF LAND MANAGEMENT

Input Parameters for Geographic Report with Land

System Id = CR

Admin State = AZ

Geo State =

Casetype Begins With

Case Disp Txt = AUTHORIZED, CANCELLED, EXPIRED, PENDING, REJECTED, RELINQUISHED, WITHDRAWN

Mer Twp Rng =

Section =

Mtrs = 14 0080S 0140E 015, 14 0080S 0140E 999

Commodity =

Commodity Txt =

Pending Org =

Pend Org Decode =

Total Rows Returned: 3

RUN TIME: 01:40 PM

UNITED STATES DEPARTMENT OF INTERIOR  
BUREAU OF LAND MANAGEMENT  
GEOGRAPHIC REPORT WITH LAND  
Sorted by Serial Number

RUN DATE: 11/03/2014  
Page 1 of 1

Adm State: AZ

Serial Number: AZA 000889  
Total Case Acres: 16.370

<u>Casetype</u>	<u>Case Disp</u>				<u>Sect</u>	<u>Sur Typ</u>	<u>Sur Num</u>	<u>Suff</u>	<u>Subdivision</u>	<u>Act Pend</u>
288100	AUTHORIZED	14	0080S	0140E	015	MNR		1	E2E2W2;	

Serial Number: AZA 008778  
Total Case Acres: 457.280

<u>Casetype</u>	<u>Case Disp</u>				<u>Sect</u>	<u>Sur Typ</u>	<u>Sur Num</u>	<u>Suff</u>	<u>Subdivision</u>	<u>Act Pend</u>
285002	AUTHORIZED	14	0080S	0140E	015	ALIQ			W2;	

Serial Number: AZA 021397  
Total Case Acres: 18.180

<u>Casetype</u>	<u>Case Disp</u>				<u>Sect</u>	<u>Sur Typ</u>	<u>Sur Num</u>	<u>Suff</u>	<u>Subdivision</u>	<u>Act Pend</u>
282201	AUTHORIZED	14	0080S	0140E	015	ALIQ			W2;	

# TOWNSHIP 8 SOUTH RANGE 14 EAST OF THE GILA AND SALT RIVER MERIDIAN, ARIZONA

PINAL COUNTY  
TUCSON FIELD OFFICE

STATUS OF PUBLIC DOMAIN  
LAND AND MINERAL TITLES

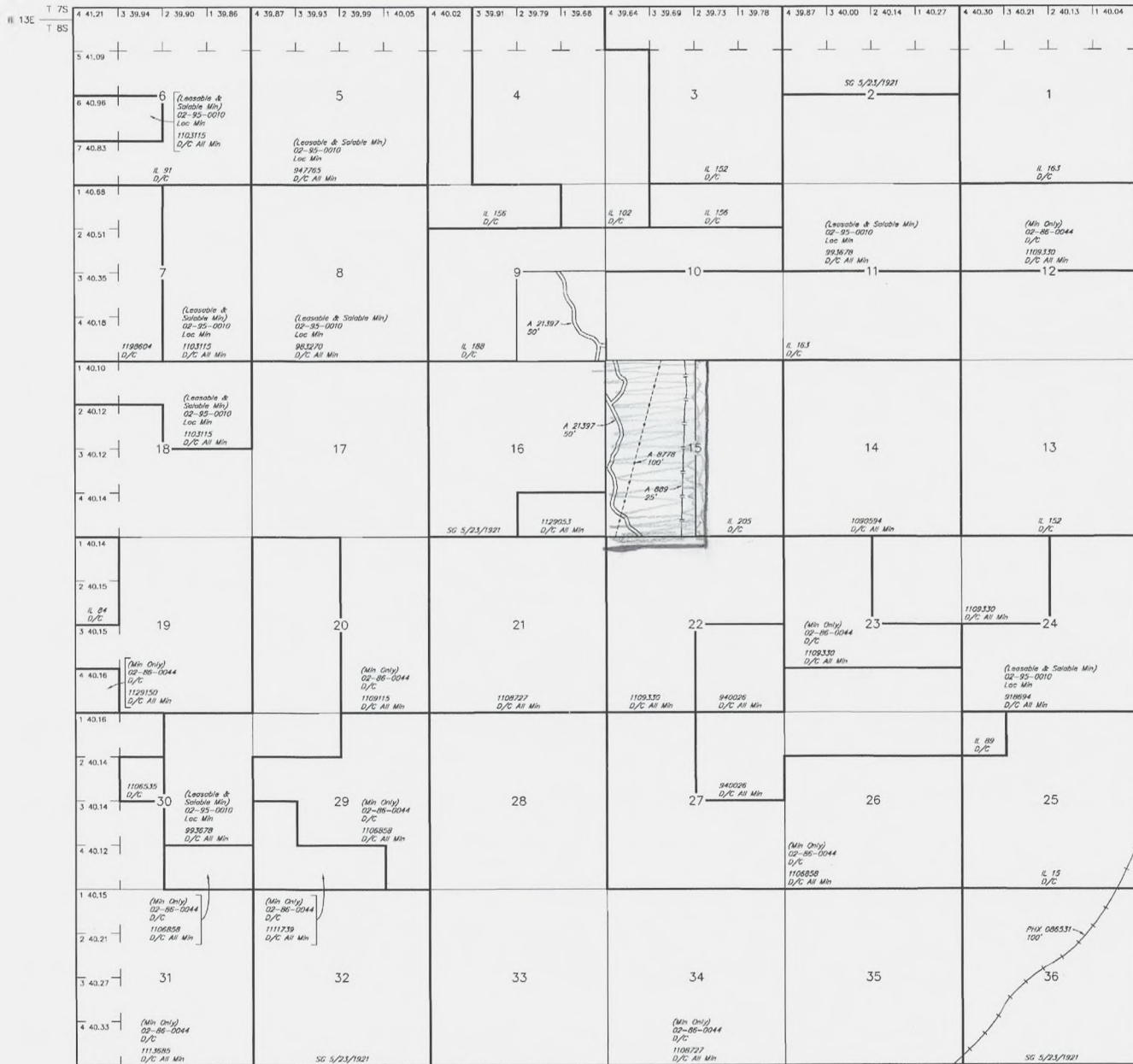

INDEX TO SEGREGATED TRACTS				
REBURY	ORIGINAL SURVEY			
	TRACT NO	T	R	SUBDIVISION

FOR ORDERS AFFECTING DISPOSAL OR USE OF UNIDENTIFIED LANDS WITHDRAWN FOR CLASSIFICATION, MINERALS, WATER AND/OR OTHER PUBLIC PURPOSES, REFER TO INDEX OF MISCELLANEOUS DOCUMENTS.

PHX 082800 P/W Road  
Sec 17: N1/4NE1/4SE1/4, SE1/4NE1/4, S1/2NE1/4SE1/4NE1/4

Lat 32°41'06"N  
Long 110°50'23"W

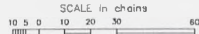

**WARNING STATEMENT**  
This plat is the Bureau's Record of Title, and should be used only as a graphic display of the townships survey data. Resurveys herein do not reflect title changes which may have been affected by lateral movements of rivers or other bodies of water. Refer to the indicated surveys for official survey information.

CURRENT TO	NW	GSR Mer
6-23-2011	ACAD	T 8 S
		R 14 E

FIRST CLASS

US. Bureau of Land Management  
attn: Ryan  
One North Central Ave.  
Phoenix, Az 85004

2015 MAY -4 P 3:25  
PHOENIX, ARIZONA

AVEN Associates LLC  
4400 N. Oracle Rd #131  
Tucson, Az 85704

CORRECTED  
LOCATION  
NUMBERS

U.S. POSTAGE PAID TUCSON AZ 85704 APR 30, 15 AMOUNT \$1.82 00112837-08



UNITED STATES POSTAL SERVICE



85004

PRESS FIRMLY TO SEAL

PRESS FIRMLY TO SEAL

PRIORITY MAIL  
POSTAGE REQUIRED

# PRIORITY MAIL

- DATE OF DELIVERY
- USPS TRACKING™ I
- INSURANCE INCLU
- PICKUP AVAILABLE

\* Domestic only

WHEN USED INTERNATIONALLY  
A CUSTOMS DECLARATION  
LABEL MAY BE REQUIRED.

FROM:

	<b>Click-N-Ship®</b> <small>usps.com</small> 9405 5036 9930 0403 0436 96 0050 5000 0008 5004 <b>US POSTAGE</b> <small>Flat Rate Env</small>	
	<b>P</b>	
Commercial Base Pricing Mailed from 85704 06250000000313 10/23/14		
<b>PRIORITY MAIL 2-DAY™</b> Expected Delivery Date: 10/25/2014 <b>0021</b>		
<b>C041</b>		
SHIP TO: U.S. BUREAU OF LAND MANAGEMENT 1 N CENTRAL AVE STE 800 PHOENIX AZ 85004-4427		
<b>USPS TRACKING #</b> 		
<b>9405 5036 9930 0403 0436 96</b>		
Electronic Rate Approved #038555749		



PS00001000014

EP14F July 2013  
OD: 12.5 x 9.5

VISIT US AT **USPS.COM**®  
ORDER FREE SUPPLIES ONLINE



This packaging is the property of the U.S. Postal Service® and is provided solely for use in shipping Priority Mail® shipments. Misuse may be a violation of federal law. This packaging is not for resale. EP14F © U.S. Postal Service, July 2013; All rights reserved.

14166E - ep14f/ce1 ep14f consumer waste. Please recycle.

# PRIORITY<sup>®</sup> ★ MAIL ★



## FLAT RATE ENVELOPE

ONE RATE ★ ANY WEIGHT\*



PS00001000014

EP14F July 2013  
OD: 12.5 x 9.5

PHOENIX, ARIZONA  
2014 OCT 24 P 2:49  
RECEIVED  
BLM AZ STATE OFFICE



\* Domestic only. \* For International shipments, the maximum weight is 4 lbs.